

CITY OF LA PINE

SIDEWALK AND MULTI-USE PATH IMPROVEMENT PROJECT

LA PINE, DESCHUTES COUNTY, OREGON

APRIL 2014

LEGEND

	JTA SURVEY CONTROL POINT/BENCHMARK SEE NOTES
	AC SURFACE
	CLEAN OUT
	CONCRETE SURFACE
	DELINEATOR POST (CARSONITE POST WHITE)
	TRUNCATED DOMES
	EDGE GRAVEL
	EDGE PAVEMENT
	FLAG POLE
	FIRE HYDRANT
	IRRIGATION VALVE
	LANDSCAPE AREA
	POWER TRANSFORMER PAD MOUNTED (MID STATE COOP)
	ROOF DOWNSPOUT (CHAIN)
	SATELLITE TV DISH
	SEWER MANHOLE
	SIGN TYPE AS NOTED
	TELEVISION MANHOLE
	TELEPHONE CLOSURE
	TRAFFIC MARKING
	UNKNOWN MANHOLE
	WATER ANTI-BACKFLOW VALVE
	WATER METER
	WATER STANDPIPE (TYPE UNKNOWN)
	WATER VALVE
	TREE DECIDUOUS, SIZE AS NOTED
	TREE JUNIPER, SIZE AS NOTED
	TREE PINE, SIZE AS NOTED
	OVERHEAD POWER AND TV LINE
	RIGHT OF WAY LINE
	SANITARY SEWER LINE (CITY OF LA PINE)
	UNDERGROUND FIBER / TV LINE (CENTURYLINK)
	UNDERGROUND NATURAL GAS LINE
	UNDERGROUND TELEPHONE LINE (CENTURYLINK)
	WATER LINE (CITY OF LA PINE)
	UTILITY TRENCHING

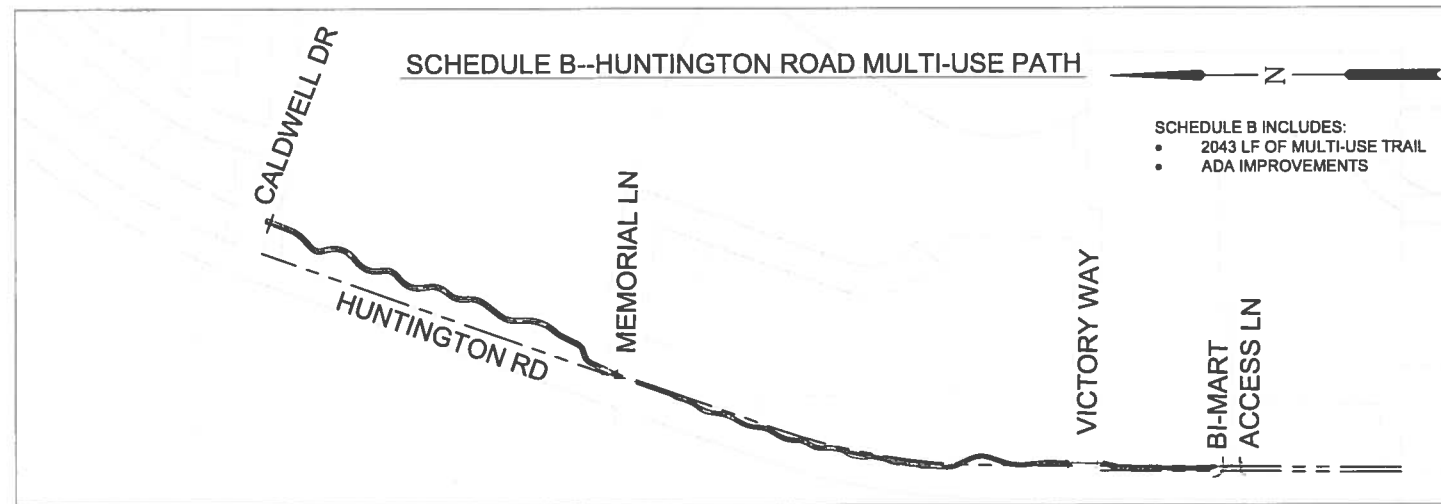
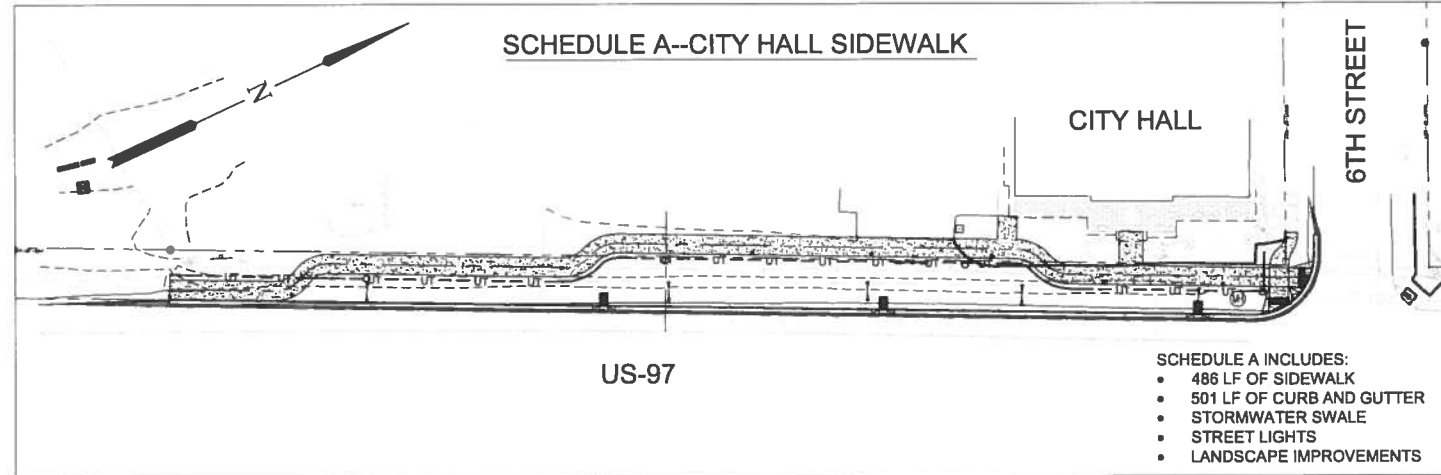

APPROVALS

DESCHUTES COUNTY ENGINEER:

NOTE: SIGNATURE DOES NOT GRANT APPROVAL TO COMMENCE CONSTRUCTION

SHEET INDEX

NO.	SCHEDULE	DWG. NO	TITLE
1	A	C0.0	COVER SHEET
2	A	C1.0	CITY HALL SIDEWALK PLAN AND PROFILE
3	A	C1.1	CITY HALL SIDEWALK CURB PROFILE RAMP DETAILS
4	A	C1.2	CITY HALL SIDEWALK GENERAL CONSTRUCTION DETAILS
5	A	L1.0	PLANTING PLAN
6	A	L1.1	PLANTING DETAILS
7	A	L2.0	IRRIGATION PLAN
8	A	L2.1	IRRIGATION DETAILS
9	B	C2.0	HUNTINGTON PATH PLAN AND PROFILE STA 10+00 TO STA 15+50
10	B	C2.1	HUNTINGTON PATH PLAN AND PROFILE STA 15+50 TO STA 21+00
11	B	C2.2	HUNTINGTON PATH PLAN AND PROFILE STA 21+00 TO STA 26+50
12	B	C2.3	HUNTINGTON PATH PLAN AND PROFILE STA 26+50 TO STA 31+39
13	B	C2.4	HUNTINGTON PATH GENERAL CONSTRUCTION DETAILS

GENERAL NOTES:

- NO CONSTRUCTION SHALL BE STARTED WITHOUT A NOTICE TO PROCEED BY THE CITY PUBLIC WORKS DEPARTMENT. THE CITY PUBLIC WORKS DEPARTMENT AND THE DESIGN ENGINEER SHALL BE NOTIFIED AT LEAST 24 HOURS PRIOR TO THE START OF CONSTRUCTION. ANY CONSTRUCTION WORK DONE PRIOR TO NOTICE TO PROCEED BEING ISSUED OR WITHOUT INSPECTION WILL BE REJECTED.
- CONTRACTOR SHALL VERIFY ALL CONDITIONS ON THE JOB SITE INCLUDING BUT NOT LIMITED TO, ALL DIMENSIONS, GRADES, ELEVATIONS, EXTENT AND COMPATIBILITY TO THE EXISTING SITE CONDITIONS, AND WITH THE WORK DESCRIBED ON THE ENGINEER'S DRAWINGS. ANY DISCREPANCIES OR UNEXPECTED CONDITIONS THAT AFFECT OR CHANGE THE WORK DESCRIBED IN THE CONTRACT DOCUMENTS SHALL BE BROUGHT TO THE ENGINEER'S ATTENTION IMMEDIATELY. CONTRACTOR SHALL NOT PROCEED WITH ANY OF THE WORK IN THE AREA OF DISCREPANCIES UNTIL ALL SUCH DISCREPANCIES ARE RESOLVED. IF THE CONTRACTOR CHOOSES TO DO SO, THEN IT IS UNDERSTOOD THAT THE CONTRACTOR IS CHOOSING TO PROCEED AT THE CONTRACTOR'S OWN RISK AND SHALL INCUR ALL COSTS, IF ANY TO RESOLVE THE ISSUES TO THE SATISFACTION OF THE ENGINEER.
- A CITY INSPECTOR ACTING ON BEHALF OF THE CITY MAY REQUIRE REVISIONS IN PLANS TO SOLVE UNFORESEEN PROBLEMS THAT MAY ARISE IN THE FIELD.
- ALL CONSTRUCTION WORK AND INSTALLATIONS SHALL CONFORM TO THE 2008 OREGON STANDARD SPECIFICATIONS FOR CONSTRUCTION, AND ALL WORK SHALL BE SUBJECT TO THE APPROVAL OF THE CITY.
- IT SHALL BE THE RESPONSIBILITY OF THE CONTRACTOR TO CONTACT "UNDERGROUND LOCATE SERVICE" AT 1-800-332-2344 AT LEAST 48 BUSINESS-DAY HOURS PRIOR TO THE START OF CONSTRUCTION FOR THE LOCATION OF POWER, GAS, CABLE TV AND TELEPHONE UNDERGROUND FACILITIES. THE CONTRACTOR WILL ALSO BE RESPONSIBLE FOR CONTACTING THE APPROPRIATE PUBLIC AGENCY FOR THE LOCATION OF UNDERGROUND FACILITIES.
- ALL UTILITIES SHOWN ARE ACCURATE TO THE EXTENT OF AVAILABLE RECORDS AND KNOWLEDGE. NO POTHOLES TO VERIFY LOCATIONS AND ELEVATIONS WAS AUTHORIZED BY THE OWNER. THE CONTRACTOR HAS THE TOTAL RESPONSIBILITY TO VERIFY THE LOCATION OF EXISTING UNDERGROUND UTILITIES AND TO NOTIFY THE UTILITY COMPANIES WHEN WORKING IN THEIR PROXIMITY. CONTRACTOR TO VERIFY LOCATION OF EXISTING UTILITIES PRIOR TO CONSTRUCTION. OREGON LAW REQUIRES YOU TO FOLLOW RULES ADOPTED BY THE OREGON UTILITY NOTIFICATION CENTER. THOSE RULES ARE SET FORTH IN OAR 952-001-0010 THROUGH 952-001-0090. YOU MAY OBTAIN COPIES OF THE RULES BY CALLING THE CENTER. THE TELEPHONE NUMBER FOR THE OREGON UTILITY NOTIFICATION CENTER IS (503)232-2987.
- ALL FINAL CUT SLOPES SHALL NOT EXCEED A GRADE OF 2 HORIZONTAL TO 1 VERTICAL UNLESS OTHERWISE APPROVED. FILL SLOPES SHALL NOT EXCEED A GRADE OF 2 HORIZONTAL TO 1 VERTICAL UNLESS OTHERWISE APPROVED BY THE ENGINEER.
- ALL UNSUITABLE SOILS MATERIALS, RUBBISH AND DEBRIS RESULTING FROM GRADING OPERATIONS SHALL BE REMOVED FROM THE JOB SITE AND DISPOSED OF PROPERLY.
- THE CONTRACTOR SHALL EMPLOY ALL LABOR, EQUIPMENT, AND METHODS REQUIRED TO PREVENT DUST IN AMOUNTS DAMAGING TO PROPERTY, CULTIVATED VEGETATION AND DOMESTIC ANIMALS OR CAUSING A NUISANCE TO PERSONS OCCUPYING BUILDINGS IN THE VICINITY OF THE JOB SITE. THE CONTRACTOR SHALL BE RESPONSIBLE FOR ANY DAMAGE CAUSED BY DUST RESULTING FROM CONSTRUCTION.
- THE CONTRACTOR SHALL FOLLOW ALL APPLICABLE INDUSTRIAL SAFETY REGULATIONS. THE CITY AND DESCHUTES COUNTY AND THEIR OFFICIALS, THE ENGINEER, AND THE OWNER SHALL NOT BE RESPONSIBLE FOR ENFORCING SAFETY REGULATIONS.
- MATERIAL QUANTITIES USED, NOTED, OR PROVIDED IN A SEPARATE ITEMIZED QUANTITY TAKE-OFF ARE AN ENGINEER'S OPINION OF PROBABLE MATERIAL REQUIREMENTS, AND IS AN ESTIMATE ONLY. CONTRACTOR'S HAVE THE SOLE RESPONSIBILITY OF MAKING THEIR OWN QUANTITY TAKE-OFF AND COST ESTIMATE.
- ALL WORK SHALL BE PERFORMED BY A CITY APPROVED CONTRACTOR.

COMPLIANCE WITH ACCESSIBILITY GUIDELINES:

ALL IMPROVEMENTS SHALL COMPLY WITH APPLICABLE ACCESSIBILITY GUIDELINES.

APPLICABLE GUIDELINES FOR THIS PROJECT ARE THE UNITED STATES ACCESS BOARD PROPOSED ACCESSIBILITY GUIDELINES FOR PEDESTRIAN FACILITIES IN THE PUBLIC RIGHT OF WAY, JULY 26, 2011.

ANY CONSTRUCTION NOT IN CONFORMANCE WITH THESE PLANS AND NOT IN COMPLIANCE WITH APPLICABLE GUIDELINES MUST BE CORRECTED BY THE CONTRACTOR AT THE CONTRACTOR'S EXPENSE.

NO.	DATE	BY	APPR	REVISIONS

VERIFY SCALES
BAR IS ONE INCH ON ORIGINAL DRAWING.
IF NOT ONE INCH ON THIS SHEET, ADJUST SCALES ACCORDINGLY.



DESIGNED BY: TH3
DRAWN BY: GJR
CHECKED BY: JML
SCALE: AS SHOWN
DATE: APRIL 2014
PROJECT NO: 12454.001.01

BEND OFFICE
1020 SW EMKAY DRIVE #100
BEND, OR 97702
541.322.8962
541.382.2423 (FAX)
WWW.CENTURYWEST.COM

CITY OF LA PINE
SIDEWALK AND MULTI-USE PATH IMPROVEMENT PROJECTS

COVER SHEET

DRAWING NO.
C0.0

SHEET NO.
1 of 13

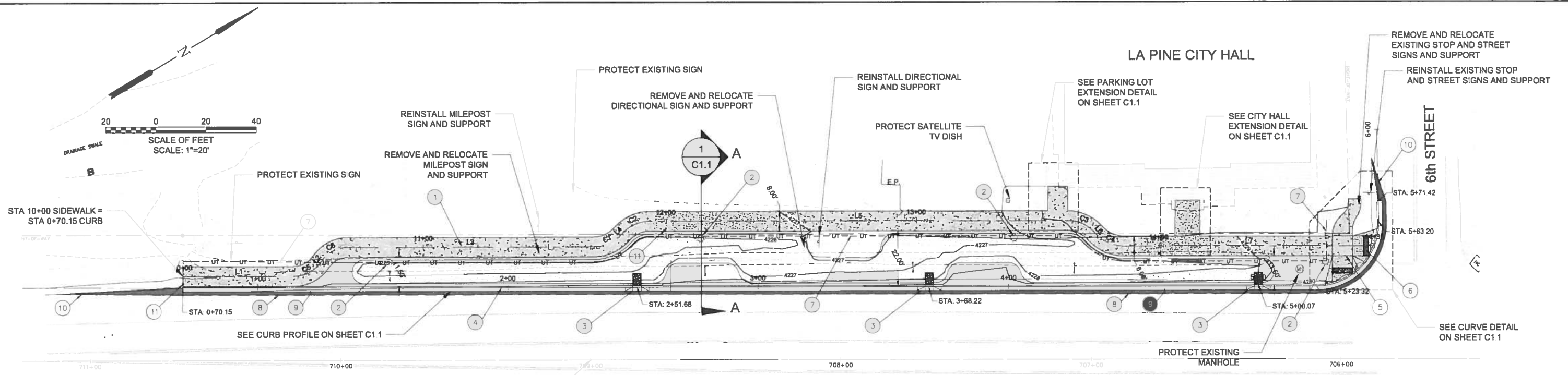

CONSTRUCTION NOTES

- 1 CONSTRUCT CONCRETE SIDEWALK PER ODOT STANDARD DRAWING RD720
- 2 CONSTRUCT LIGHT BASE PER DETAIL 5 ON SHEET C.1.2
- 3 CONSTRUCT CURB OPENING PER ODOT DETAIL DET 1750
- 4 CONSTRUCT CURB AND GUTTER PER ODOT STANDARD DRAWING RD700 (E=7", W=24")
- 5 CONSTRUCT SIDEWALK RAMP PER DETAIL 2 ON SHEET C.1.1
- 6 CONSTRUCT TRUNCATED DOME PER ODOT STANDARD DETAIL RD759
- 7 INSTALL ELECTRICAL CONDUIT PER DETAIL 1 ON SHEET C.1.2
- 8 SAWCUT EXISTING PAVEMENT PER DETAIL 3 ON SHEET C.1.2
- 9 CONSTRUCT AC PAVEMENT SECTION PER DETAIL 2 ON SHEET C.1.2
- 10 MATCH EXISTING PAVEMENT PER ODOT STANDARD DRAWING RD610
- 11 CONSTRUCT FLAG POLE MOUNT PER DETAIL 4 ON SHEET C.1.2 (TYP. OF 10)

GENERAL NOTES

- 1. CONTRACTOR TO SUBMIT A TRAFFIC CONTROL PLAN TO THE ENGINEER AND TO ODOT PRIOR TO BEGINNING WORK ON HIGHWAY 97. NO LANE CLOSURE OR STOPPAGE OF TRAFFIC WILL BE ALLOWED.
- 2. SEE SHEET L.1.0 FOR LANDSCAPE PLANS.
- 3. CONTRACTOR TO POTHOLE ALL SHOWN UTILITIES PRIOR TO EXCAVATION.
- 4. NOTIFY ENGINEER OF ANY UNFORESEEN OBSTACLES OR CONFLICTS.

CITY HALL SIDEWALK PLAN
SCALE: 1" = 20'

Sidewalk Centerline			
Number	Radius	Length	Line/Chord Direction
C1	14.77	12.12	N7° 24' 29.33"E
C2	15.00	12.04	N7° 13' 33.71"E
C3	14.53	12.08	N54° 44' 35.30"E
C4	15.00	12.23	N54° 16' 37.08"E
C6	13.00	12.32	N3° 46' 14.70"E
L1		44.24	N30° 55' 41.67"E
L2		0.82	N23° 23' 11.12"W
L3		98.44	N30° 55' 40.52"E
L4		1.10	N15° 46' 09.13"W
L5		167.04	N30° 55' 41.67"E
L6		1.05	N77° 37' 32.48"E
L7		100.51	N30° 55' 41.67"E

SURVEY CONTROL

ID NUMBER	DESCRIPTION	NORTHING	EASTING	ELEVATION
1	1" BP CONCRETE MARKER STAMPED "JTA CONTROL 1"	242541.13	3240560.06	4228.31
2	1" BP CONCRETE MARKER STAMPED "JTA CONTROL 2"	242764.41	3240696.83	4229.86

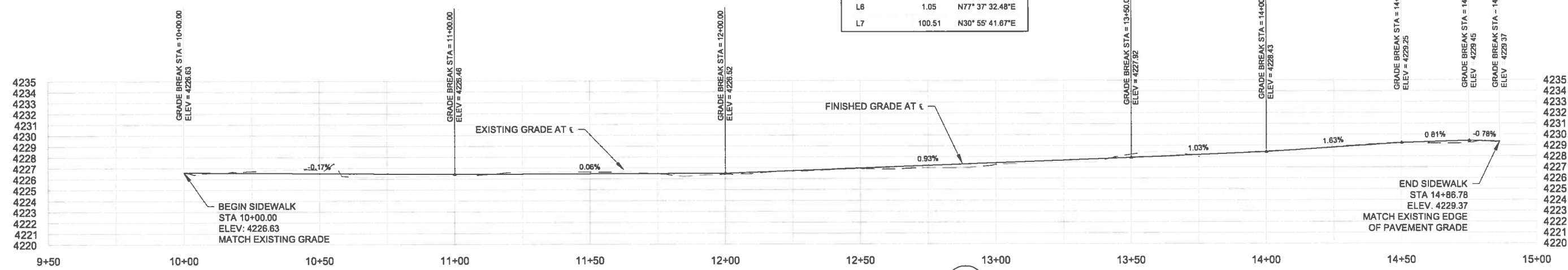

CITY HALL SIDEWALK PROFILE
SCALE: H 1" = 20', V 1" = 2'

NO	DATE	BY	APPR	REVISIONS

VERIFY SCALES
BAR IS ONE INCH ON ORIGINAL DRAWING
IF NOT ONE INCH ON THIS SHEET, ADJUST SCALES ACCORDINGLY



CENTURY WEST ENGINEERING CORPORATION

DESIGNED BY: JML
DRAWN BY: GJR
CHECKED BY: JML
SCALE: AS SHOWN

DATE: APRIL 2014
PROJECT NO: 12454 001.01

BEND OFFICE
1020 SW EMKAY DRIVE #100
BEND, OR 97702
541.322.8962
541.382.2423 (FAX)
WWW.CENTURYWEST.COM

CITY OF LA PINE IMPROVEMENT PROJECT

CITY HALL SIDEWALK PLAN AND PROFILE SCHEDULE A

DRAWING NO. **C1.0**
SHEET NO. **2 of 13**

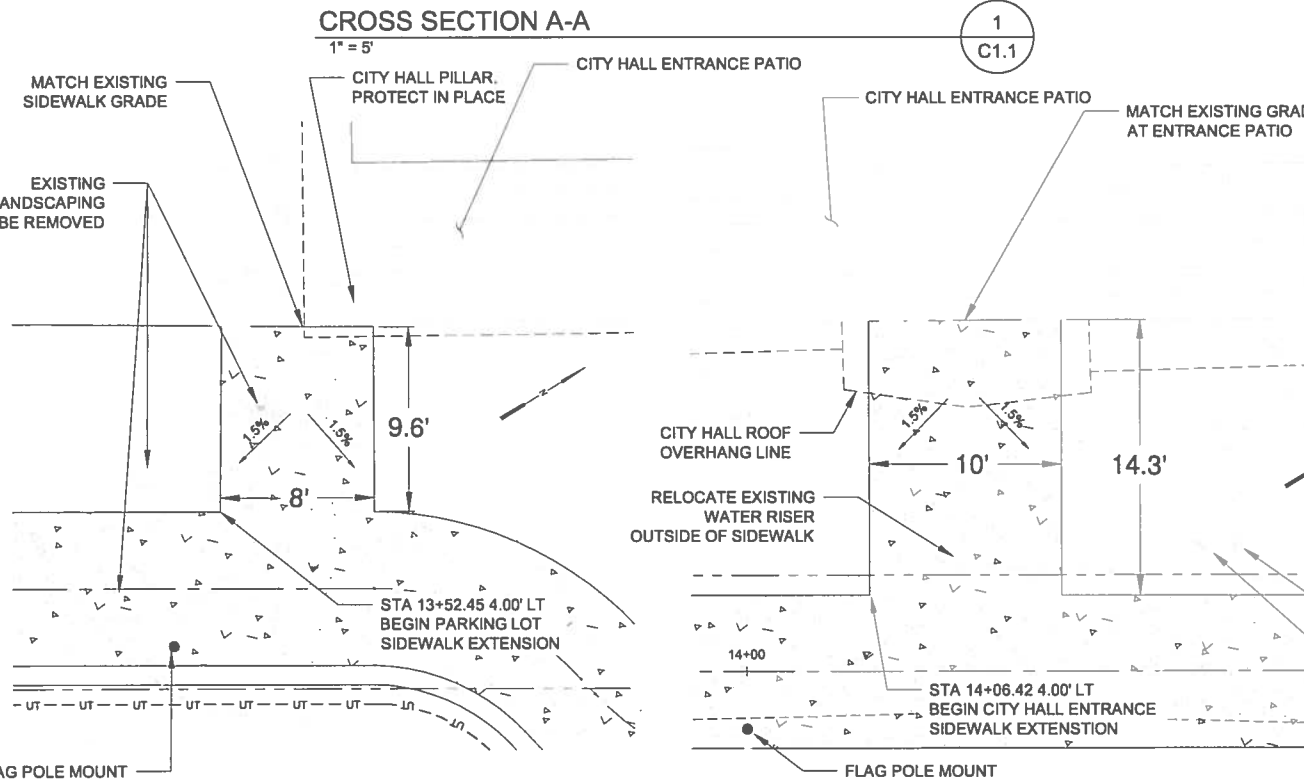
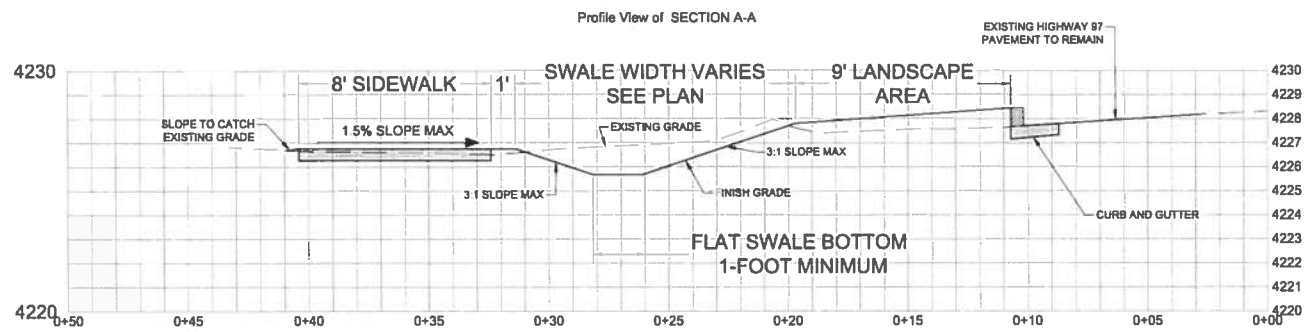

SIDEWALK EXTENSION-PARKING LOT
1" = 5"
C1.1

SIDEWALK EXTENSION-CITY HALL ENTRANCE
1" = 5"
C1.1

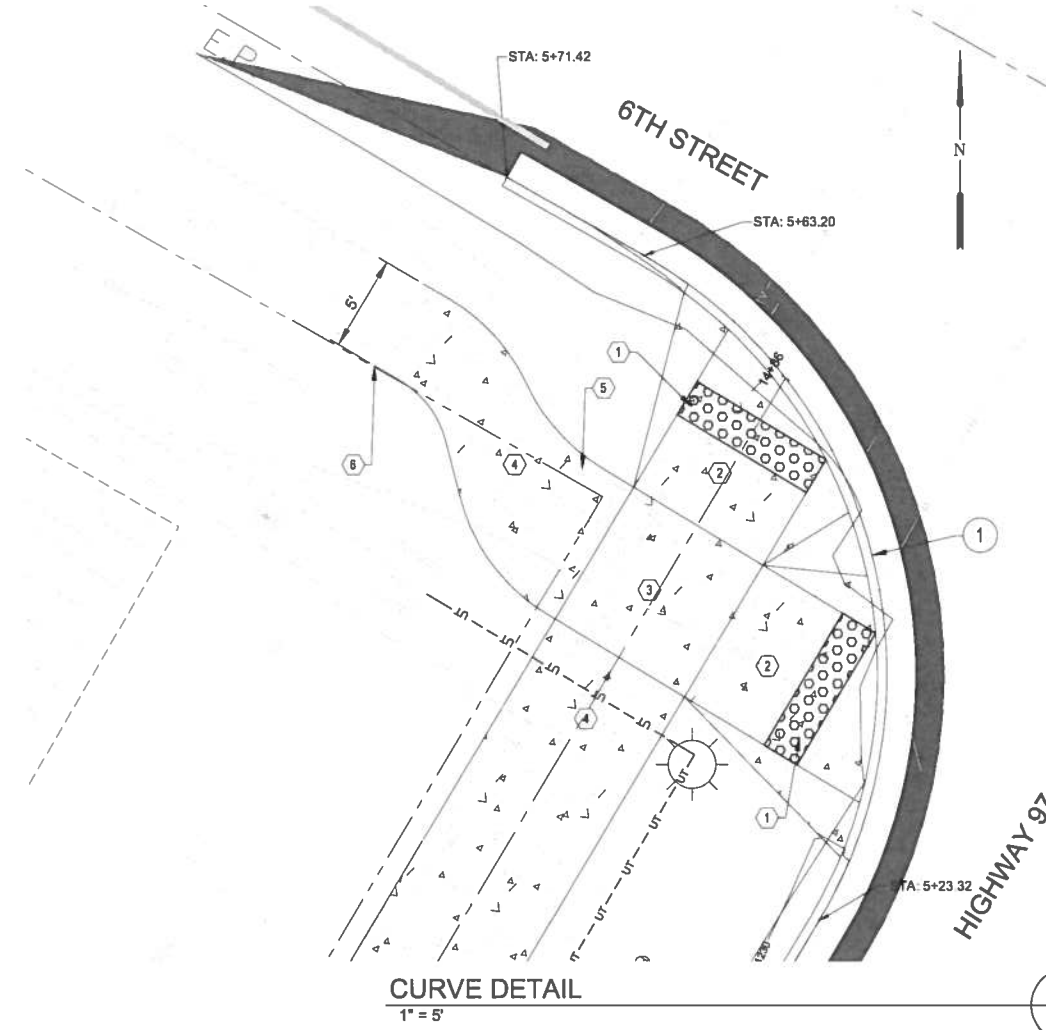

CURVE DETAIL
1" = 5"
C1.1

CURB RETURN TABLE			
DESC.	LOCATION	TP ELEV.	
PC	STA 5+63.20 CURB	4229.45'	RADIUS = 25.00' LENGTH = 39.99' Δ = 91.3842'
1/4A		4229.52'	
1/2A		4229.57'	
3/4A		4229.58'	
PT	STA 5+23.32 CURB	4229.55'	

- SIDEWALK CONSTRUCTION NOTES:**
- CONSTRUCT ADA DETECTABLE WARNING PAD PER ODOT STANDARD DRAWING RD759.
 - CONSTRUCT RAMP. 1.5% (2.0% MAX) CROSS SLOPE. RUNNING SLOPE SHALL NOT EXCEED 8.3% PER PROWAG STANDARDS.
 - CONSTRUCT REQUIRED LANDING. 1.5% (2.0% MAX) SLOPE IN EACH DIRECTION PER PROWAG STANDARDS.
 - CONSTRUCT TRANSITION PANEL PER PROWAG STANDARDS. MATCH PROPOSED AND EXISTING.
 - EXISTING FIRE HYDRANT LOCATION. HYDRANT NEEDS TO BE RESET OFF OF PROPOSED SIDEWALK (NOT IN CONTRACT). COORDINATE WITH CITY OF LA PINE PUBLIC WORKS PRIOR TO CONSTRUCTION.
 - MATCH EXISTING SIDEWALK GRADES.

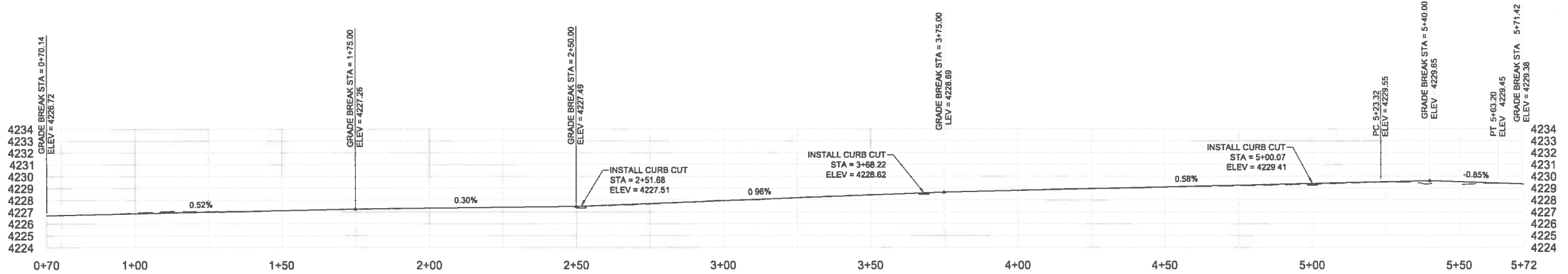

CURB PROFILE
1" = 20"
C1.1

BID DOCUMENTS

NO.	DATE	BY	APPR	REVISIONS

VERIFY SCALES
BAR IS ONE INCH ON ORIGINAL DRAWING.
IF NOT ONE INCH ON THIS SHEET, ADJUST SCALES ACCORDINGLY.

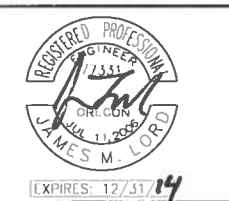

CENTURY WEST ENGINEERING CORPORATION

DESIGNED BY: JML
DRAWN BY: GJR
CHECKED BY: JML
SCALE: AS SHOWN

DATE: APRIL 2014
PROJECT NO: 12454.001.01

BEND OFFICE
1020 SW EMKAY DRIVE #100
BEND, OR 97702
541.322.8962
541.382.2423 (FAX)
WWW.CENTURYWEST.COM

CITY OF LA PINE IMPROVEMENT PROJECT

CITY HALL SIDEWALK CURB PROFILE AND RAMP DETAILS SCHEDULE A

DRAWING NO. **C1.1**
SHEET NO. **3 of 13**

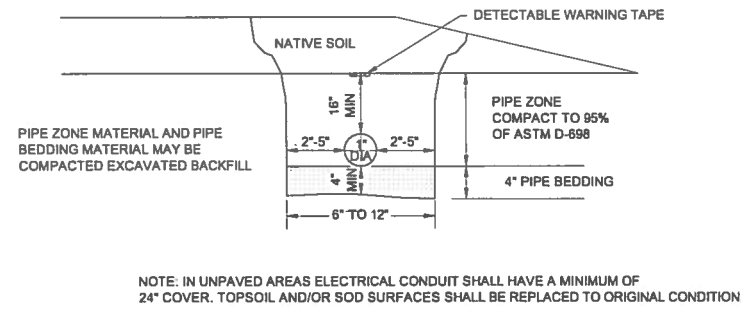

ELECTRICAL TRENCH
N.T.S. 1
C1.2

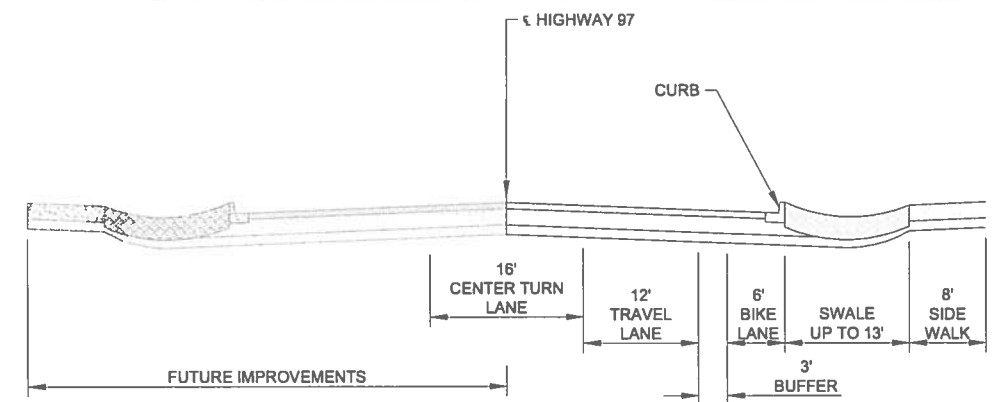

LA PINE HIGHWAY 97 CORRIDOR PLAN CROSS-SECTION
N.T.S. 2
C1.2

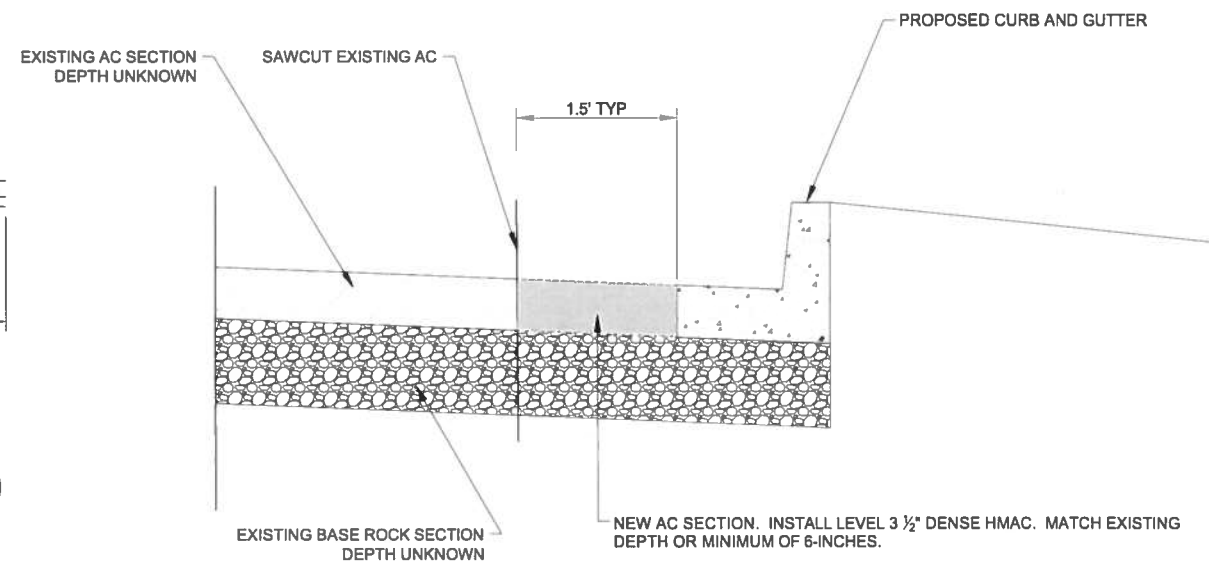

HIGHWAY 97 SAW CUT AND ASPHALT DETAIL
N.T.S. 3
C1.2

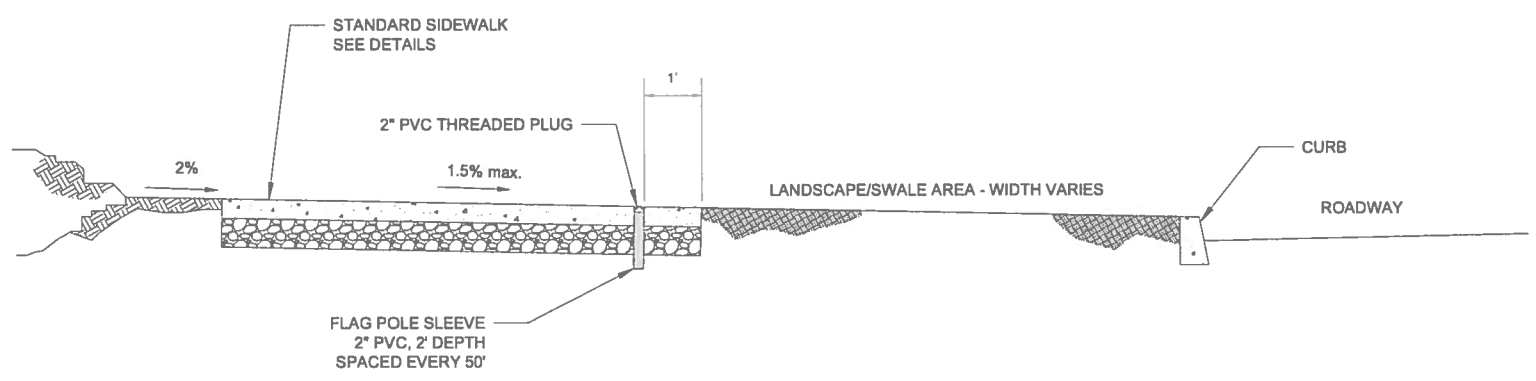

FLAG POLE MOUNT INSTALLATION
N.T.S. 4
C1.2

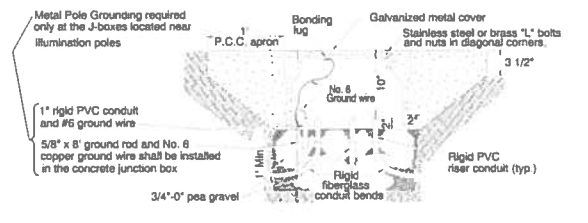

CONCRETE JUNCTION BOX INSTALLATION WITH APRON (NEAR ILLUM. POLE)
No Scale

- NOTE
1. Illumination circuit wires are not shown. See Illumination Plans.
 2. Illumination Circuits shall be applied according to Section 02520.25
 3. Polymer concrete junction box cover, if used, is not required to be bonded.
 4. Metallic conduit, if used, shall be bonded and connected to circuit ground wires.

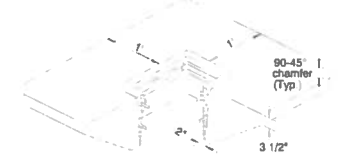

CONCRETE APRON AROUND JUNCTION BOX
(Approx. 7 ft.³ concrete in neat section)

Type	Min. Thickness	L**	W	D Min.	Edge Thickness
1	1"	17"	10"	12"	1"
2	1"	22"	12"	12"	2"
3	1"	30"	17"	12"	2"

* Excluding conduit web
** Top Dimension

JUNCTION BOX DIMENSION

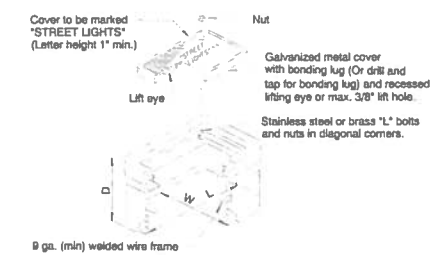

PRECAST CONCRETE ILLUMINATION JUNCTION BOX
Not to be used in travel lanes, shoulders or areas exposed to traffic.

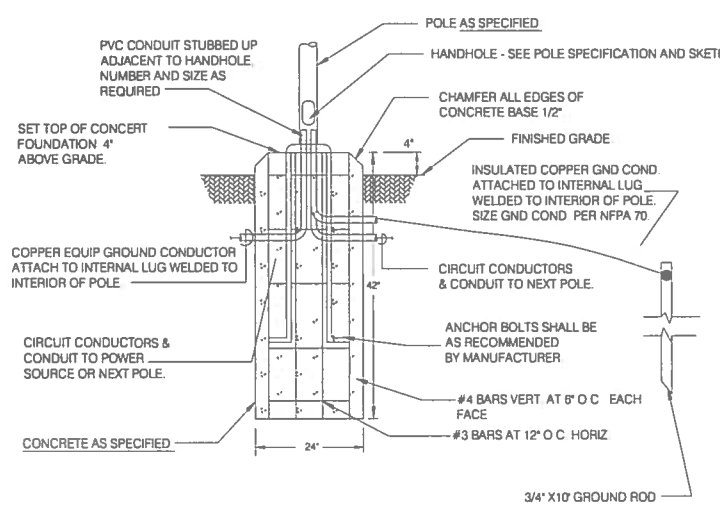

ILLUMINATION POLE BASE AND ELECTRICAL JUNCTION BOX
N.T.S. 5
C1.2

BID DOCUMENTS

NO.	DATE	BY	APPR	REVISIONS

VERIFY SCALES
BAR IS ONE INCH ON ORIGINAL DRAWING.
0" ██████████ 1"
IF NOT ONE INCH ON THIS SHEET, ADJUST SCALES ACCORDINGLY.

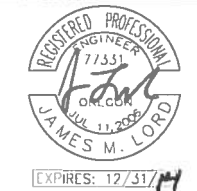

DESIGNED BY: JML
DRAWN BY: GJR
CHECKED BY: JML
SCALE: AS SHOWN

DATE: APRIL 2014
PROJECT NO: 12454 001.01

BEND OFFICE
1020 SW EMKAY DRIVE #100
BEND, OR 97702
541.322.8962
541.382.2423 (FAX)
WWW.CENTURYWEST.COM

**CITY OF LA PINE
IMPROVEMENT PROJECT**

**CITY HALL SIDEWALK GENERAL CONSTRUCTION DETAILS
SCHEDULE A**

DRAWING NO.
C1.2

SHEET NO.
4 of 13

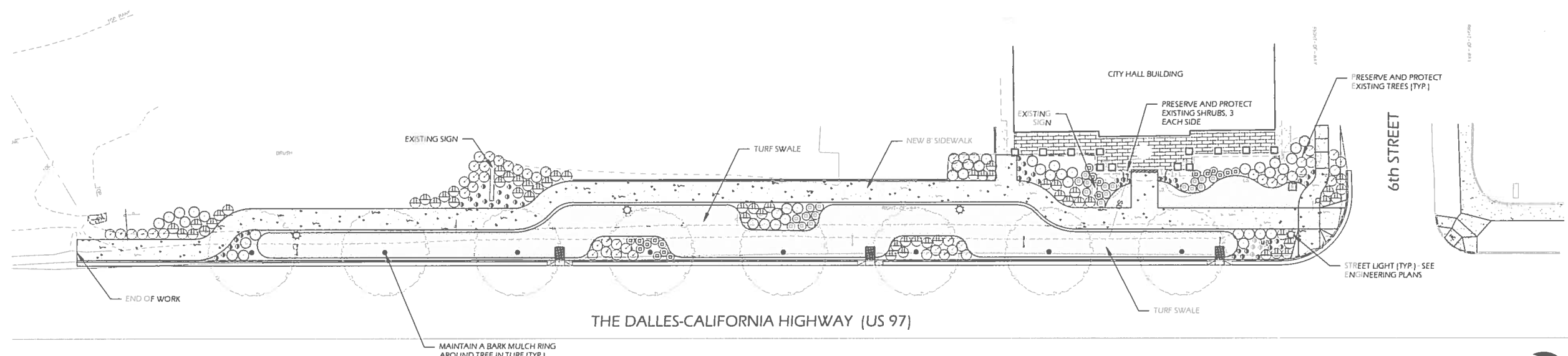

PLANT LEGEND

SYM	BOTANICAL NAME	COMMON NAME	SIZE	QTY.
TREES:				
	ACER x FREEMANII 'SIENNA'	SIENNA GLEN MAPLE	5" CAL	8
	EXISTING VEGETATION	PRESERVE AND PROTECT IN PLACE		
PERENNIALS/ GROUNDCOVERS/ GRASSES:				
	ARCHOSTAPHYLOS UVA-URSI	KINNICKINICK	1 GAL	58
	BRUNNERA M. JACK FROST	JACK FROST BRUNNERA	1 GAL	41
	CERASTIUM TOMENTOSUM	SNOW IN SUMMER	1 GAL	52
	RHUS AROMATICA	GRO-LOW SUMAC	2 GAL	43
	VERONICA S. RED FOX	RED FOX SPIKE SPEEDWELL	1 GAL	55
MISC:				
	TURF	SOD		4515 sf

PLANTING NOTES

- SEE CIVIL ENGINEER'S PLANS FOR EXISTING TREES TO BE REMOVED, IF ANY.
- REFER TO CIVIL ENGINEER'S UTILITY AND GRADING PLANS FOR UTILITY LOCATIONS AND FINAL GRADING. IF ACTUAL SITE CONDITIONS VARY FROM WHAT IS SHOWN ON THE LANDSCAPE ARCHITECT'S PLANS, THE CONTRACTOR SHALL CONTACT THE AUTHORIZED REPRESENTATIVE FOR DIRECTION ON HOW TO PROCEED.
- VERIFY LOCATIONS OF ALL PERTINENT SITE IMPROVEMENTS INSTALLED UNDER OTHER SECTIONS. IF ANY PART OF THIS PLAN CANNOT BE FOLLOWED DUE TO SITE CONDITIONS, CONTACT THE OWNER'S AUTHORIZED REPRESENTATIVE FOR INSTRUCTION PRIOR TO COMMENCING WORK.
- EXACT LOCATIONS OF PLANT MATERIALS SHALL BE REVIEWED BY THE OWNER'S AUTHORIZED REPRESENTATIVE IN THE FIELD PRIOR TO INSTALLATION. OWNER'S REPRESENTATIVE RESERVES THE RIGHT TO ADJUST PLANTS TO EXACT LOCATION IN FIELD.
- CONTRACTOR SHALL BE RESPONSIBLE FOR VERIFYING ALL PLANT COUNTS AND SQUARE FOOTAGES. QUANTITIES ON PLANS TAKE PRECEDENCE OVER WRITTEN QUANTITIES.
- ALL DISTURBED AREAS WITHIN THE PROJECT SITE SHALL BE SCARIFIED TO A MIN. DEPTH OF EIGHT INCHES. PRIOR TO PLANTING, ALL PLANTING AREAS SHALL BE FINE GRADED AND RECEIVE SOIL PREPARATION.
- FINISH GRADES OF ALL TURF AREAS SHALL BE 1" BELOW ADJACENT CURB, PAVEMENT, OR HEADER. FINISH GRADES OF ALL SHRUB AREAS SHALL BE 2" BELOW ADJACENT CURB, PAVEMENT, OR HEADER.
- DO NOT MAKE SUBSTITUTIONS. IF SPECIFIED LANDSCAPE MATERIAL IS NOT OBTAINABLE, SUBMIT PROPOSAL FOR USE OF EQUIVALENT MATERIAL TO THE LANDSCAPE ARCHITECT FOR FINAL APPROVAL.
- PROVIDE A 2" LAYER OF SHREDDED HEMLOCK BARK TO ALL PLANTING AREAS AND DISTURBED AREAS THAT ARE NOT DESIGNATED AS TURF.
- APPLY A PRE-EMERGENT HERBICIDE TO ALL PLANTING AREAS ONCE PRIOR TO INSTALLATION OF MULCH AND ONCE AFTER. NO PRE-EMERGENT SHALL BE USED IN SEEDED AREAS.
- CONTRACTOR SHALL CONDUCT AGRICULTURAL SUITABILITY AND FERTILITY SOILS TESTING. ANALYSIS SHALL INCLUDE RECOMMENDATIONS FOR SOIL PREPARATION AND BACKFILL MIX AS WELL AS RECOMMENDATIONS FOR POST MAINTENANCE FERTILIZATION. SUBMIT SOILS ANALYSIS TO OWNER'S AUTHORIZED REPRESENTATIVE FOR REVIEW PRIOR TO SOIL PREPARATION.
- PLANT ALL TREES A MINIMUM OF 5' FROM ANY ROOF DRAIN LINES. THE LANDSCAPE CONTRACTOR MUST VERIFY THE LOCATION OF ALL DRAIN LINES PRIOR TO COMMENCING WORK.
- TREES ARE TO BE A MINIMUM DISTANCE AWAY FROM CURBS AND ANY HARDSCAPE SUCH AS WALKS, PER LOCAL AGENCY STANDARDS.
- THE INSTALLING CONTRACTOR WILL MAINTAIN/WARRANTEE PLANTING FOR ONE (1) YEAR STARTING FROM THE DATE OF PROJECT FINAL ACCEPTANCE. FOLLOWING THIS ONE YEAR PERIOD, ALL LANDSCAPE AND IRRIGATION WILL BE MAINTAINED BY THE OWNER.
- MAINTAIN PLANTING AND PRUNING HEIGHTS WITHIN CLEAR VISION AREAS PER GOVERNING AGENCY STANDARDS.
- CONTRACTOR IS RESPONSIBLE FOR REPLACEMENT OF ANY EXISTING MATERIALS THAT ARE DAMAGED DURING CONSTRUCTION.

CITY OF LA PINE
CITY HALL SIDEWALK IMPROVEMENT PROJECT

REVISIONS

CONSULTANT
SAGE RESOURCES, INC.
Landscape Architecture
P.O. Box 1311
Sisters, OR 97759
541.549.6227
Marlys Underwood, R.L.A.



PLANTING PLAN

L1.0

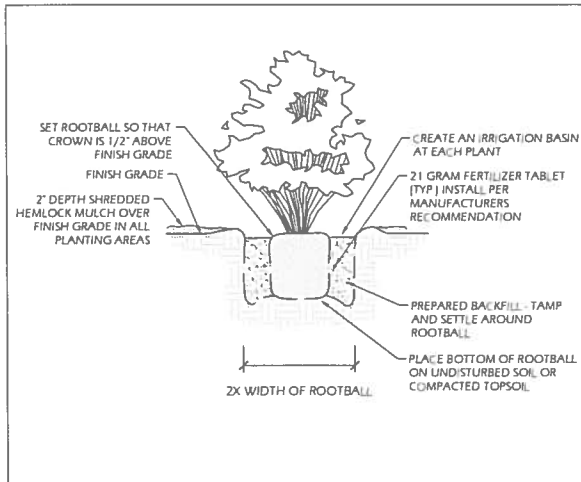

A TREE/ SHRUB PLANTING
SCALE: N.T.S.

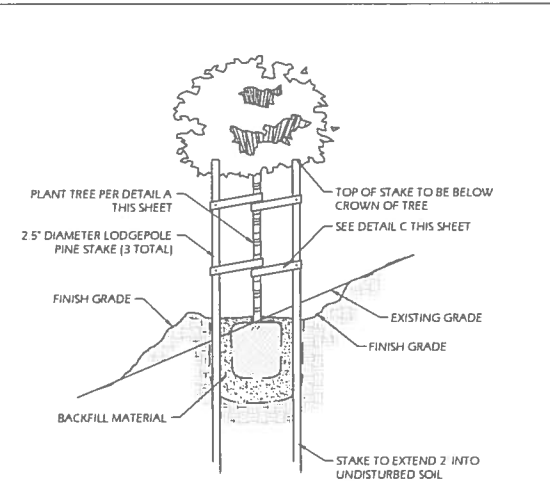

B TREE PLANTING & STAKING ON SLOPE
SCALE: N.T.S.

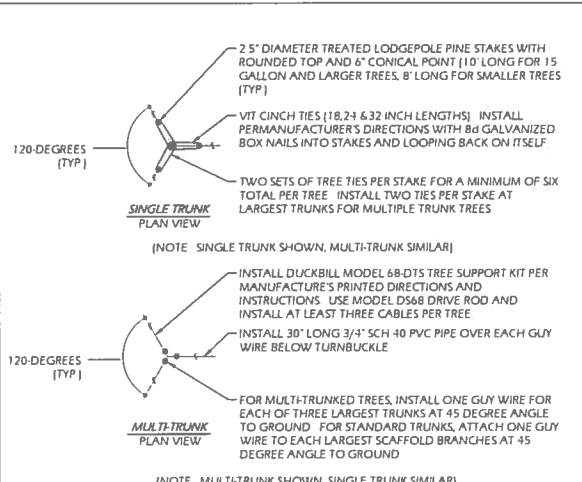

C TREE STAKING/GUYING
SCALE: N.T.S.

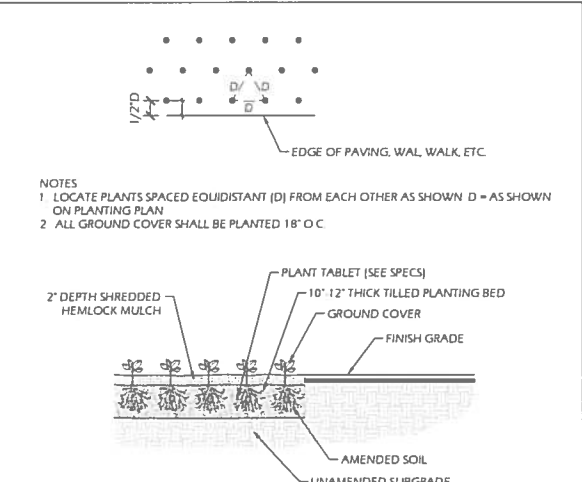

D GROUND COVER PLANTING
SCALE: N.T.S.

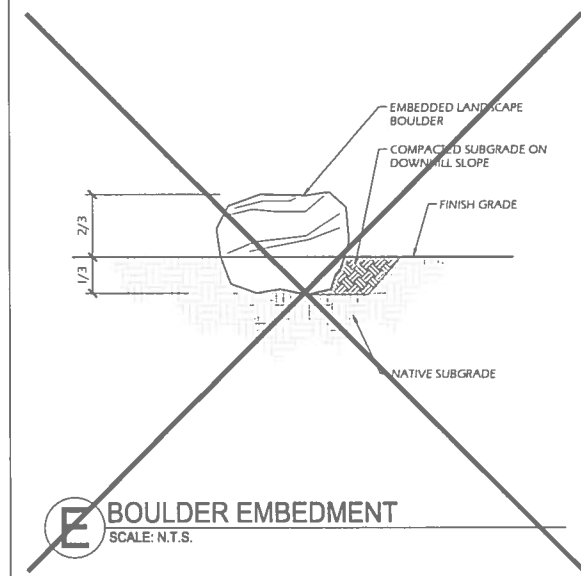

E BOULDER EMBEDMENT
SCALE: N.T.S.

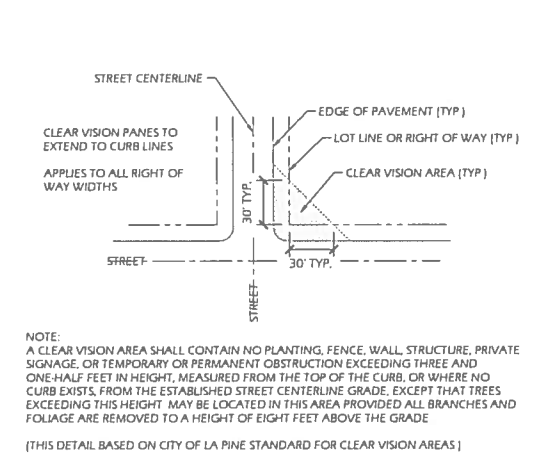

F CLEAR VISION AREAS
SCALE: N.T.S.

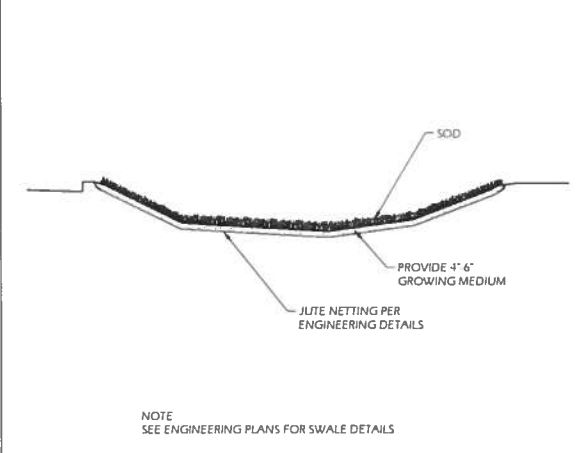

G TURF SWALE
SCALE: N.T.S.



H
SCALE: N.T.S.

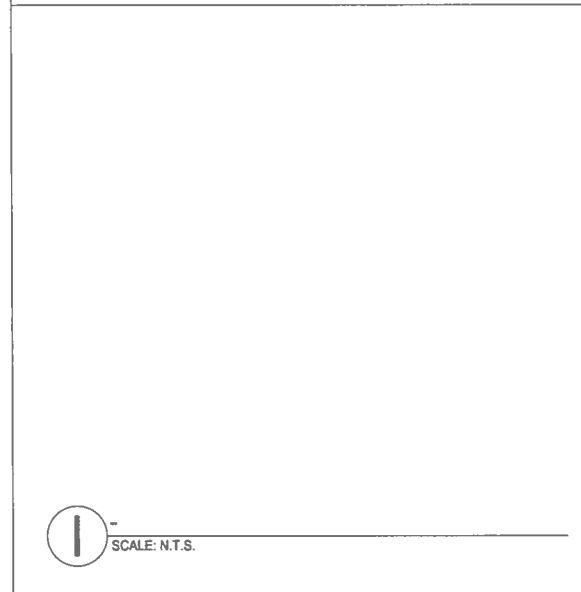

I
SCALE: N.T.S.



J
SCALE: N.T.S.



K
SCALE: N.T.S.

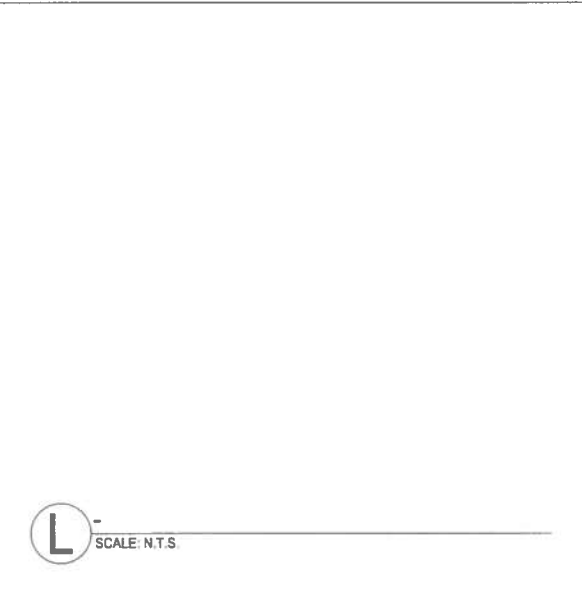

L
SCALE: N.T.S.

REVISIONS

CONSULTANT
SAGE RESOURCES, INC.
Landscape Architecture
P.O. Box 1311
Sisters, OR 97759
541.549.6227
Marlys Underwood, RLA



PLANTING DETAILS

L1.1

NOTE:

THIS DESIGN IS DIAGRAMMATIC AND ALL PIPING, VALVES, ETC SHOWN WITHIN PAVED AREAS IS FOR DESIGN CLARIFICATION ONLY AND SHALL BE INSTALLED IN PLANTING AREAS.

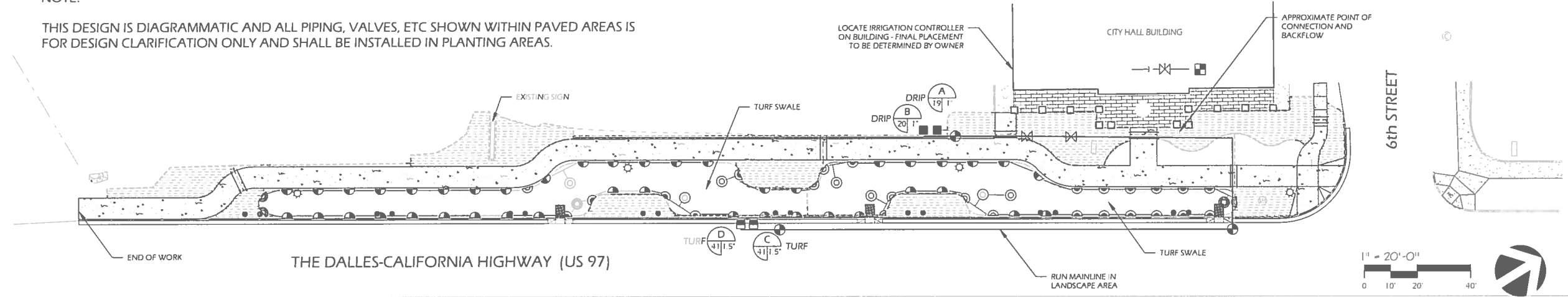

IRRIGATION LEGEND

SYM	PRODUCT	MANUFACTURER	MODEL	SIZE	QTY.
—X—	POINT OF CONNECTION	EXISTING?	-	-	1
☒	6 STATION CONTROLLER	RAINBIRD OR APPROVED EQUAL	ESP MODULAR	-	1
☐	REDUCED PRESSURE BACKFLOW PREVENTER	FEBCO OR APPROVED EQUAL	825Y	-	1
⊗	ISOLATION VALVE	FEBCO OR APPROVED EQUAL	623-BS	-	2
⊕	QUICK COUPLING VALVE	RAINBIRD OR APPROVED EQUAL	44-LRC	1"	3
☐	TURF VALVE	RAINBIRD OR APPROVED EQUAL	150-PEB	1.5"	2
■	DRIP CONTROL ZONE	RAINBIRD OR APPROVED EQUAL	XCZ-100-PRB-COM 1	-	2
○	MANUAL DRAIN VALVE	RAINBIRD OR APPROVED EQUAL	-	-	4
—	MAINLINE	SCHEDULE 40 PVC	-	VARIES	-
—	LATERALS	CLASS 200 PVC	-	VARIES	-
⋯	LANDSCAPE DRIPLINE	RAINBIRD OR APPROVED EQUAL	LD-09-12	-	-
—	SLEEVES	PVC CLASS 200	-	VARIES	-
VARIOUS	SPRAY HEADS	RAINBIRD OR APPROVED EQUAL	SEE HEAD KEY	-	-
● ●	XERI-BUG EMITTERS 2 EMITTERS AT EACH TREE	RAINBIRD OR APPROVED EQUAL	XB-20-PC	-	-

HEAD KEY

SYM	MANUFACTURER & CAT NUMBER	RADIUS	GPM
☉	RAINBIRD 5 SERIES MPR OR APPROVED EQUAL	5'	0.10 - 0.41
☉	RAINBIRD 8 SERIES MPR OR APPROVED EQUAL	8'	0.26 - 1.05
☉	RAINBIRD 10 SERIES MPR OR APPROVED EQUAL	10'	0.39 - 1.58
☉	RAINBIRD 12 SERIES MPR OR APPROVED EQUAL	12'	0.65 - 2.60
☉	RAINBIRD 15 SERIES MPR OR APPROVED EQUAL	15'	0.92 - 3.7

NOTE:
USE VAN SERIES NOZZLES WHERE REQUIRED TO PROVIDE ADEQUATE COVERAGE FOR ALL LAWN AREAS.

IN THE HYDRAULIC DESIGN AND PIPE SIZING, DO NOT EXCEED THE FOLLOWING GPM OF WATER USAGE PER SCHEDULED SIZE.

FLOW	PIPE SIZE	CLASS 200 PVC
1-12 GAL	3/4"	CLASS 200 PVC
12-20 GAL	1"	CLASS 200 PVC
20-30 GAL	1 1/4"	CLASS 200 PVC
30-45 GAL	1 1/2"	CLASS 200 PVC
45-60 GAL	2"	CLASS 200 PVC
60-90 GAL	2 1/2"	CLASS 200 PVC
90-150 GAL	3"	CLASS 200 PVC
150-250 GAL	4"	CLASS 200 PVC
250-600 GAL	6"	CLASS 200 PVC

VALVE CALL OUT

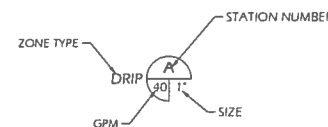

IRRIGATION NOTES

- PRIOR TO COMMENCEMENT OF ANY WORK, THE CONTRACTOR SHALL VERIFY LOCATIONS AND DEPTHS OF ANY UTILITIES THAT MAY BE AFFECTED BY HIS/HER WORK, AND SHALL BE RESPONSIBLE FOR DAMAGES TO SUCH UTILITIES CAUSED AS A RESULT OF THIS WORK.
- THE CONTRACTOR SHALL COMPLY WITH ALL LOCAL, STATE, AND FEDERAL LAWS, CODES, AND REGULATIONS APPLICABLE TO THE IRRIGATION SYSTEM COVERED BY THESE PLANS.
- THE CONTRACTOR IS RESPONSIBLE FOR OBTAINING AND COMPLYING WITH ALL PERMITS REQUIRED TO COMPLETE THE IRRIGATION WORK COVERED BY THESE PLANS.
- THE CONTRACTOR SHALL BE RESPONSIBLE FOR ALL IRRIGATION COVERAGE TO ALL PLANT MATERIAL SPECIFIED. CONTRACTOR SHALL ADJUST SPRINKLER SYSTEM TO PREVENT OVERSPRAY ONTO PAVED OR BUILT STRUCTURES.
- ALL PIPE SHALL BE INSTALLED PER THE MANUFACTURER'S SPECIFICATION AND ASTM STANDARD D-2774 AT THE DEPTHS SHOWN IN THE IRRIGATION DETAILS.
- FLUSHING OF ALL LINES PRIOR TO INSTALLATION OF EMISSION DEVICE IS REQUIRED.
- ALL ELECTRICAL CONNECTIONS SHALL BE MADE AT THE REMOTE CONTROL VALVE BOXES, CONTROLLER ENCLOSURES AND VALVE BOXES SPECIFICALLY FOR ELECTRICAL CONNECTIONS. NO SPLICES SHALL BE MADE WITHOUT BEING IN A VALVE BOX OR ENCLOSURE.
- 110 VOLT ELECTRICAL POWER OUTLET AT THE AUTOMATIC CONTROLLER LOCATION SHALL BE PROVIDED BY OTHERS. THE CONTRACTOR SHALL BE RESPONSIBLE FOR THE FINAL HOOK UP FROM THE ELECTRICAL OUTLET TO THE AUTOMATIC CONTROLLER.
- ALL ELECTRICAL WORK SHALL BE INSTALLED PER LOCAL CODE.
- INSTALL ALL REMOTE CONTROL VALVES AS HIGH AS POSSIBLE BUT ALLOWING CLEARANCE BETWEEN VALVE BOX LID AND FLOW CONTROL HANDLE ON REMOTE CONTROL VALVE.
- ALL PVC SOLVENT WELD FITTINGS SHALL BE 'SPEARS' OR APPROVED EQUAL.
- PROVIDE TWO (2) SPARE WIRES ALONG THE ENTIRE LENGTH OF MAINLINE AND LOOPED INTO EACH ELECTRIC REMOTE CONTROL VALVE BOX.
- THE CONTRACTOR SHALL BE RESPONSIBLE FOR SUPPLYING ALL NECESSARY EQUIPMENT, INCLUDING BUT NOT LIMITED TO ALL WIRING AND ALL LABOR REQUIRED TO PROVIDE A COMPLETE FUNCTIONING CONTROL SYSTEM AS DETAILED ON THE PROJECT PLANS.
- THE REDUCED PRESSURE ASSEMBLY SHALL BE ENCLOSED WITH A "GUARD SHACK" ENCLOSURE OR APPROVED EQUAL.
- TREES, SHRUBS AND TURF SHALL BE ON SEPARATE REMOTE CONTROL VALVES.
- ALL SLEEVES ARE TO HAVE A PULL BOX LOCATED AT EACH END.
- ALL VALVES, CLEAN-OUT, METERS, AND BOXES (INCLUDING IRRIGATION) SHALL BE ADJUSTED TO FINISH GRADE AND SHALL BE INCIDENTAL TO CONSTRUCTION WORK.

CITY OF LA PINE

CITY HALL SIDEWALK IMPROVEMENT PROJECT

REVISIONS

Consultant
SAGE RESOURCES, INC.
Landscape Architecture
P.O. Box 1311
Sisters, OR 97759
541 549 6227
Marlys Underwood, RLA

REGISTERED
802
Marlys A. Underwood
MARLYS A. UNDERWOOD
5222/08
OREGON
LANDSCAPE ARCHITECT

IRRIGATION PLAN

L2.0

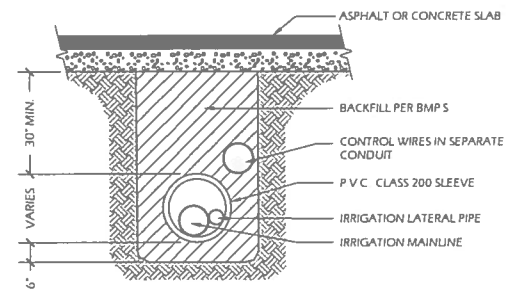

- NOTES:
 1 ALL PVC IRRIGATION SLEEVES TO BE CLASS 200 PIPE
 2 SIZE SLEEVE TWICE THE DIAMETER OF THE PROPOSED UTILITY LINE, OR AS SHOWN ON DRAWING
 3 TRENCH, BACKFILL AND PAVING PER AGENCY STANDARDS
 4 MAINTAIN 4" CLEARANCE BETWEEN 2" AND SMALLER PIPE AND 6" CLEARANCE FOR LARGER PIPE

A SLEEVING/TRENCHING SECTION
 SCALE: N.T.S.

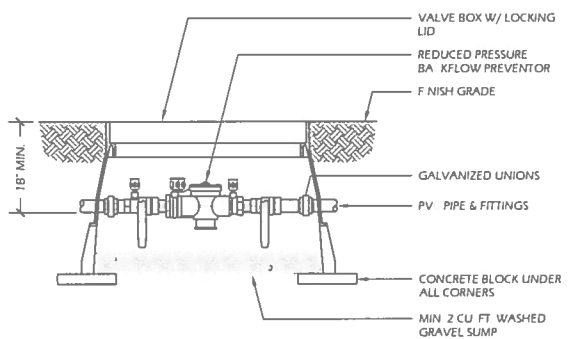

B BACK FLOW PREVENTOR
 SCALE: N.T.S.

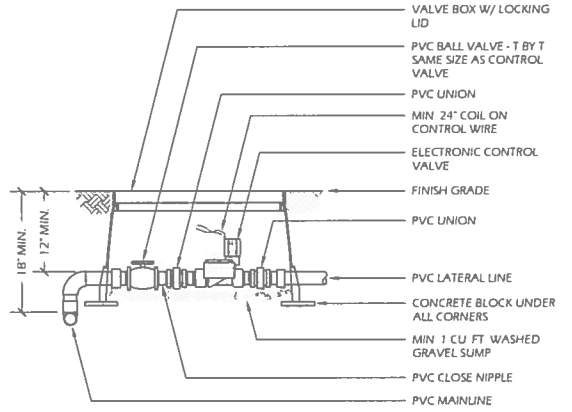

C TURF VALVE
 SCALE: N.T.S.

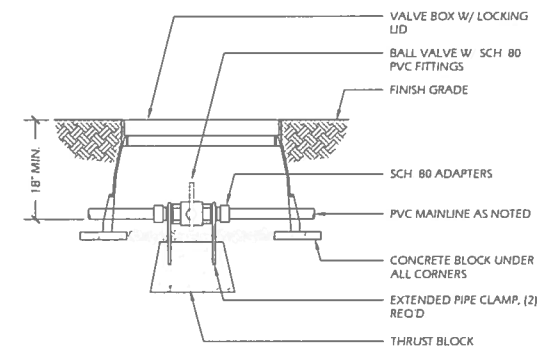

D ISOLATION/GATE VALVE
 SCALE: N.T.S.

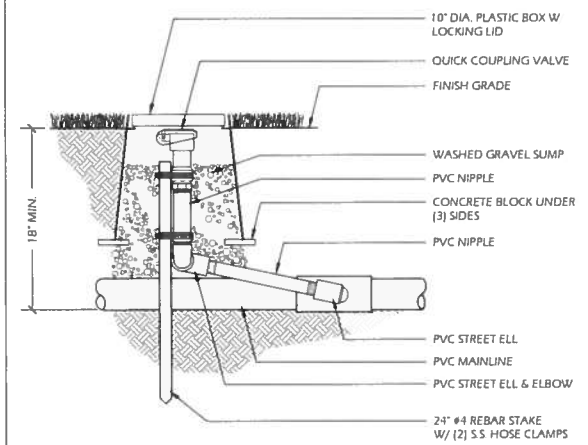

E QUICK COUPLING VALVE
 SCALE: N.T.S.

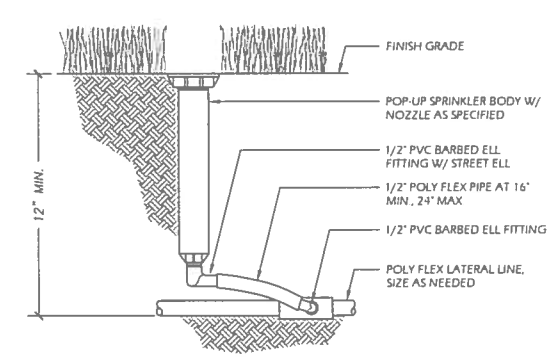

F POLYFLEX RISER - SPRAY
 SCALE: N.T.S.

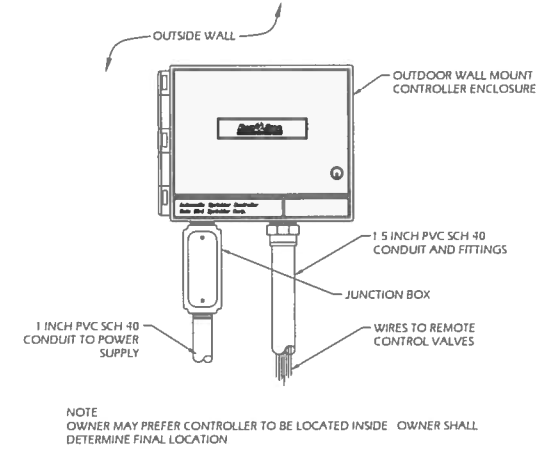

G CONTROLLER ENCLOSURE
 SCALE: N.T.S.

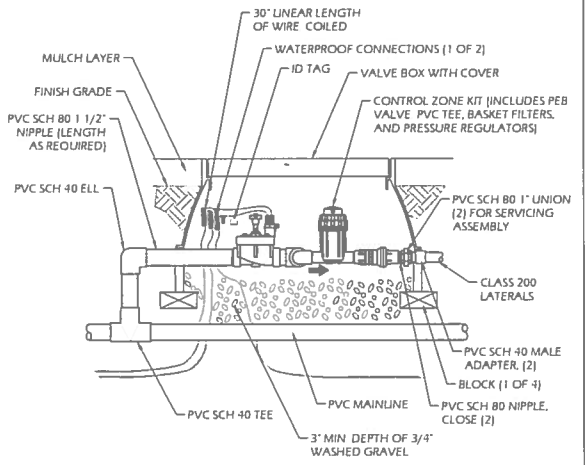

H CONTROL ZONE KIT
 SCALE: N.T.S.

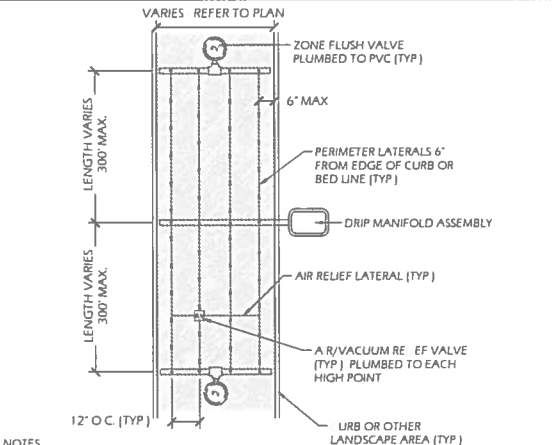

- NOTES:
 1 STAKE DRIP LINE EVERY 4' (TYP)
 2 BURY DRIPLINE BELOW MULCH
 3 INSTALL PER MANUFACTURER'S SPECIFICATIONS

I DRIP LAYOUT DETAIL
 SCALE: N.T.S.

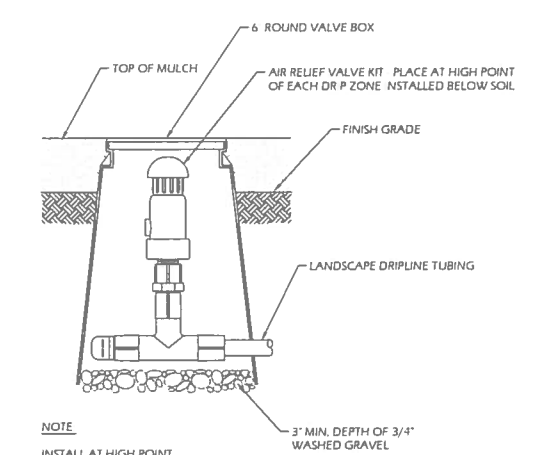

J AIR RELIEF VALVE KIT
 SCALE: N.T.S.

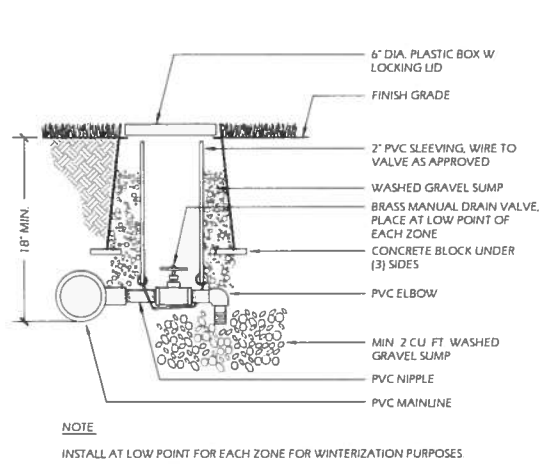

K MANUAL DRAIN VALVE
 SCALE: N.T.S.

CITY OF LA PINE
 CITY HALL - SIDEWALK IMPROVEMENT PROJECT

REVISIONS

Consultant
SAGE RESOURCES, INC.
 Landscape Architecture
 P.O. Box 1311
 Sisters, OR 97759
 541 549 6227
 Marlys Underwood, RLA

REGISTERED
 602
Marlys A. Underwood
 MARLYS A. UNDERWOOD
 572/06
 OREGON
 LANDSCAPE ARCHITECT

IRRIGATION
 DETAILS

L2.1

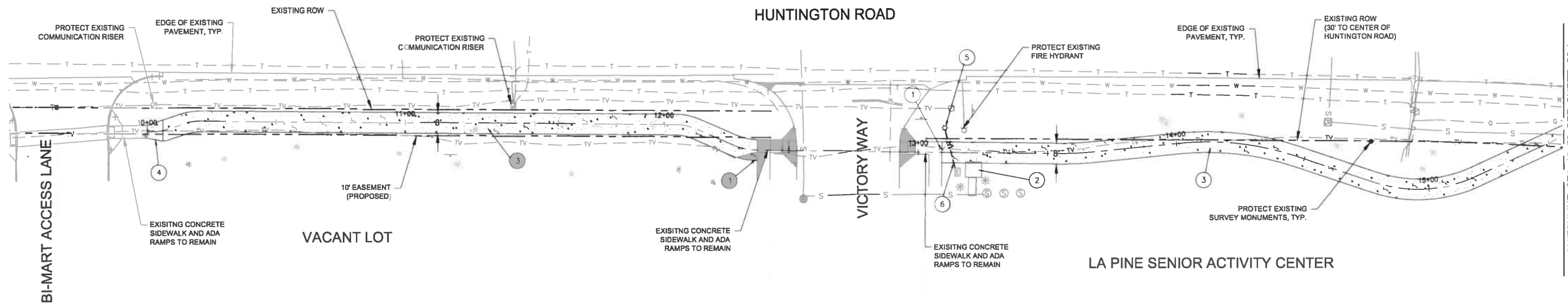
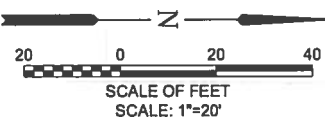

CONSTRUCTION NOTES

- 1 MATCH EXISTING EDGE OF CONCRETE
- 2 RELOCATE PORTABLE SIGN
- 3 CONSTRUCT 8'-WIDE CONCRETE SIDEWALK PER ODOT STANDARD DRAWING RD720.
- 4 CONSTRUCT 5'x8' CONCRETE TRANSITION PANEL. MATCH EXISTING SIDEWALK GRADES.
- 5 CONSTRUCT LIGHT BASE PER DETAIL 5 ON SHEET C1.2
- 6 INSTALL ELECTRIC CONDUIT PER DETAIL 1 ON SHEET C1.2.

HUNTINGTON PATH PLAN

SCALE: 1" = 20'



GENERAL NOTES

- 1. CONTRACTOR TO MEANDER PATH WITHIN SHOWN LIMITS AS REASONABLE. MEANDER PATH TO AVOID ABOVE GROUND CONFLICTS, EXCESSIVE GRADING, AND TO MINIMIZE TREE CUTTING.
- 2. MINIMUM CENTERLINE PATH RADIUS = 15 FEET.
- 3. CONTRACTOR TO FLAG CENTERLINE OF PREFERRED ALIGNMENT FOR AC PATH EVERY 50 FEET INCLUDING MID-POINT OF EACH CURVE PRIOR TO ANY CONSTRUCTION. NOTIFY ENGINEER WHEN ALIGNMENT IS FLAGGED. CONTRACTOR SHALL BE EXPECTED TO PROVIDE MINOR ADJUSTMENTS TO THIS INITIAL FLAGGED ALIGNMENT IF REQUESTED BY THE ENGINEER.
- 4. NOTIFY ENGINEER OF ANY UNFORESEEN OBSTACLES.

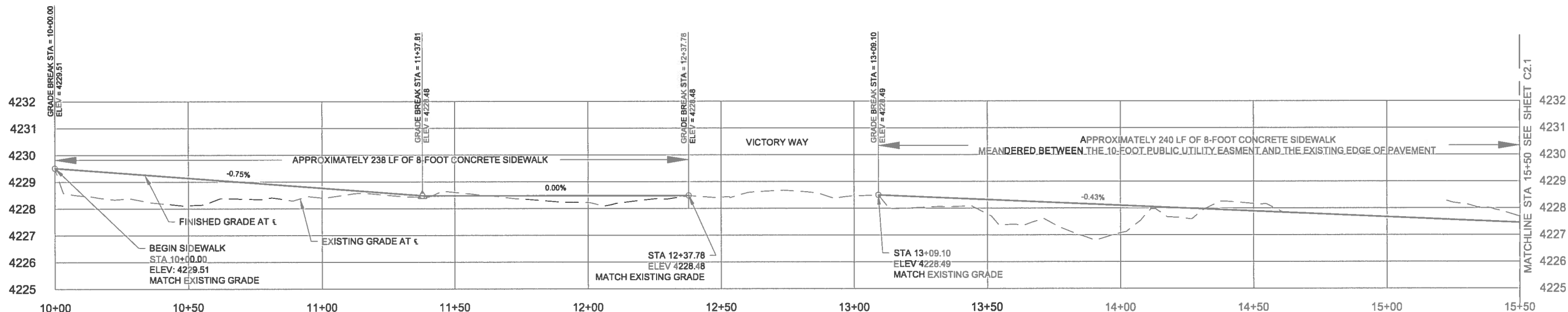

HUNTINGTON PATH PROFILE

SCALE: H: 1" = 20'
V: 1" = 2'



NO.	DATE	BY	APPR	REVISIONS

VERIFY SCALES
BAR IS ONE INCH ON ORIGINAL DRAWING.
IF NOT ONE INCH ON THIS SHEET, ADJUST SCALES ACCORDINGLY.



DESIGNED BY: TH3
DRAWN BY: GJR
CHECKED BY: JML
SCALE: AS SHOWN
DATE: APRIL 2014
PROJECT NO: 12454.001.01

BEND OFFICE
3020 SW EMKAY DRIVE #100
BEND, OR 97702
541.322.8962
541.382.2423 (FAX)
WWW.CENTURYWEST.COM

CITY OF LA PINE
SIDEWALK AND MULTI-USE PATH IMPROVEMENT PROJECTS

HUNTINGTON PATH PLAN AND PROFILE
STA 10+00 TO 15+50
SCHEDULE B

DRAWING NO. C2.0
SHEET NO. 9 of 13

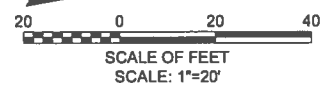
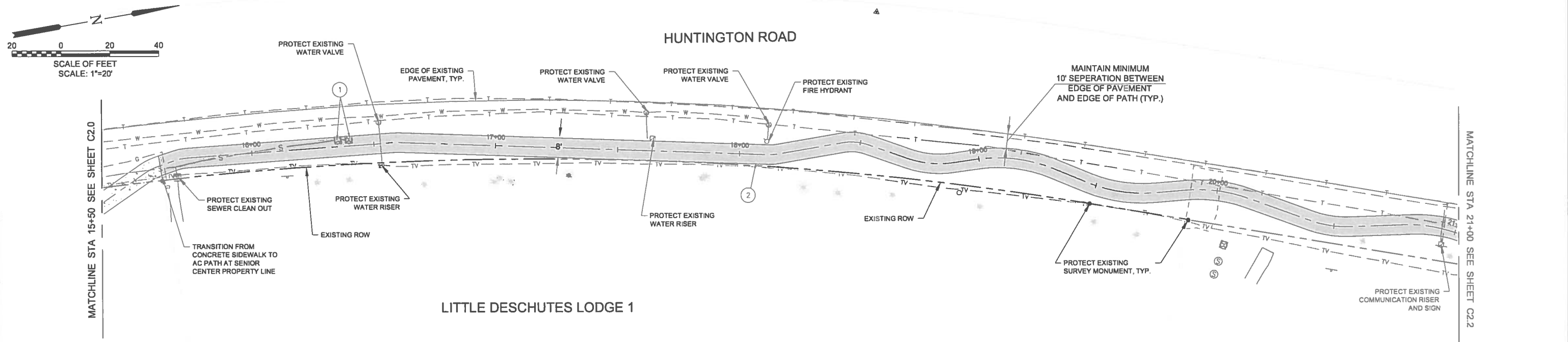

LITTLE DESCHUTES LODGE 1

LITTLE DESCHUTES LODGE 2

HUNTINGTON PATH PLAN
SCALE: 1" = 20'
1
C2.1

CONSTRUCTION NOTES

- 1 EXISTING SEWER CLEANOUTS TO REMAIN IN PLACE. LOCATE PRIOR TO CONSTRUCTION. CONTRACTOR TO MEANDER PATH TO AVOID IF POSSIBLE, OR ADJUST STRUCTURES TO MATCH FINISH GRADE IF NECESSARY.
- 2 CONSTRUCT AC PATHWAY PER DETAIL 1 ON SHEET C2.4

GENERAL NOTES

- 1. CONTRACTOR TO MEANDER PATH WITHIN SHOWN LIMITS AS REASONABLE. MEANDER PATH TO AVOID ABOVE GROUND CONFLICTS, EXCESSIVE GRADING, AND TO MINIMIZE TREE CUTTING.
- 2. MINIMUM CENTERLINE PATH RADIUS = 15 FEET.
- 3. CONTRACTOR TO FLAG CENTERLINE OF PREFERRED ALIGNMENT FOR AC PATH EVERY 50 FEET INCLUDING MID-POINT OF EACH CURVE PRIOR TO ANY CONSTRUCTION. NOTIFY ENGINEER WHEN ALIGNMENT IS FLAGGED. CONTRACTOR SHALL BE EXPECTED TO PROVIDE MINOR ADJUSTMENTS TO THIS INITIAL FLAGGED ALIGNMENT IF REQUESTED BY THE ENGINEER.
- 4. NOTIFY ENGINEER OF ANY UNFORESEEN OBSTACLES.

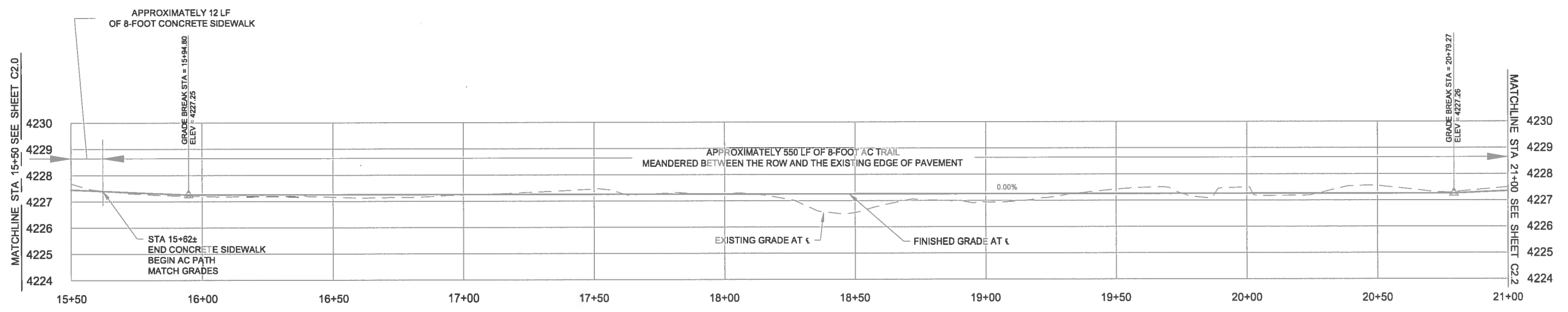

HUNTINGTON PATH PROFILE
SCALE: H: 1" = 20'
V: 1" = 2'
2
C2.1

NO.	DATE	BY	APPR	REVISIONS

VERIFY SCALES
BAR IS ONE INCH ON ORIGINAL DRAWING.
0" = 1"
IF NOT ONE INCH ON THIS SHEET, ADJUST SCALES ACCORDINGLY.

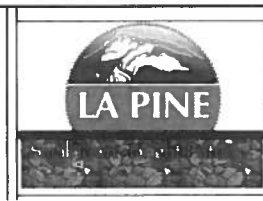
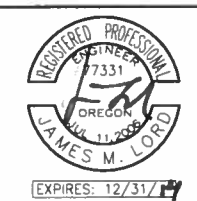

CENTURY WEST ENGINEERING CORPORATION

DESIGNED BY: TH3
DRAWN BY: GJR
CHECKED BY: JML
SCALE: AS SHOWN
DATE: APRIL 2014
PROJECT NO: 12454.001.01

SEND OFFICE
1020 SW EMKAY DRIVE #100
BEND, OR 97702
541.322.8562
541.382.2423 (FAX)
WWW.CENTURYWEST.COM

CITY OF LA PINE
SIDEWALK AND MULTI-USE PATH IMPROVEMENT PROJECTS

HUNTINGTON PATH PLAN AND PROFILE
STA 15+50 TO 21+00
SCHEDULE B

DRAWING NO.
C2.1

SHEET NO.
10 of 13

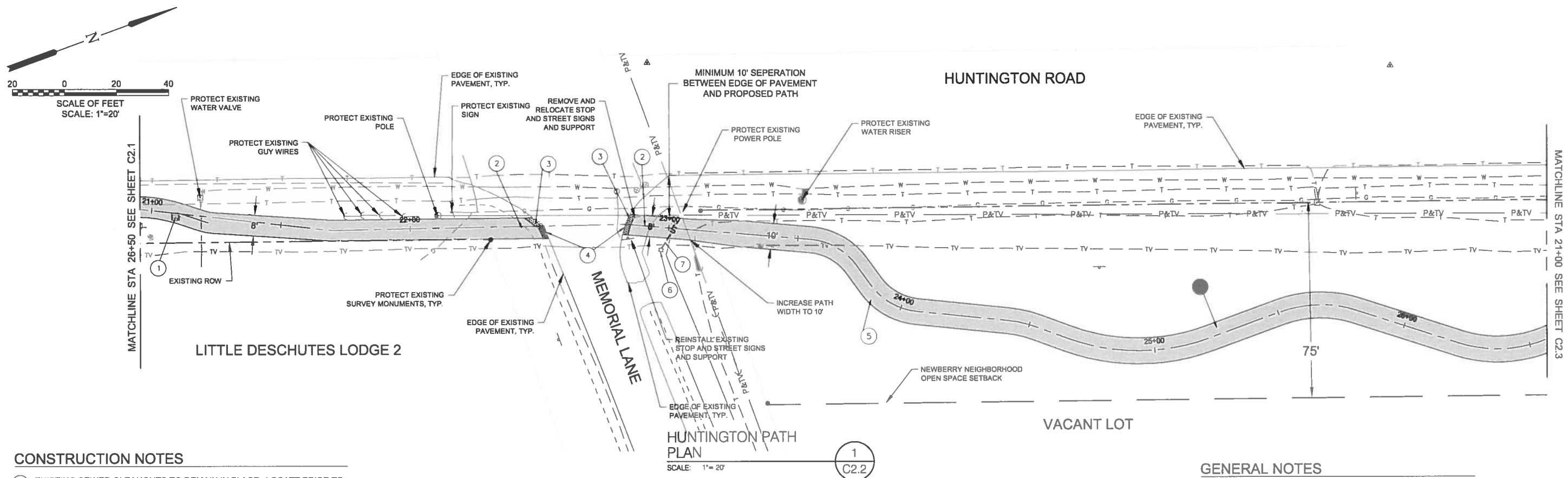

CONSTRUCTION NOTES

- 1 EXISTING SEWER CLEANOUTS TO REMAIN IN PLACE. LOCATE PRIOR TO CONSTRUCTION. CONTRACTOR TO MEANDER PATH TO AVOID IF POSSIBLE, OR ADJUST STRUCTURES TO MATCH FINISH GRADE IF NECESSARY.
- 2 CONSTRUCT ADA BLENDED TRANSITION PER DETAIL 3 ON SHEET C-2.4
- 3 CONSTRUCT ADA DETECTABLE WARNING PER DETAIL 4 ON SHEET C-2.4
- 4 MATCH EXISTING EDGE OF PAVEMENT
- 5 CONSTRUCT AC PATH PER DETAIL 1 ON SHEET C-2.4
- 6 CONSTRUCT LIGHT BASE PER DETAIL 5 ON SHEET C1.2
- 7 INSTALL ELECTRICAL CONDUIT PER DETAIL 1 ON SHEET C1.2

GENERAL NOTES

1. CONTRACTOR TO MEANDER PATH WITHIN SHOWN LIMITS AS REASONABLE. MEANDER PATH TO AVOID ABOVE GROUND CONFLICTS, EXCESSIVE GRADING, AND TO MINIMIZE TREE CUTTING.
2. MINIMUM CENTERLINE PATH RADIUS = 15 FEET.
3. CONTRACTOR TO FLAG CENTERLINE OF PREFERRED ALIGNMENT FOR AC PATH EVERY 50 FEET INCLUDING MID-POINT OF EACH CURVE PRIOR TO ANY CONSTRUCTION. NOTIFY ENGINEER WHEN ALIGNMENT IS FLAGGED. CONTRACTOR SHALL BE EXPECTED TO PROVIDE MINOR ADJUSTMENTS TO THIS INITIAL FLAGGED ALIGNMENT IF REQUESTED BY THE ENGINEER.
4. NOTIFY ENGINEER OF ANY UNFORESEEN OBSTACLES.

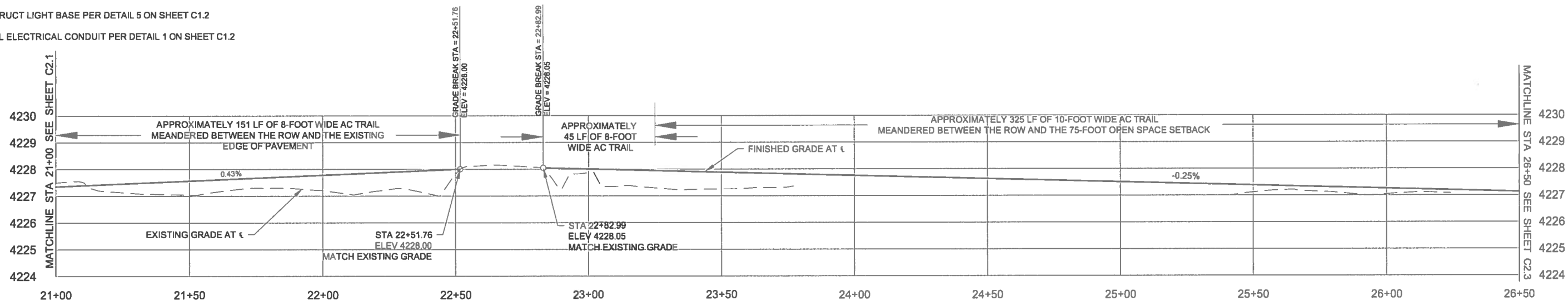

HUNTINGTON PATH PROFILE

SCALE: H: 1" = 20'
V: 1" = 2'

NO.	DATE	BY	APPR	REVISIONS

VERIFY SCALES
BAR IS ONE INCH ON ORIGINAL DRAWING.
0" ██████████ 1"
IF NOT ONE INCH ON THIS SHEET, ADJUST SCALES ACCORDINGLY.



DESIGNED BY: TH3
DRAWN BY: GJR
CHECKED BY: JML
SCALE: AS SHOWN
DATE: APRIL 2014
PROJECT NO: 12454.001.01

SEND OFFICE
1020 SW EMKAY DRIVE #100
BEND, OR 97702
541.322.8962
541.382.2423 (FAX)
WWW.CENTURYWEST.COM

CITY OF LA PINE
SIDEWALK AND MULTI-USE PATH IMPROVEMENT PROJECTS
HUNTINGTON PATH PLAN AND PROFILE
STA 21+00 TO 26+50
SCHEDULE B

DRAWING NO.
C2.2
SHEET NO.
11 of 13

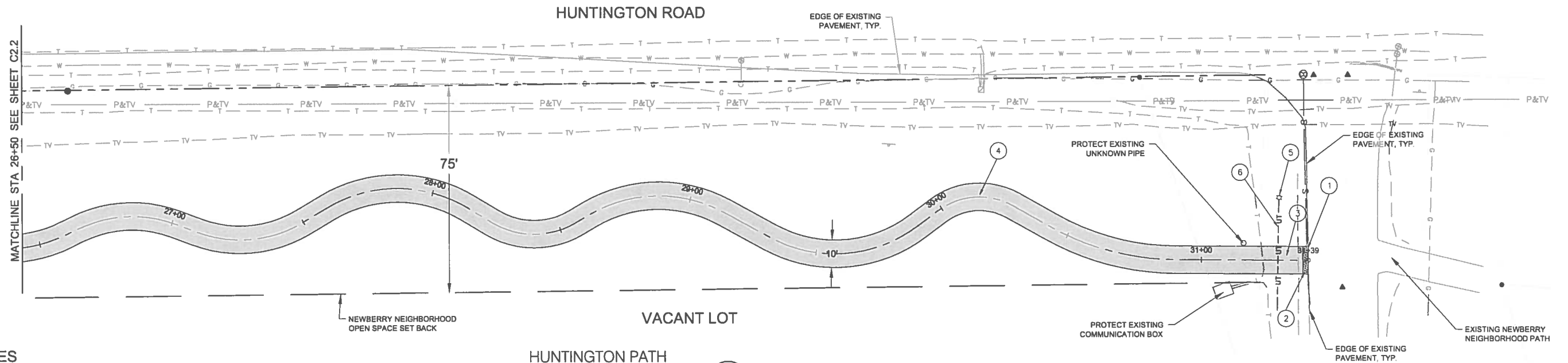
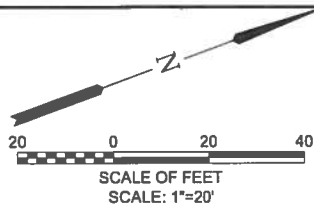

CONSTRUCTION NOTES

- ① MATCH EXISTING EDGE OF PAVEMENT
- ② CONSTRUCT ADA BLENDED TRANSITION PER DETAIL 3 ON DRAWING C2.4
- ③ CONSTRUCT ADA DETECTABLE WARNING PER DETAIL 4 ON DRAWING C2.4
- ④ CONSTRUCT AC PATH PER DETAIL 1 ON SHEET C2.4
- ⑤ CONSTRUCT LIGHT BASE PER DETAIL 5 ON SHEET C1.2
- ⑥ INSTALL ELECTRICAL CONDUIT PER DETAIL 1 ON SHEET C1.2

HUNTINGTON PATH PLAN

SCALE: 1"=20'

1
C2.3

GENERAL NOTES

- 1. CONTRACTOR TO MEANDER PATH WITHIN SHOWN LIMITS AS REASONABLE. MEANDER PATH TO AVOID ABOVE GROUND CONFLICTS, EXCESSIVE GRADING, AND TO MINIMIZE TREE CUTTING.
- 2. MINIMUM CENTERLINE PATH RADIUS = 15 FEET.
- 3. CONTRACTOR TO FLAG CENTERLINE OF PREFERRED ALIGNMENT FOR AC PATH EVERY 50 FEET INCLUDING MID-POINT OF EACH CURVE PRIOR TO ANY CONSTRUCTION. NOTIFY ENGINEER WHEN ALIGNMENT IS FLAGGED. CONTRACTOR SHALL BE EXPECTED TO PROVIDE MINOR ADJUSTMENTS TO THIS INITIAL FLAGGED ALIGNMENT IF REQUESTED BY THE ENGINEER.
- 4. NOTIFY ENGINEER OF ANY UNFORESEEN OBSTACLES.

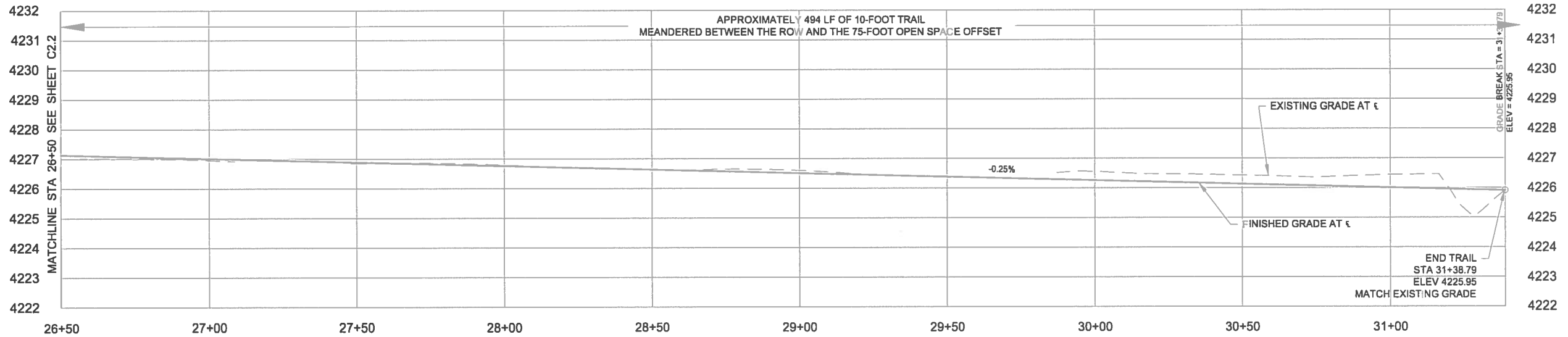

HUNTINGTON PATH PROFILE

SCALE: H: 1"=20'
V: 1"=2'

2
C2.3

NO.	DATE	BY	APPR	REVISIONS

VERIFY SCALES
BAR IS ONE INCH ON ORIGINAL DRAWING.
IF NOT ONE INCH ON THIS SHEET, ADJUST SCALES ACCORDINGLY.



DESIGNED BY: TH3
DRAWN BY: GJR
CHECKED BY: JML
SCALE: AS SHOWN
DATE: APRIL 2014
PROJECT NO: 12454.001.01

RENO OFFICE
1020 SW EMMA DRIVE #100
RENO, OR 97702
541.322.8962
541.382.2423 (FAX)
WWW.CENTURYWEST.COM

CITY OF LA PINE
SIDEWALK AND MULTI-USE PATH IMPROVEMENT PROJECTS
HUNTINGTON PATH PLAN AND PROFILE
STA 26+50 TO 31+39
SCHEDULE B

DRAWING NO.
C2.3
SHEET NO.
12 of 13

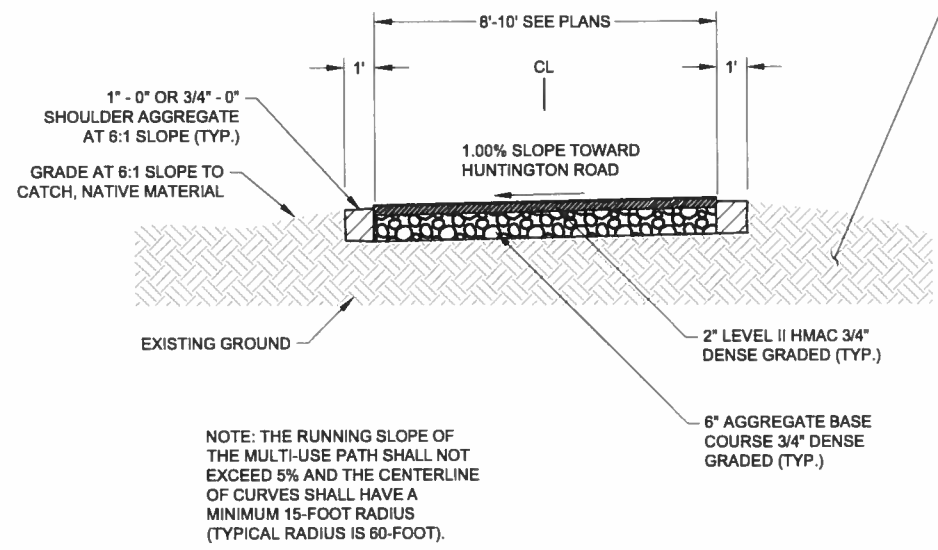

CONTRACTOR TO MATCH EXISTING GROUND AS MUCH AS POSSIBLE WITHIN DEFINED LIMITS. NO ADDITIONAL PAYMENT WILL BE MADE FOR EXCAVATION OR EMBANKMENT WORK.

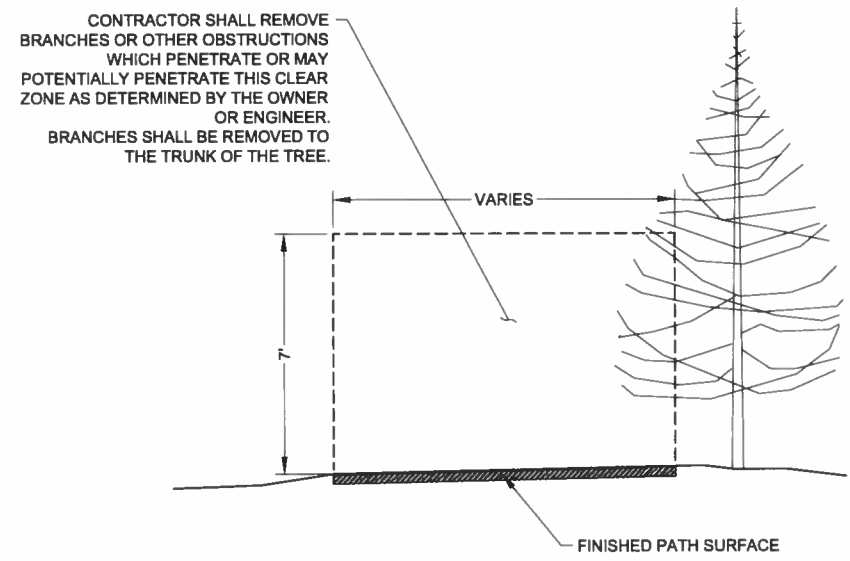

MULTI-USE PATH TYPICAL SECTION
N.T.S. 1
C2.4

PATH CLEAR ZONE
N.T.S. 2
C2.4

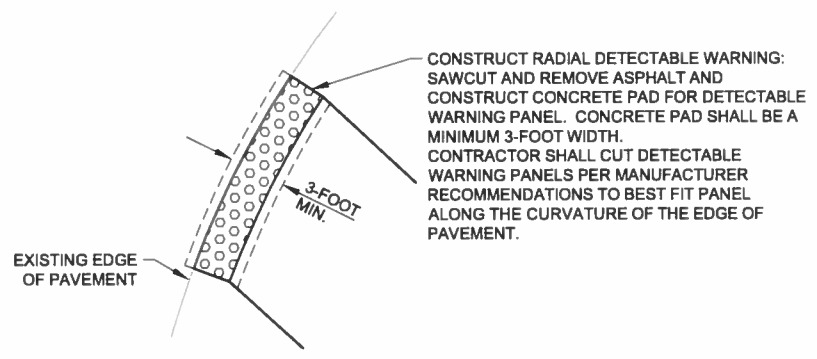
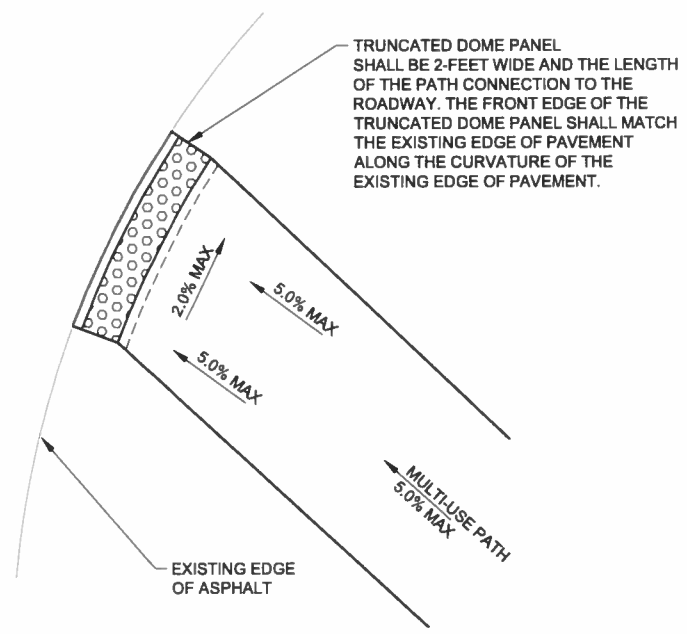

BLENDED TRANSITION
N.T.S. 3
C2.4

DETECTABLE WARNING
N.T.S. 4
C2.4

BID DOCUMENTS

NO.	DATE	BY	APPR	REVISIONS

VERIFY SCALES
BAR IS ONE INCH ON ORIGINAL DRAWING. IF NOT ONE INCH ON THIS SHEET, ADJUST SCALES ACCORDINGLY.

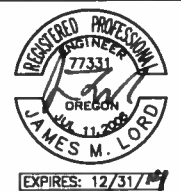

CENTURY WEST ENGINEERING CORPORATION

DESIGNED BY: THS DRAWN BY: GJR CHECKED BY: JML SCALE: AS SHOWN

DATE: APRIL 2014 PROJECT NO: 12454.001.01

BEND OFFICE
1020 SW EMKAY DRIVE #100
BEND, OR 97702
541.322.8962
541.382.2423 (FAX)
WWW.CENTURYWEST.COM

CITY OF LA PINE
SIDEWALK AND MULTI-USE PATH IMPROVEMENT PROJECT

HUNTINGTON PATH GENERAL CONSTRUCTION DETAILS SCHEDULE B

DRAWING NO. **C2.4**

SHEET NO. **13 of 13**