

ENTRY MONUMENT SIGN & FLAG POLES

LA PINE, OREGON

SZABO
LANDSCAPE
ARCHITECTURE

1000 NW WALL ST., STE 250 | BEND, OR 97703
541.382.2059 | WWW.SZABO-LA.COM



1 SIGN ELEVATION SCHEMATIC RENDERING

PROJECT INFORMATION

PROJECT DESCRIPTION: DEVELOPMENT OF LA PINE CITY ENTRY MONUMENT SIGN AND FLAG POLES
ADDRESS: 16345 6TH ST.
LA PINE, OR 97739
PROJECT SITE AREA: APPROXIMATELY 2,500 SQUARE FEET

PROJECT DIRECTORY

OWNER: CITY OF LA PINE
16345 6TH STREET
LA PINE, OR 97739
CONTACT: CORY MISLEY
EMAIL: CMISLEY@LAPINEOREGON.GOV
PHONE: 541.536.1432

LANDSCAPE ARCHITECT: SZABO LANDSCAPE ARCHITECTURE, LLC
1000 NW WALL STREET, SUITE 250
BEND, OR 97703
CONTACT: BRIAN NIERMAN, PLA
EMAIL: BRIAN@SZABO-LA.COM
PHONE: 541.382.2059

SHEET INDEX

SHEET	DESCRIPTION
L001	COVER SHEET
LC101	SITE CONSTRUCTION PLAN
LC501	CONSTRUCTION DETAILS
LC502	CONSTRUCTION DETAILS
LI101	IRRIGATION PLAN
LI501	IRRIGATION DETAILS
LI502	IRRIGATION DETAILS
LP101	PLANTING PLAN
LP501	PLANTING DETAILS

landscape architect's seal

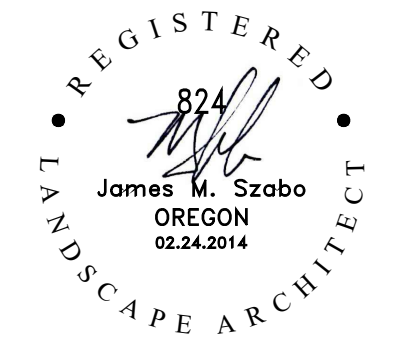

consultant

revision schedule

no.	date	description

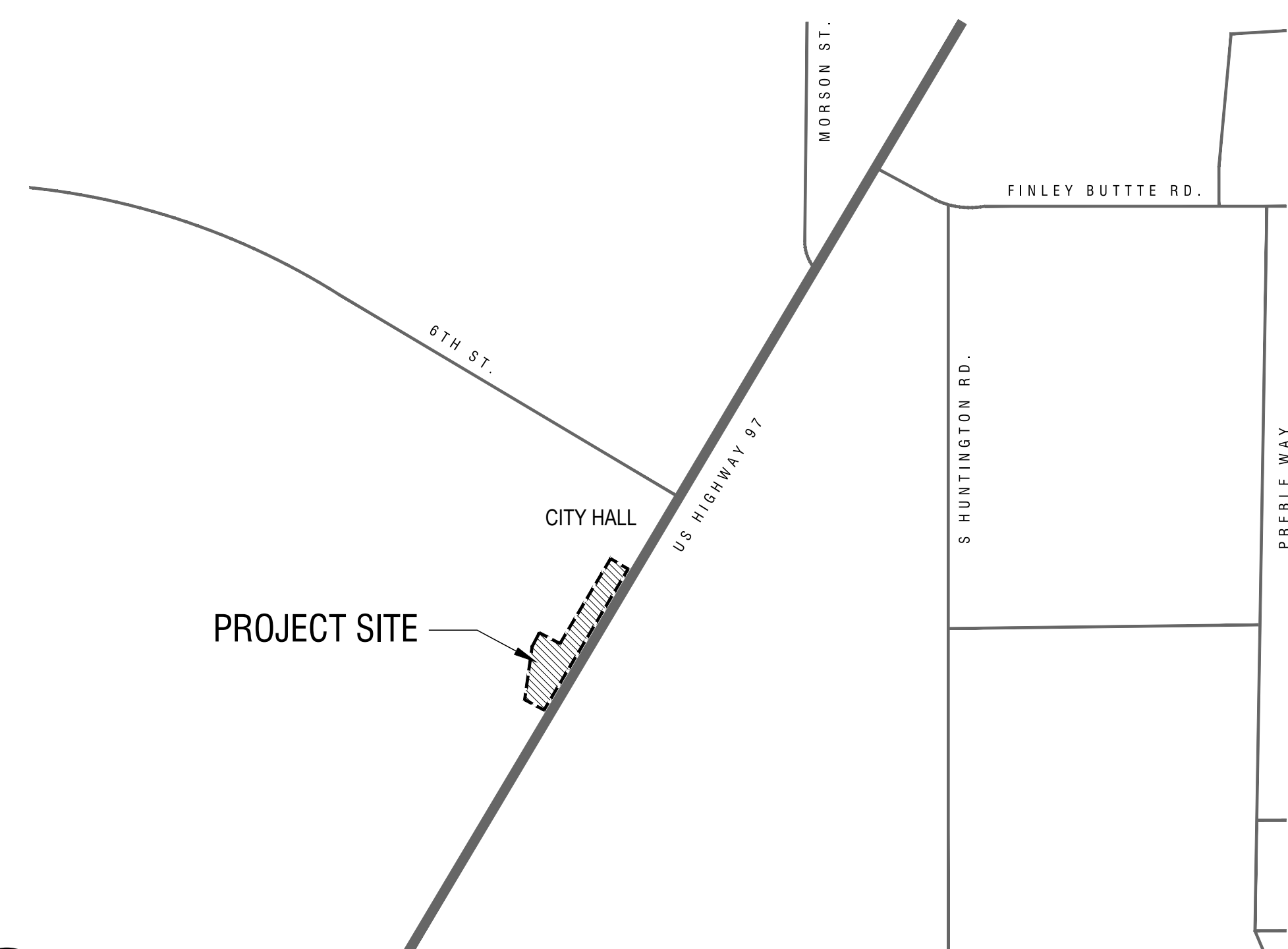

2 VICINITY MAP

N.T.S.

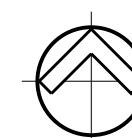

project

La Pine Entry Monument
Sign & Flag Poles
La Pine, OR

date

2018.03.20

sla project number

1635

agency project number

sheet description

COVER SHEET

sheet number

L001

project phase

ISSUE FOR BID

SZABO

LANDSCAPE ARCHITECTURE

1000 NW WALL ST., STE 250 | BEND, OR 97703
541.382.2059 | WWW.SZABO-LA.COM

landscape architect's seal



consultant

revision schedule

no.	date	description
-----	------	-------------

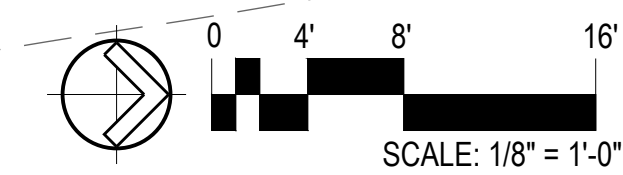
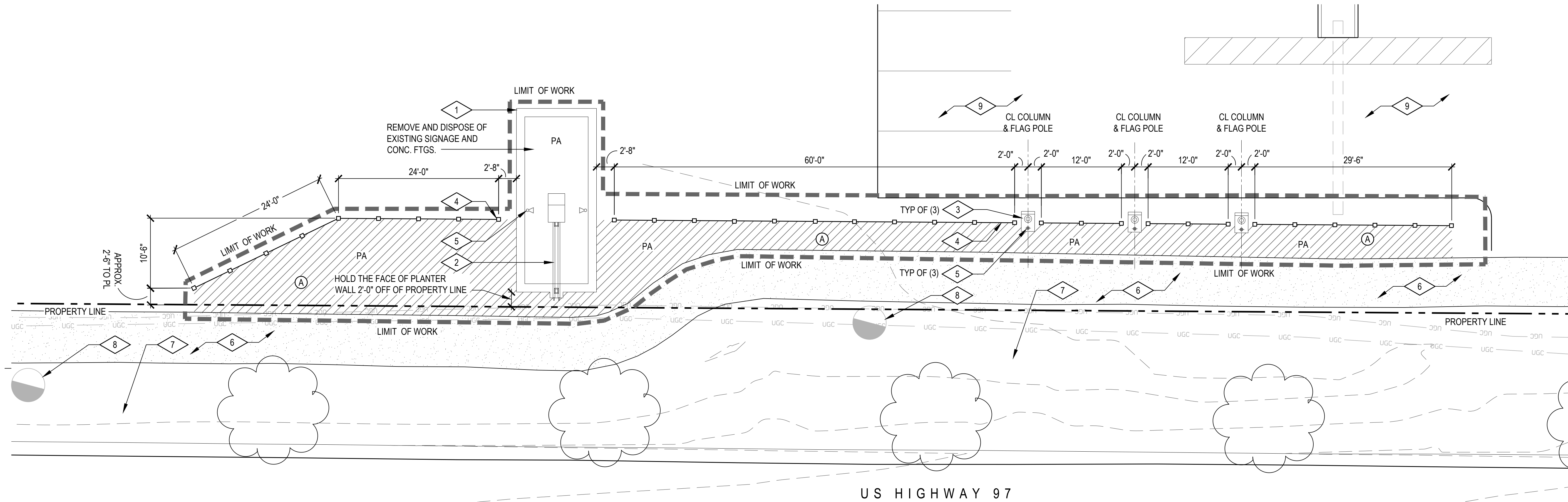

CONSTRUCTION LEGEND

SYMBOL	DESCRIPTION
	AREA OF CLEARING AND GRUBBING, CONTRACTOR TO ENSURE ADEQUATE 6" MIN. DEPTH TOPSOIL PRIOR TO PLANTING, IMPORT AS REQ. (BID ALT #06)

CONSTRUCTION SYMBOLS & ABBREVIATIONS

SYMBOL	DESCRIPTION	SYMBOL	DESCRIPTION
PA	PLANTING AREA		POINT OF ORIGIN
	ALIGN	PAV.	PAVING
SIM.	SIMILAR	JTS.	JOINTS
TYP.	TYPICAL	EQ.	EQUAL
FS	FINISH SURFACE	DI	DRAIN INLET
TW	TOP OF WALL		SLOPE

LIGHTING LEGEND

SYMBOL	DESCRIPTION	DETAIL
NOTES: CONTRACTOR SHALL PROVIDE SHOP DRAWINGS AND FIXTURE CUT-SHEET SUBMITTALS FOR REVIEW AND APPROVAL PRIOR TO INSTALL. ELECTRICAL DRAWINGS SHALL BE DESIGN BUILD		
	F1 - COLUMN UPLIGHT: FC FLOODLIGHT MDL# FC1103-UNV-4K-BK-ASY-AS TO BE INSTALLED w/ ARCHITECTURAL SURFACE MOUNT	4 / LC502 PER MANUF
	F2 - FLAG POLE UPLIGHT: ARCLUCE INGROUND 180 SERIES MDL# O-IG-6-2-1-4-US-30-S	4 / LC502 PER MANUF

BID ALTERNATES

BID ALTERNATE WORK (THIS SHEET) INCLUDES THE FOLLOWING:

- FLAGPOLE w/ INTERNAL HALYARD (SEE DET 2 / SHT LC502)
- ALTERNATE "ESTABLISHED DATE" SIGN OPTION (SEE DET 3 / SHT LC501)
- STONE PLANTER WALL HEIGHT RAISED 6" FROM 12"HT TO 18"HT (SEE DET 1 / SHT LC501)
- UPGRADE STONE VENEER (INC. STONE PLANTER WALL, DET 2 / SHT LC501; MONUMENT SIGN, DET 2 / SHT LC501; & FLAG POLE BASES, DET 1 / SHT LC502)
- SPLIT RAIL FENCE (SEE DET 3 / LC502)
- CLEARING, GRUBBING, & SOIL PREP FOR HATCHED PLANTING (AREA "A" ON PLANS)

CONSTRUCTION KEYTAGS

SYMBOL	DESCRIPTION	DETAIL	SPEC. SECTION
	SITE WALL w/ STONE VENEER	1 / L501	044313
	ENTRY MONUMENT SIGN	2 / L501	044313, 055000, & 061063
	FLAG POLE w/ STONE BASE	1&2 / L502	044313
	2-RAIL SPLIT CEDAR FENCE (BID ALT #05)	3 / L502	061063
	SIGHT LIGHTING - SEE LEGEND	-	-
	EXISTING CONCRETE SIDEWALK TO REMAIN, PROTECT IN PLACE	-	-
	EXISTING PLANTING TO REMAIN PROTECT IN PLACE	-	-
	EXISTING SITE LIGHTING TO REMAIN PROTECT IN PLACE	-	-
	FUTURE PARKING LOT EXPANSION FOR REFERENCE - NIC	-	-

CONSTRUCTION NOTES

- CONTRACTOR SHALL PROVIDE STRUCTURALLY ENGINEERED SHOP DRAWINGS FOR ALL SIGNAGE AND FLAG POLE STRUCTURAL CONSIDERATIONS INCLUDING, BUT NOT LIMITED TO, CONCRETE FOOTINGS, CARRIAGE BOLT SIZING, STRUCTURAL CMU CORE, STEEL REINFORCING, AND STRUCTURAL WELDS.
- UTILITIES ARE SHOWN FOR REFERENCE ONLY. CONTRACTOR SHALL LOCATE AND PROTECT ALL EXISTING UTILITIES. ANY DAMAGE CAUSED BY THE CONTRACTOR SHALL BE REPAIRED TO THE SATISFACTION OF THE OWNER AT NO ADDITIONAL COST.
- CONTRACTOR SHALL TAKE ALL NECESSARY PRECAUTIONS TO PROTECT EXISTING ROADWAYS, WALKS, CURB AND GUTTERS, UTILITIES AND VEGETATION. DAMAGE TO EXISTING FEATURES CAUSED BY CONSTRUCTION ACTIVITIES SHALL BE REPLACED AT THE CONTRACTOR'S EXPENSE.
- CONTRACTOR SHALL COORDINATE STAGING AREA WITH OWNER OR LANDSCAPE ARCHITECT PRIOR TO START. PROTECTION OF WORK AND CONTRACTOR STAGING AREA IS THE RESPONSIBILITY OF THE CONTRACTOR.
- ELECTRICAL ENGINEERING AND ROUTING SHALL BE DESIGN-BUILD BY CONTRACTOR.
- CONTRACTOR SHALL VISIT THE SITE TO INSPECT AND VERIFY THE EXTENT OF DEMOLITIONS, EXISTING CONNECTION POINTS FOR ELECTRICAL POWER AND IRRIGATION, AND EXISTING SITE CONDITIONS.
- CONTRACTOR SHALL FIELD STAKE ALL SITE IMPROVEMENTS AND RECEIVE OWNER OR LANDSCAPE ARCHITECT APPROVAL OF STAKED LOCATION PRIOR TO START OF INSTALL.
- ALL DIMENSION SHALL BE FIELD VERIFIED BY CONTRACTOR PRIOR TO CONSTRUCTION. ANY DEVIATION FROM THESE PLAN MUST BE APPROVED BY OWNER OR LANDSCAPE ARCHITECT PRIOR TO CONSTRUCTION.

project

La Pine Entry Monument
Sign & Flag Poles
La Pine, OR

date

2018.03.20

sla project number

1635

agency project number

sheet description

CONSTRUCTION PLAN

sheet number

LC101

project phase

ISSUE FOR BID

- NOTES:
1. ESTABLISHMENT DATE SIGN FONT STYLE SHALL BE CENTAUR (5 1/2" HT) OR AS APPROVED BY OWNER
 2. FONT TREATMENT: SANDBLAST 3/32" - 1/8" DEPTH w/ DARK GRAY SHADOW PAINT
 3. CONTRACTOR SHALL SUBMIT SIGN SHOP DRAWINGS FOR APPROVAL PRIOR TO FABRICATION

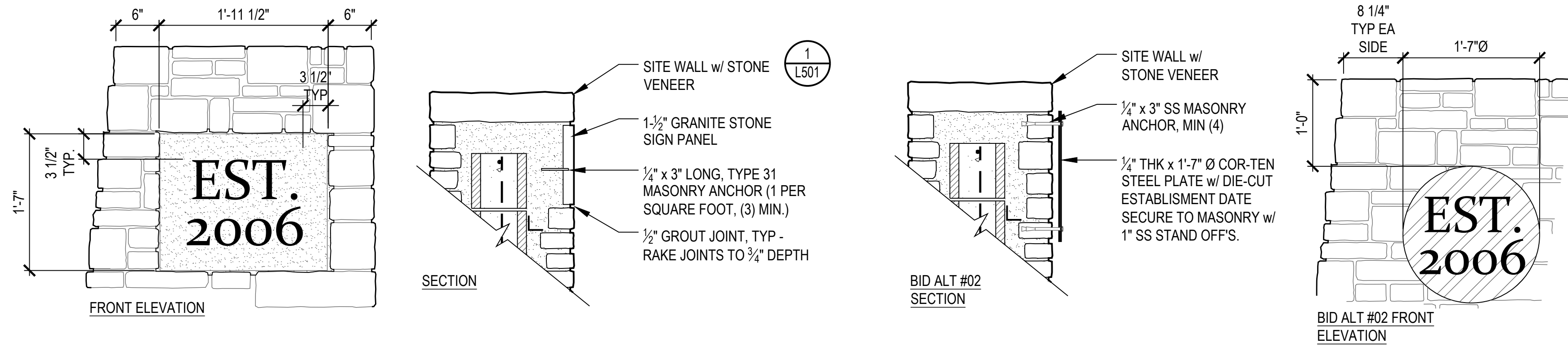

- NOTES:
1. BASE BID STONE CAP SHALL BE GRAY / BROWN CULTURED FLAT TEXTURED CAPSTONE TO MATCH EXISTING CITY HALL STONE, CONTRACTOR TO PROVIDE SAMPLE FOR REVIEW AND APPROVAL PRIOR TO ORDERING AND INSTALL.
 2. BASE BID STONE VENEER SHALL BE GRAY / BROWN CULTURED STONE VENEER TO MATCH EXISTING CITY HALL STONE, CONTRACTOR TO PROVIDE SAMPLE FOR REVIEW AND APPROVAL PRIOR TO ORDERING AND INSTALL.
 3. CONTRACTOR SHALL PROVIDE BID ALTERNATE #04 FOR STONE CAP: PANGEA WEST COAST WALL CAP 12" w/ NATURAL FINISH EDGES (AVAIL. FROM WILLAMETTE GRAYSTONE) OR APPROVED EQUAL.
 4. CONTRACTOR SHALL PROVIDE BID ALTERNATE #04 FOR STONE VENEER: PANGEA WEST COAST LEDGESTONE w/ BLENDED JUMPERS (AVAIL. FROM WILLAMETTE GRAYSTONE) OR APPROVED EQUAL.

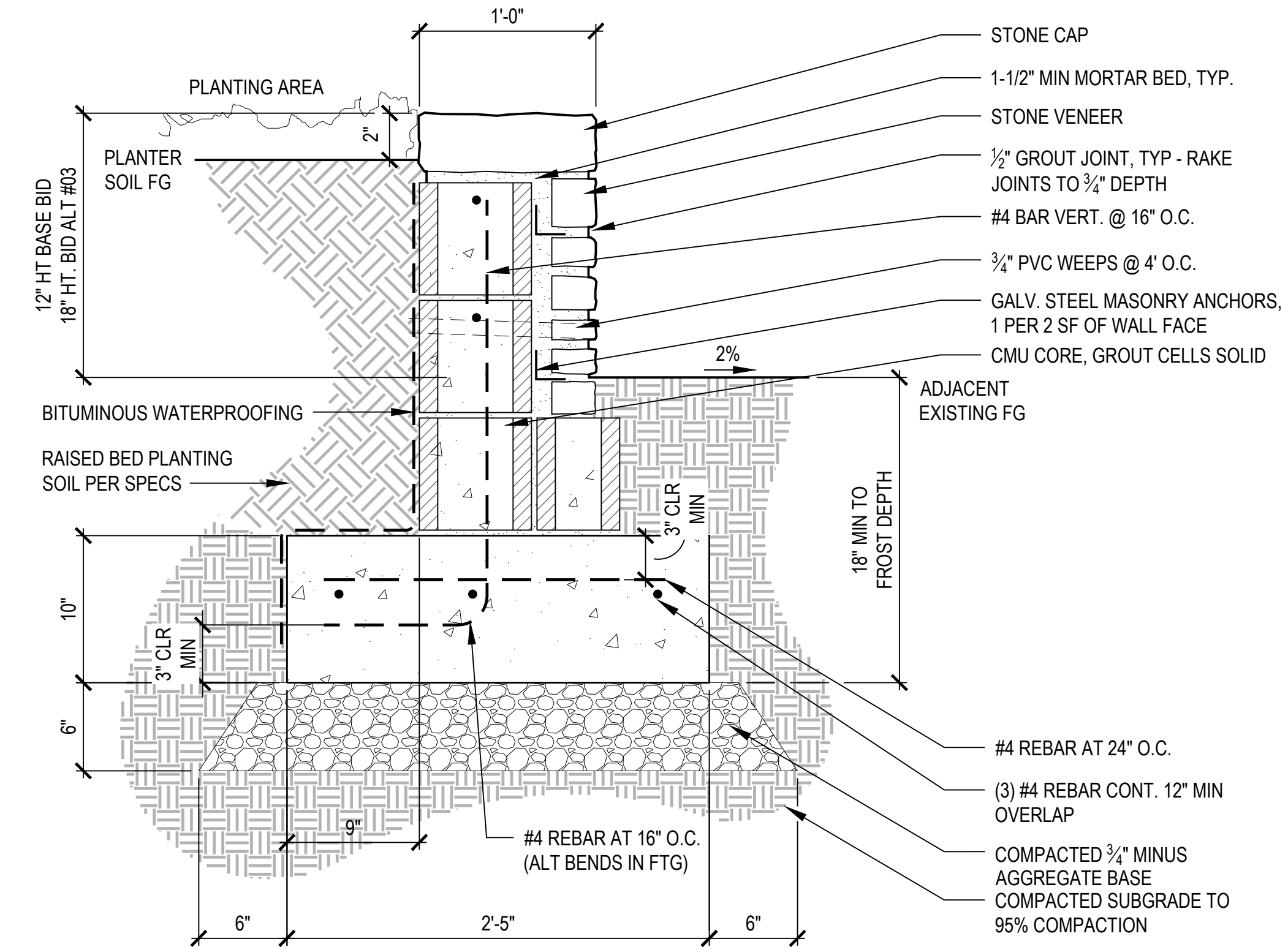

1 SITE WALL w/ STONE VENEER

SCALE: 1 1/2" = 1'-0"

- NOTES:
1. CONTRACTOR SHALL PROVIDE STRUCTURALLY ENGINEERED SHOP DRAWINGS FOR REVIEW AND APPROVAL PRIOR TO COMMENCEMENT OF WORK
 2. CONTRACTOR SHALL PROVIDE DETAILED SHOP DRAWINGS FROM SIGNAGE COMPANY FOR SIGN FABRICATION PRIOR TO COMMENCEMENT OF WORK.
 3. CITY LOGO, FONT, AND QUOTE FONT SHALL BE PROVIDED BY THE CITY AND IN ACCORDANCE WITH CITY OF LA PINE BRANDING STANDARDS.
 4. BASE BID STONE CAP SHALL BE GRAY / BROWN CULTURED FLAT TEXTURED CAPSTONE TO MATCH EXISTING CITY HALL STONE, CONTRACTOR TO PROVIDE SAMPLE FOR REVIEW AND APPROVAL PRIOR TO ORDERING AND INSTALL.
 5. BASE BID STONE VENEER SHALL BE GRAY / BROWN CULTURED STONE VENEER TO MATCH EXISTING CITY HALL STONE, CONTRACTOR TO PROVIDE SAMPLE FOR REVIEW AND APPROVAL PRIOR TO ORDERING AND INSTALL.
 6. CONTRACTOR SHALL PROVIDE BID ALTERNATE #04 FOR STONE CAP: PANGEA WEST COAST WALL CAP 12" w/ NATURAL FINISH EDGES (AVAIL. FROM WILLAMETTE GRAYSTONE) OR APPROVED EQUAL.
 7. CONTRACTOR SHALL PROVIDE BID ALTERNATE #04 FOR STONE VENEER: PANGEA WEST COAST LEDGESTONE w/ BLENDED JUMPERS (AVAIL. FROM WILLAMETTE GRAYSTONE) OR APPROVED EQUAL.
 8. COR-TEN STEEL SHALL BE PRE-WEATHERED PRIOR TO INSTALLATION.

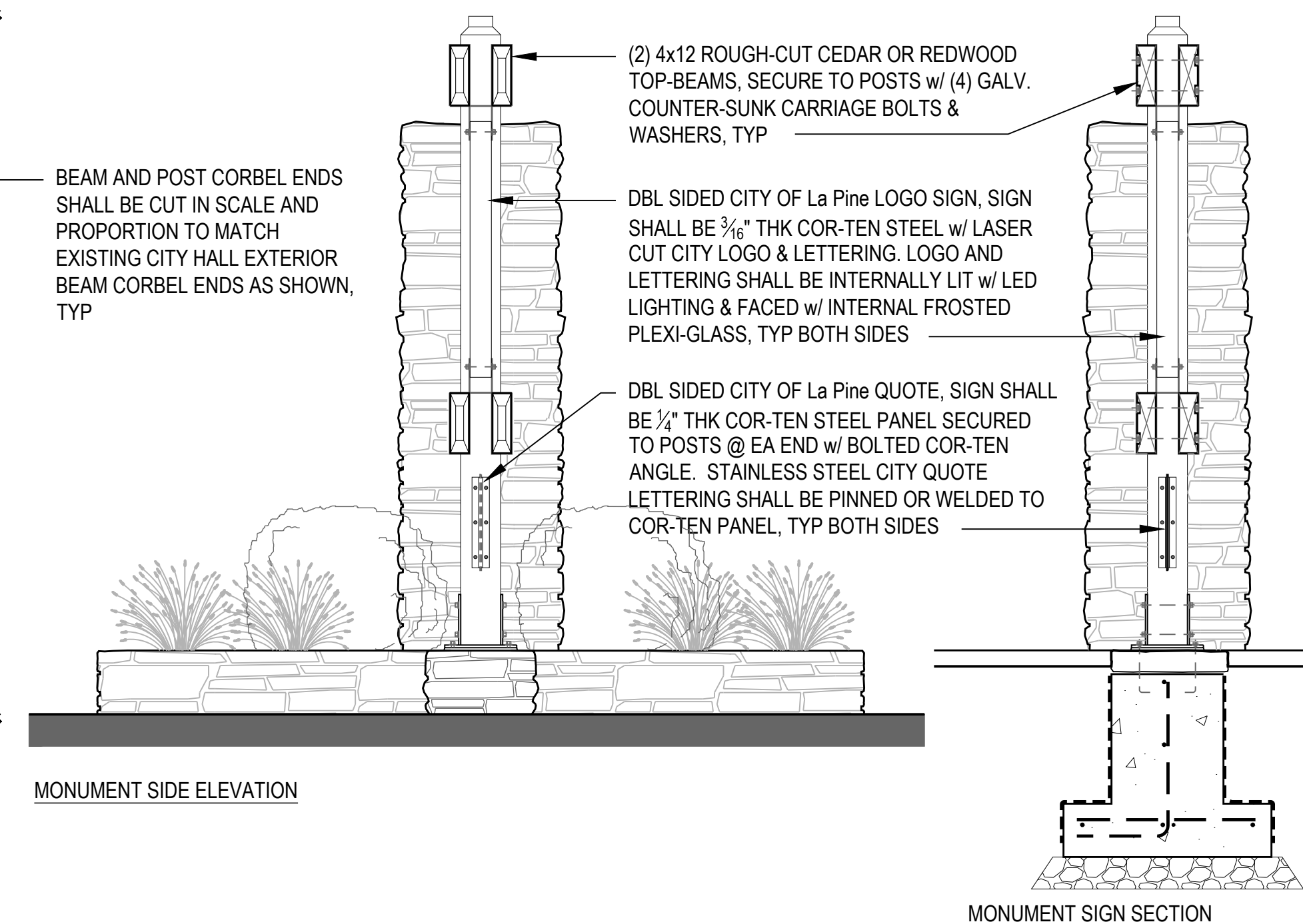

3 EST. DATE STONE SIGNAGE

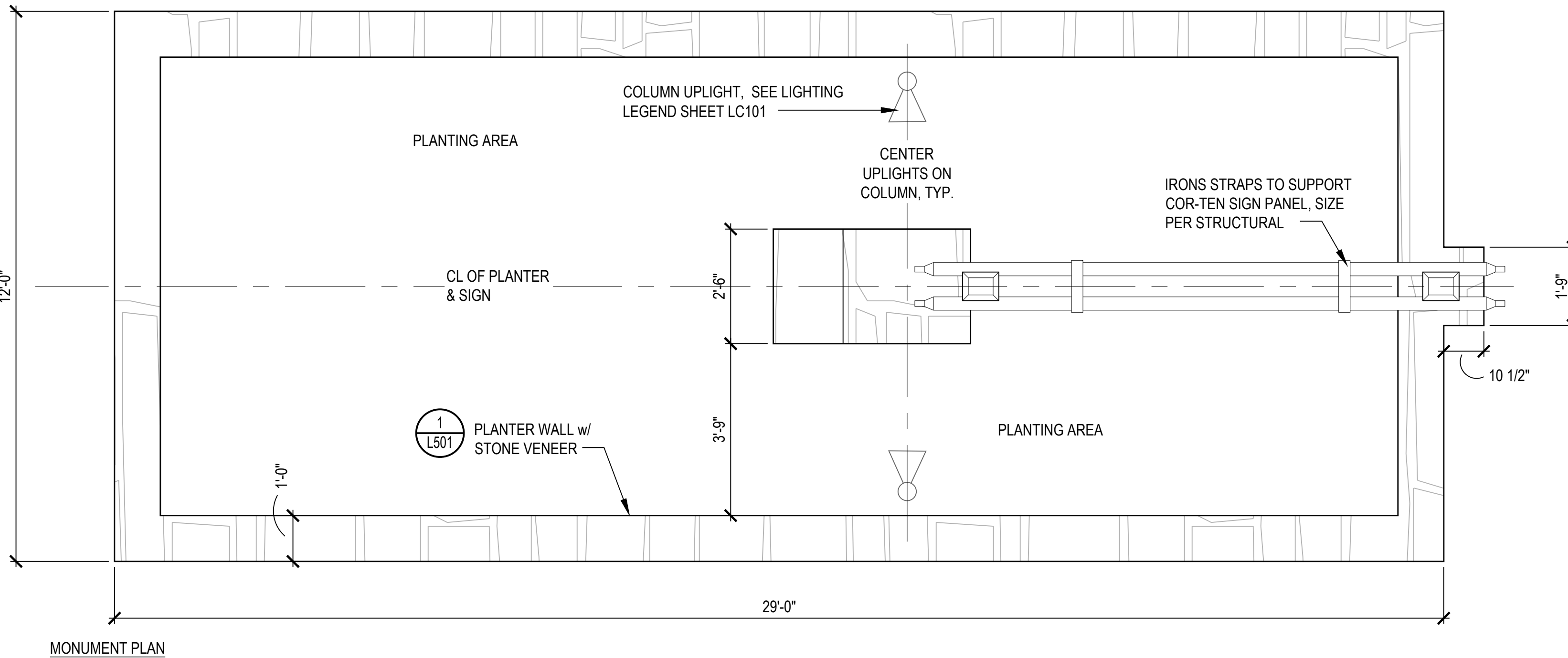

SCALE: 1" = 1'-0"

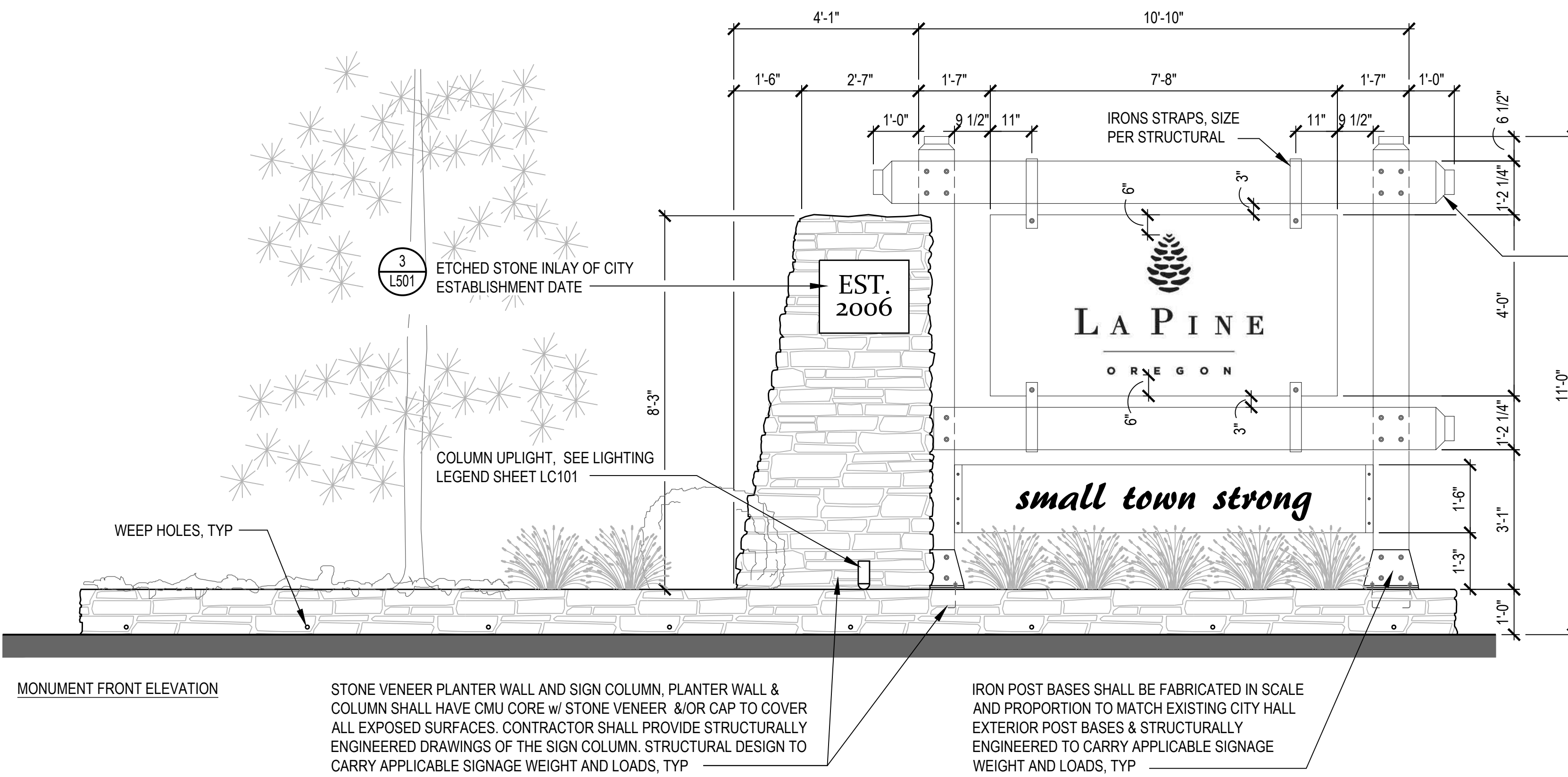

2 ENTRY MONUMENT SIGN

SZABO

LANDSCAPE ARCHITECTURE

1000 NW WALL ST., STE 250 | BEND, OR 97703
541.382.2059 | WWW.SZABO-LA.COM

landscape architect's seal



consultant

revision schedule

no.	date	description
-----	------	-------------

project

La Pine Entry Monument Sign & Flag Poles
La Pine, OR

date

2018.03.20

sla project number

1635

agency project number

sheet description

SITE CONSTRUCTION DETAILS

sheet number

LC501

project phase

ISSUE FOR BID

landscape architect's seal

consultant

revision schedule

no.	date	description

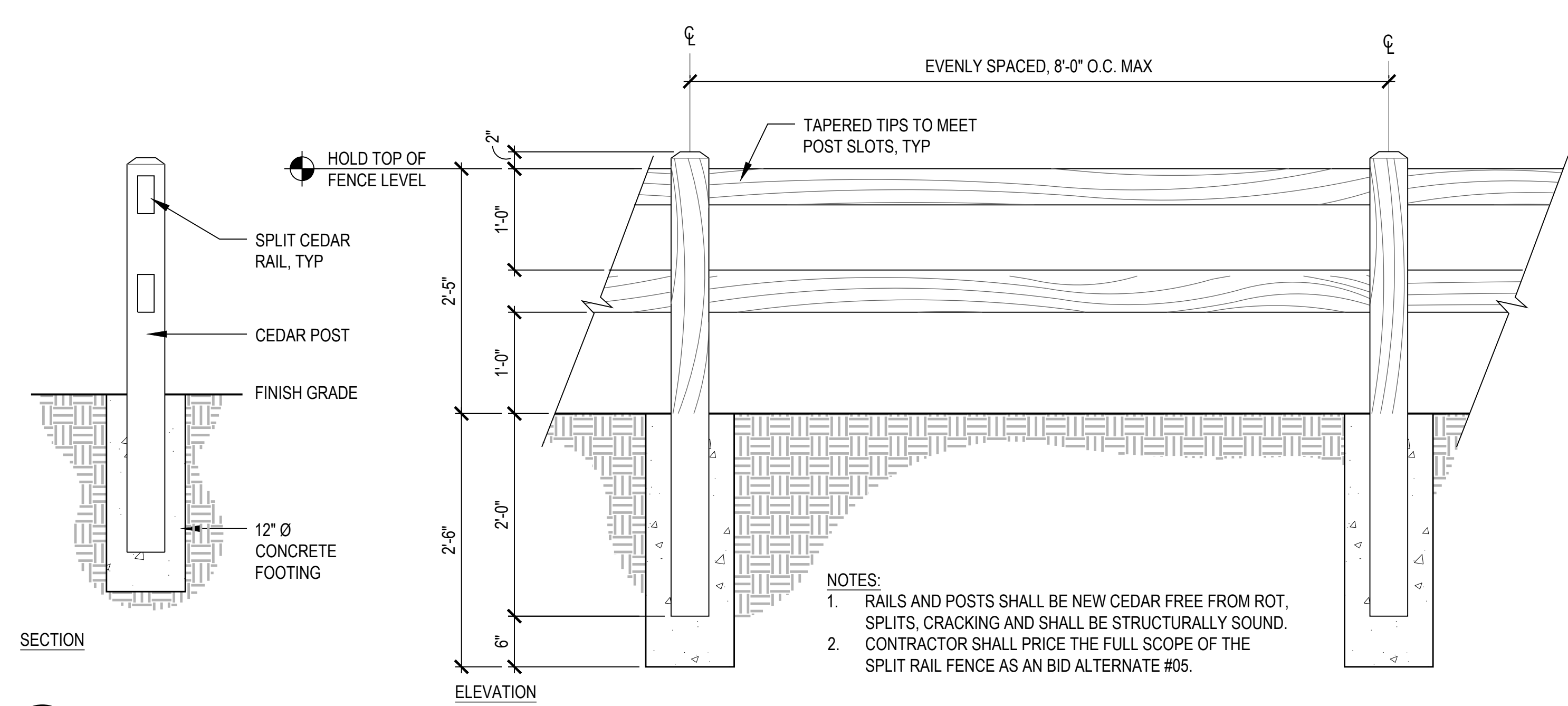

3 2-RAIL SPLIT CEDAR FENCE

SCALE: 1"= 1'-0"

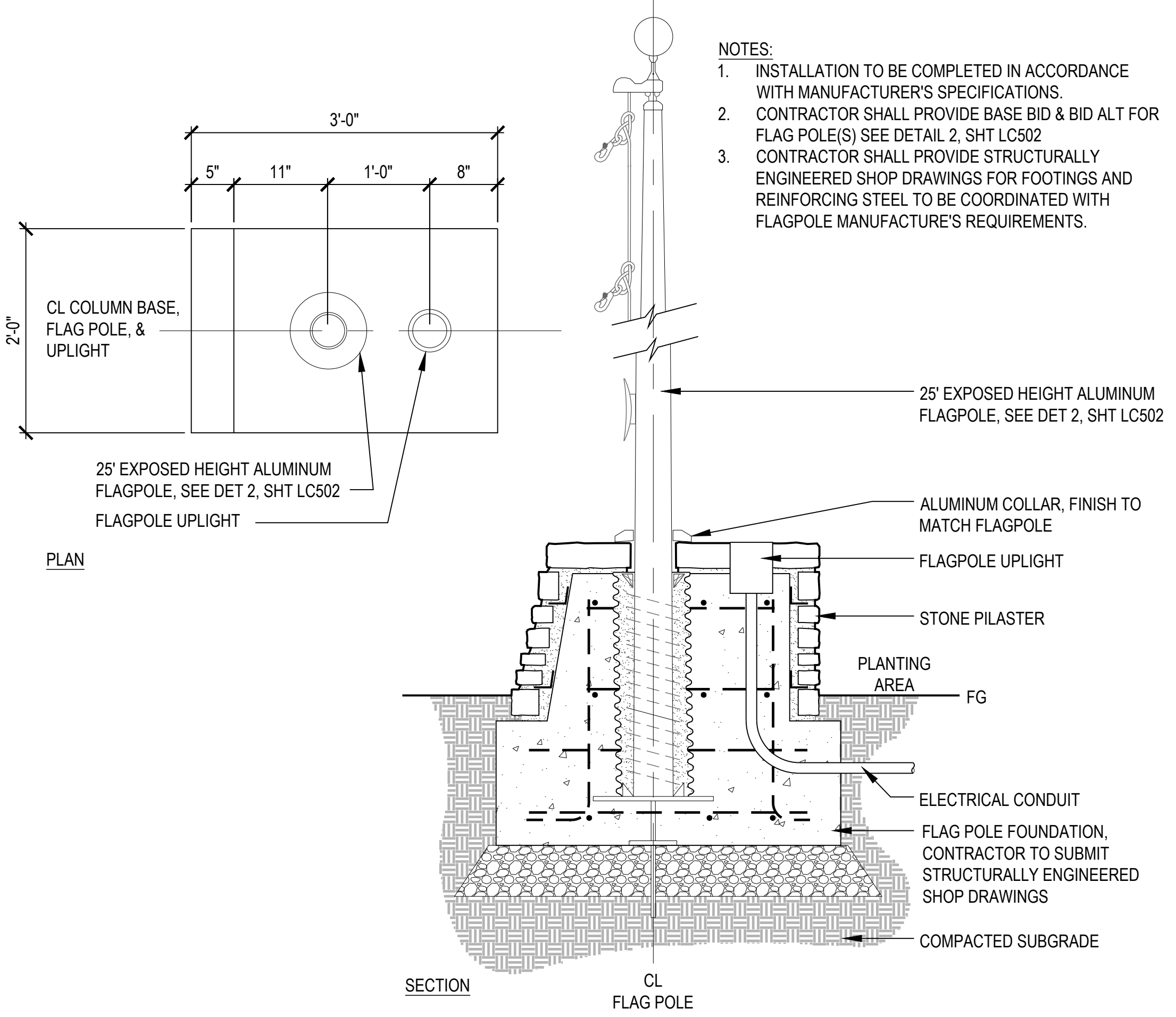

1 FLAGPOLE w/ STONE VENEER PILASTER BASE

SCALE: 1"= 1'-0"

F1-COLUMN UP-LIGHT

- FC FLOOD LIGHT CATALOG # FC1103-UNV-4K-BK-ASY-AS
- INSTALL PER MANUF'S RECOMMENDATIONS



SPECIFICATIONS					
PHYSICAL					
beam spread	10° 15° 25° 30° 40° 60° 10° x 40° 21° x 56° (Asymmetric) 30° x 60°				
lengths/dimensions (LxWxH)	3.75"W x 3.3"D x 5.7"H				
weight	2.8 lbs				
housing	marine grade, corrosion resistant, low copper, solid die-cast aluminum; captive stainless steel fasteners				
lens	anti-reflective-clear, tempered glass w/silicone gasketing - IK07 Impact Rating				
mounting	standard mounting is 1/2" - 14 NPS and includes adjustments for 145° vertical rotation and 360° horizontal rotation				
ingress protection	dry, damp or wet locations IP66 rated				
vibration resistance	compliant with 36 ANSI C136.31				
finish	UV stable polyester powder coat				
PERFORMANCE					
color temperature	2700K	3000K	3500K	4000K	5000K
lumen output	415 lm	420 lm	435 lm	455 lm	525 lm
lifetime	> 70,000 hours / L90 or better				
color consistency	Step 2 McAdams Ellipse / CRI > 84; optional 90+ CRI				
temperature	operating: -13°F to 104°F (-25°C to 40°C) start-up: -13°F to 104°F (-25°C to 40°C) storage: -40°F to 176°F (-40°C to 80°C)				
junction temperature	73°C @ T₂₅C				
warranty	5 year limited warranty (refer to website for details)				
ELECTRICAL					
input voltage	Universal 120-277V AC				
power supply	Integral Class II, electronic high-power factor > 94%				
certification	CEC Title 24 - JAB Compliant				
standards	ETL / cETL or CE, tested to UL 1598 and UL 8750 standards / UL-Class I / IES LM-79 / LM-80				
power consumption	6.7W @ 120V				
interface	0-10V Dimming (only available with optional remote driver)				

Expanded Disclaimer: Due to continuous development and improvements, specifications are subject to change without notice. Solid State Luminaires reserves the right to change bid test details or specifications without notice. Product use certifies agreement to Solid State Luminaires terms and conditions. FCF1103 Series Flood Lights are engineered and produced in our Brook manufacturing facility.

FC LIGHTING a US Commercial Lighting Manufacturer Since 1982

Specification Sheet
BB Rev. 03/09/2018

F2-FLAGPOLE UP-LIGHT

Uplighters **Arcluce**

INGROUND 180

PROJECT	La Pine Entry Monument & Flag Poles
TYPE	
CATALOG#	O-IG-6-2-1-4-US-30-S
NOTES	INSTALL PER MANUF REC'S

TECHNICAL INFORMATION

Luminaire power: 14W

Source lumen: Up to 1550lm

LED: 3000K - 4000K, CRI>80

DESCRIPTION

Luminaire

- Die-cast aluminum body (EN 47100)
- AISI 316L stainless steel trim
- Double layer polyester powder paint resistant to corrosion and salt spray fog
- Silicone rubber gaskets
- AISI 316 stainless steel external screws
- PMMA lenses for LEDs
- Screen made of 13/32" thermal-shock resistant tempered glass
- 6600-11000lm static load capacity
- Can be driven over at maximum speed 12 mph.

Electrical

- Nominal LED efficacy up to 133lmens/Watt (4000K - 4000mA - CRI>80 - 110lm/cw)
- LED life time >50000h with LED
- High colour consistency <3SDCM
- Integral LED driver. Available with 0-10V dimming option.
- Driver protected against voltage spikes.

Installation

- Recessed installation.
- Include P63/35 cable gland for through wiring.
- Supplied with recessed installation box.
- Recessed installation box made of engineering plastic.

Fixtures can be supplied with anti-slip glass upon request.

Amber color LED on request.

TRIM TYPE

OPTICS

Arcluce North America Inc. 333 Bush Street - San Francisco, CA 94104 - Ph. +1 (408) 655-2675 - export@arcluce-us.com arcluce-us.com

Titan Series - IWW
Internal with Winch Wire Hayard Ground Set Installation

IWW25D61 - 02

Specifications

A. Mounting Height: 24"
B. Set Depth: 2'-6"
C. Total Length: 26'-6"
D. Taper Length: 13'-9"
E. Butt Diameter: 6.000"
F. Top Diameter: 3.500"
G. Wall Thickness: 0.168"

Notes

- CONTRACTOR SHALL PROVIDE BID ALTERNATE FOR MODEL # IWW25D 61-02
- INSTALL PER MANUF'S RECOMMENDATIONS

Architectural Elite Series - ESR
External Single Revolving Rope Hayard Ground Set Installation

ESR25C61 - 02

Specifications

A. Mounting Height: 24"
B. Set Depth: 2'-6"
C. Total Length: 26'-6"
D. Taper Length: 13'-9"
E. Butt Diameter: 6.000"
F. Top Diameter: 3.500"
G. Wall Thickness: 0.156"

Notes

- CONTRACTOR SHALL PROVIDE BASE BID FOR MODEL # ESR25C 61-02
- INSTALL PER MANUF'S RECOMMENDATIONS

4 SITE LIGHTING

2 25' HT FLAGPOLE

project
La Pine Entry Monument Sign & Flag Poles
La Pine, OR

date
2018.03.20

sla project number
1635

agency project number

sheet description
SITE CONSTRUCTION DETAILS

sheet number
LC502

project phase
ISSUE FOR BID

landscape architect's seal



consultant

revision schedule

no.	date	description

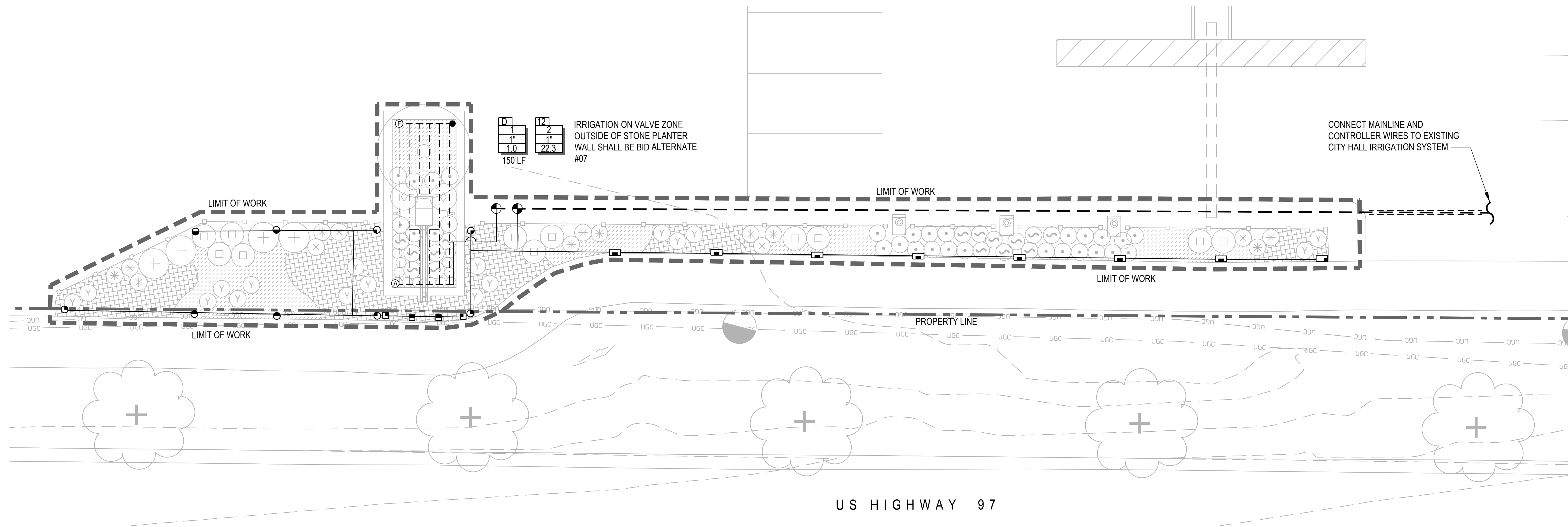

IRRIGATION NOTES

- IRRIGATION SYSTEM SHALL BE CONNECTED TO THE EXISTING IRRIGATION SYSTEM AT THE CITY OF LA PINE CITY HALL GROUNDS. CONTRACTOR SHALL VERIFY TWO (2) STATIONS ARE AVAILABLE ON THE EXISTING CONTROLLER. CONTACT PUBLIC WORKS MANAGER AT (541) 419-5625 FOR ANY QUESTION.
- MAINLINE AND RELATED EQUIPMENT SHOWN WITHIN PAVING FOR CLARITY ONLY. ACTUAL MAINLINE AND RELATED EQUIPMENT LOCATION TO BE WITHIN PLANTERS AND A MINIMUM OF 18" OFF ADJACENT HARDSCAPE AND OTHER OBSTACLES.
- CONTRACTOR SHALL ADJUST ALL HEADS AS REQUIRED TO ACCOMMODATE ANY VERTICAL OBSTRUCTIONS THAT MAY OCCUR, INCLUDING BUT NOT LIMITED TO LIGHT POLES, FIRE HYDRANTS, ETC.
- ELECTRICAL WIRING FOR REMOTE CONTROL VALVES NOT SHOWN ON PLANS, CONTRACTOR INSTALL WIRING FOR ALL VALVES AND USE PVC SLEEVING FOR WIRE RUNS UNDER CONCRETE OR HARDSCAPE.
- ALL SPRAY IRRIGATION TO ACHIEVE HEAD-TO-HEAD COVERAGE AND MINIMIZE OVER SPRAY. CONTRACTOR TO VERIFY IN FIELD AND MAKE NECESSARY ADJUSTMENTS.
- CONTRACTOR TO COORDINATE POWER TO IRRIGATION CONTROLLER WITH ELECTRICAL CONTRACTOR.

BID ALTERNATES

BID ALTERNATE WORK (THIS SHEET) INCLUDES THE FOLLOWING:

- PROVIDE AND INSTALL IRRIGATION FOR AREA OUTSIDE OF STONE PLANTER WALL, BETWEEN SPLIT RAIL FENCE AND BACK OF EXISTING CONCRETE SIDEWALK.

IRRIGATION LEGEND

SYMBOL	MFR.	MODEL # / DESCRIPTION	GPM	PSI	RADIUS	P.R.	DETAIL
	RAINBIRD	1812-PRS-15-VAN 12" POP-UP SPRAY	3.7 1.9 0.9	30	15'	1.6	1 / LI 501
	RAINBIRD	1812-PRS-4-VAN 12" POP-UP SPRAY	0.9 0.45 0.3	30	4'	5.8	1 / LI 501
	RAINBIRD	1812-PRS-15XXX CORNER/SIDESTRIP	LCS SST RCS 0.5 1.2 0.5	30	4x15/30	NA	1 / LI 501
	RAINBIRD	XFS-06-12-200 DRIP TUBING WITH .61 GPH INLINE EMITTERS AT 12" O.C. SPACING. INSTALL TUBING IN SHRUB AND GROUND COVER AREAS 2" BELOW FINISH GRADE AT A MAXIMUM SPACING OF 18" O.C. INSTALL THE ROW ADJACENT TO HARDSCAPE 4" FROM THE EDGE OF HARDSCAPE. INSTALL 9" GALVANIZED STEEL JUST WIRE STAPLES AT A MAXIMUM OF 5' O.C. ALONG THE LENGTH OF THE DRIPLINE.					2,3 / LI501
	RAINBIRD	XQF-75-18-100 DRIPLINE HEADER					2,3 / LI501
	RAINBIRD	ARV050 AIR/VACUUM RELIEF VALVE. INSTALL IN 7" ROUND VALVE BOX.					5 / LI501
	HUNTER	PLD-BV 17MM BARBxBARB SHUT-OFF VALVE USED AS A FLUSH VALVE. INSTALL AT THE END OF EACH DRIP SYSTEM AS SHOWN. INSTALL IN 7" ROUND VALVE BOX WITH 1 CU. FT. CRUSHED GRAVEL SUMP BELOW.					4 / LI501
	RAINBIRD	OPERIND DRIP SYSTEM OPERATION INDICATOR					6 / LI501
	LASCO	1" SCH. 40 PVC PRESSURIZED MAINLINE					8,9 / LI501
	LASCO	1" SCH. 40 PVC NON-PRESSURE LATERAL					8,9 / LI501
	LASCO	3" PVC SCH. 40 SLEEVING - PLACE UNDER FUTURE HARDSCAPE OR ASPHALT AREAS, EXTEND 12" BEYOND PAVING EDGES.					8 / LI501
	RAINBIRD	XCZ-075-PRF LOW FLOW VALVE WITH 3/4" PR RBY FILTER INSTALLED IN RECTANGULAR VALVE BOX.					7 / LI501
	RAINBIRD	100-PEB-PRS-D REMOTE CONTROL VALVE WITH ADJUSTABLE PRESSURE REGULATOR INSTALLED IN RECTANGULAR VALVE BOX.					1 / LI502

VALVE KEY

	BODY HEIGHT	6 = 6" POP-UP
	STA NO	12 = 12" POP-UP
	VALVE SIZE	B = 4" POP-UP
	GPM	D = DRIP LINE
900 L.F.	L.F. OF DRIP LINE ±	

BODY HEIGHT

6 = 6" POP-UP
12 = 12" POP-UP
B = 4" POP-UP
D = DRIP LINE

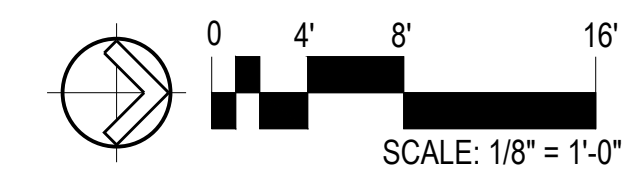

project

La Pine Entry Monument
Sign & Flag Poles
La Pine, OR

date

2018.03.20

sla project number

1635

agency project number

sheet description

IRRIGATION PLAN

sheet number

LI101

project phase

ISSUE FOR BID

landscape architect's seal

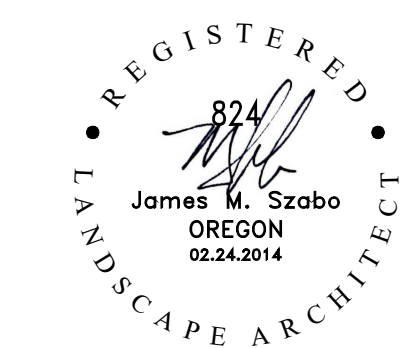

consultant

revision schedule

no.	date	description
-----	------	-------------

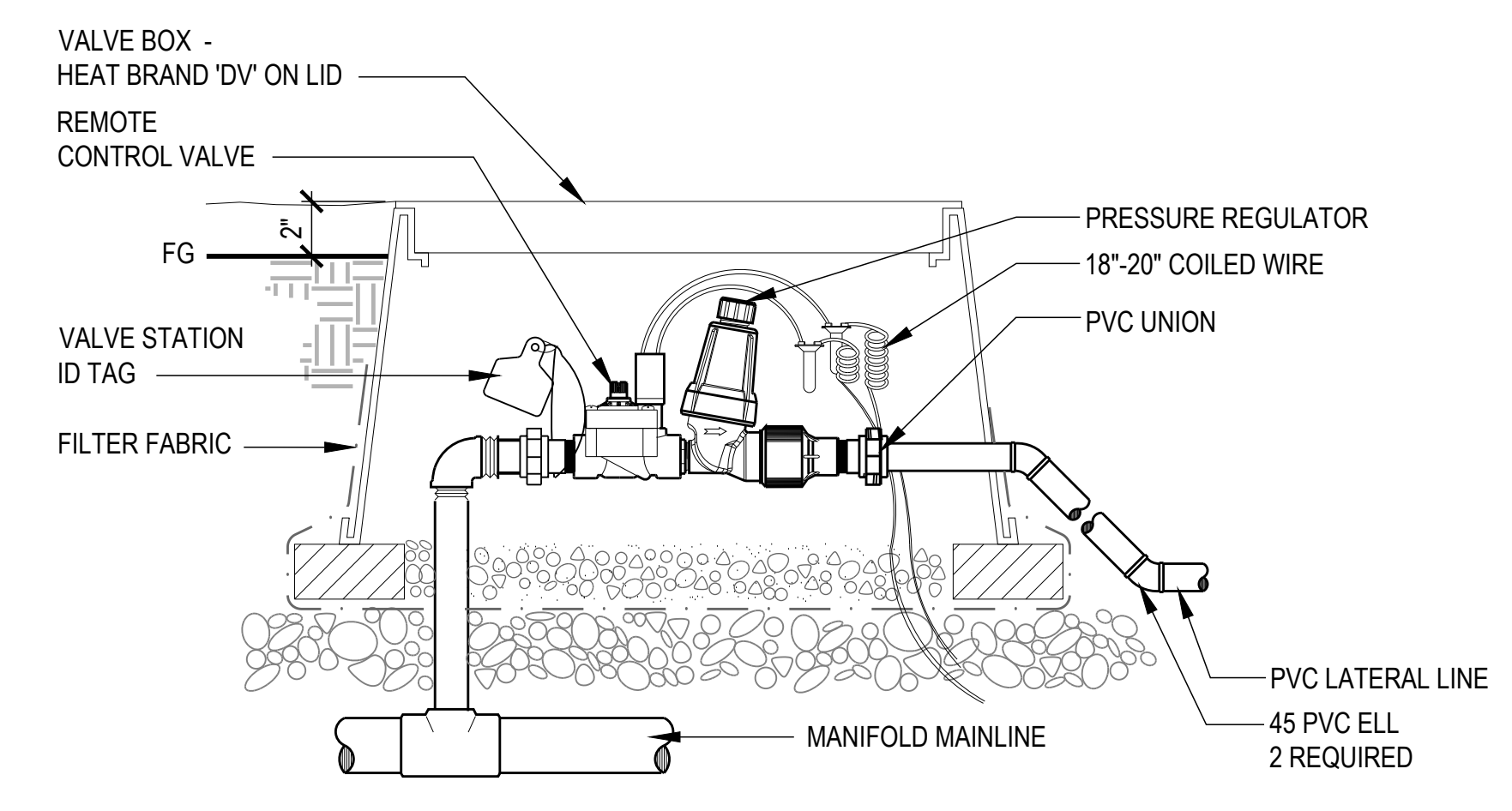

7 DRIP VALVE ASSEMBLY SCALE: NTS

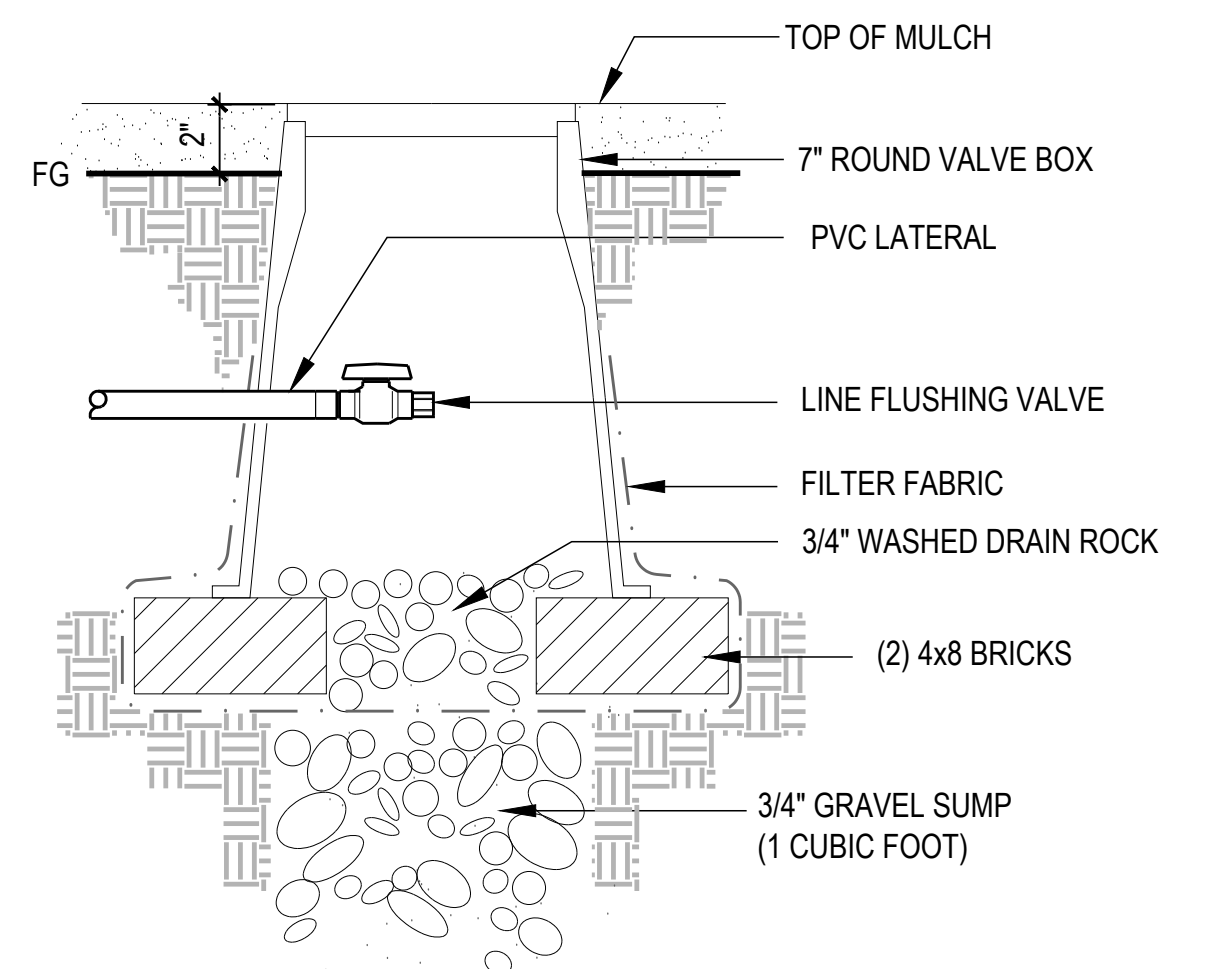

4 LINE FLUSHING VALVE SCALE: NTS

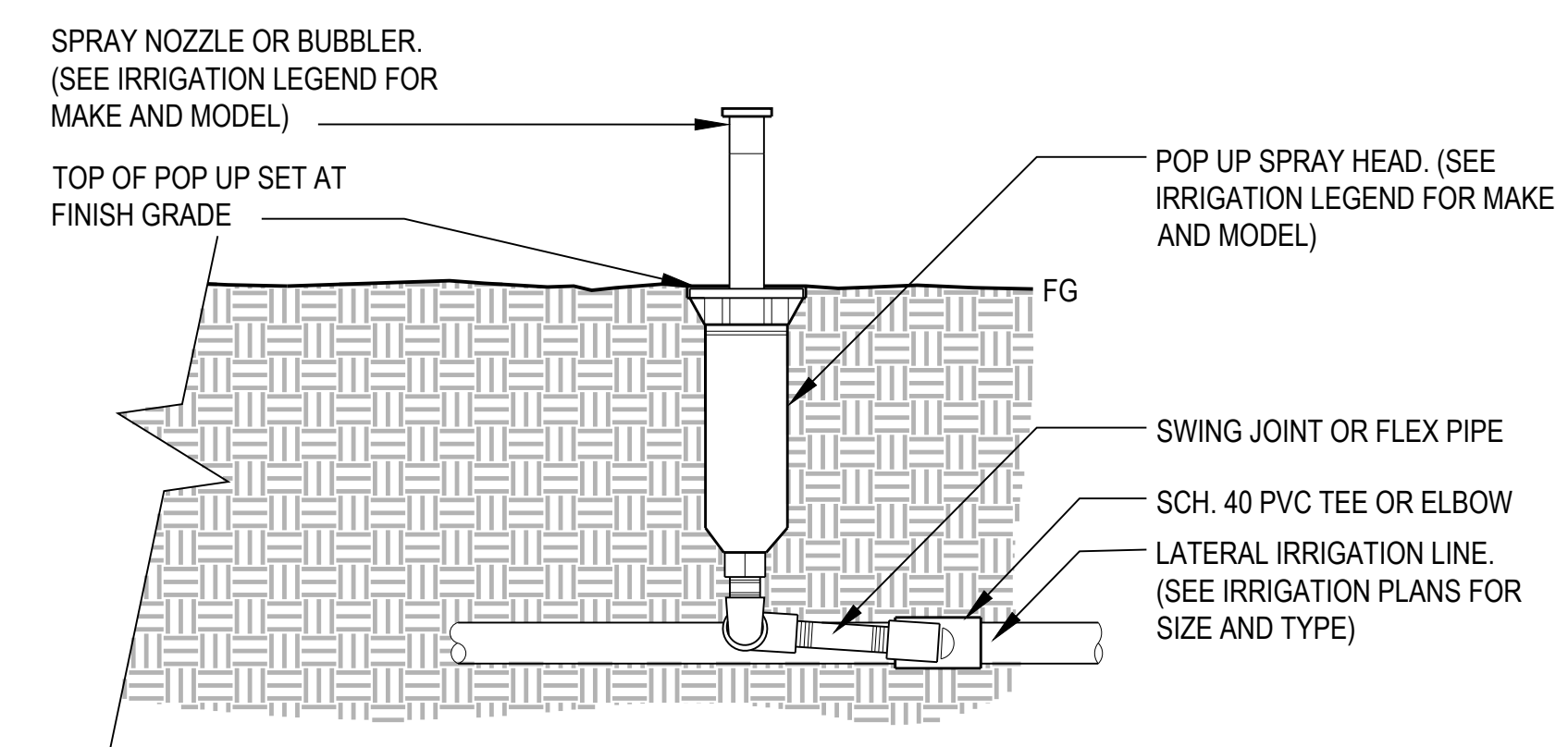

- NOTES:
- 6" POP UPS SHALL BE USED IN TURF AREAS, 12" POP UPS SHALL BE USED IN PLANTING BEDS.
 - CONTRACTOR SHALL SETTLE SOIL AROUND THE POP UP AFTER INSTALLATION.
 - ALL POP UP SPRAY HEADS SHALL HAVE CHECK VALVES.
 - ALL SCH. 40 PVC TO SCH. 80 PVC CONNECTIONS SHALL BE MADE USING TEFLON TAPE.

1 POP-UP SPRAY HEAD SCALE: 1 1/2" = 1'-0"

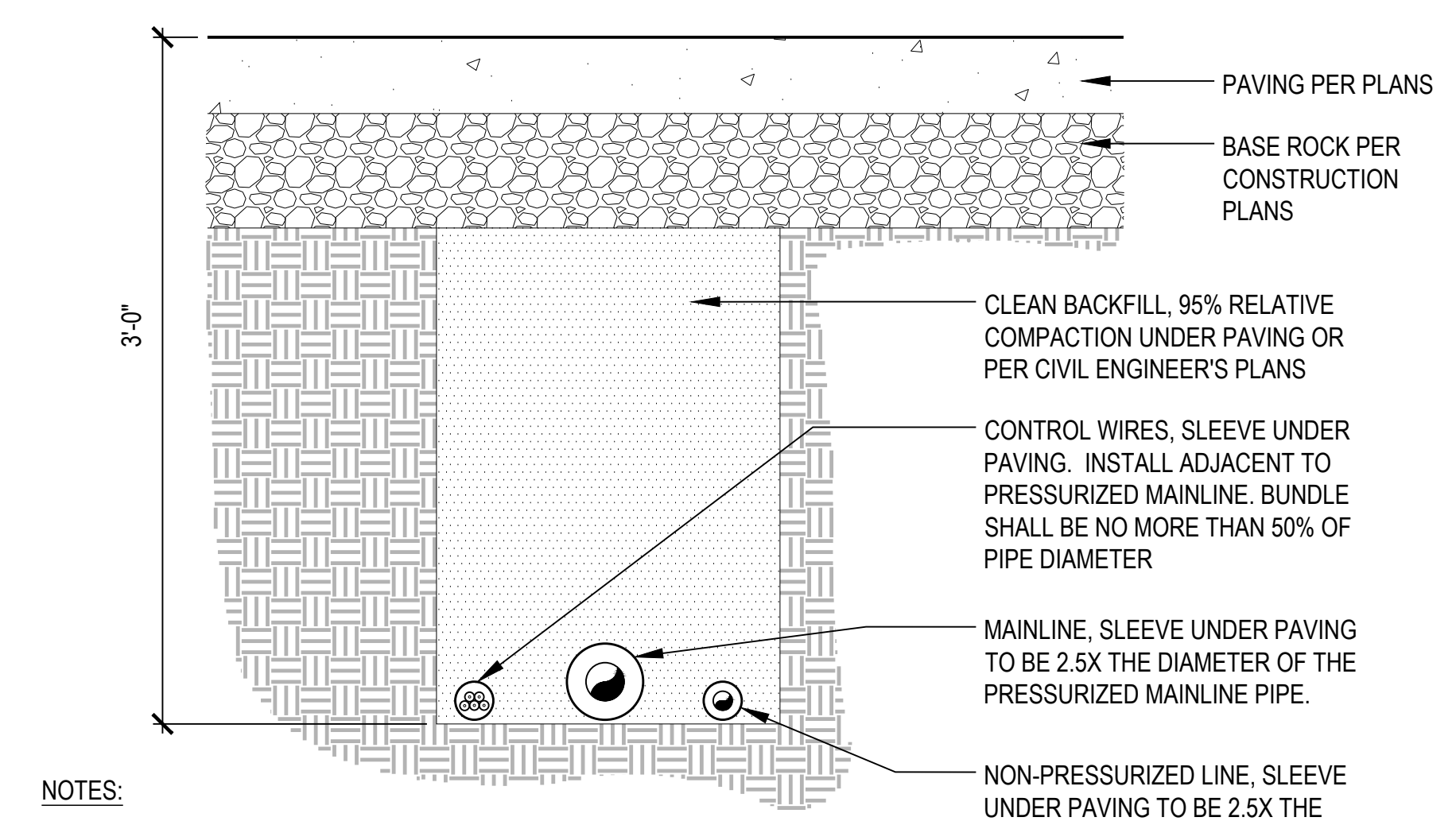

- NOTES:
- ALL SLEEVES SHALL EXTEND 12" BEYOND THE EDGE OF PAVEMENT.
 - END OF SLEEVES SHALL BE LOCATED WITH A PERMANENT PAVEMENT MARKING PIN, STANDARD BRASS SURVEY PIN IN LEAD, SET 1 INCH FROM EDGE OF PAVING OR CURB.

8 PIPE BENEATH PAVEMENT SCALE: 1 1/2" = 1'-0"

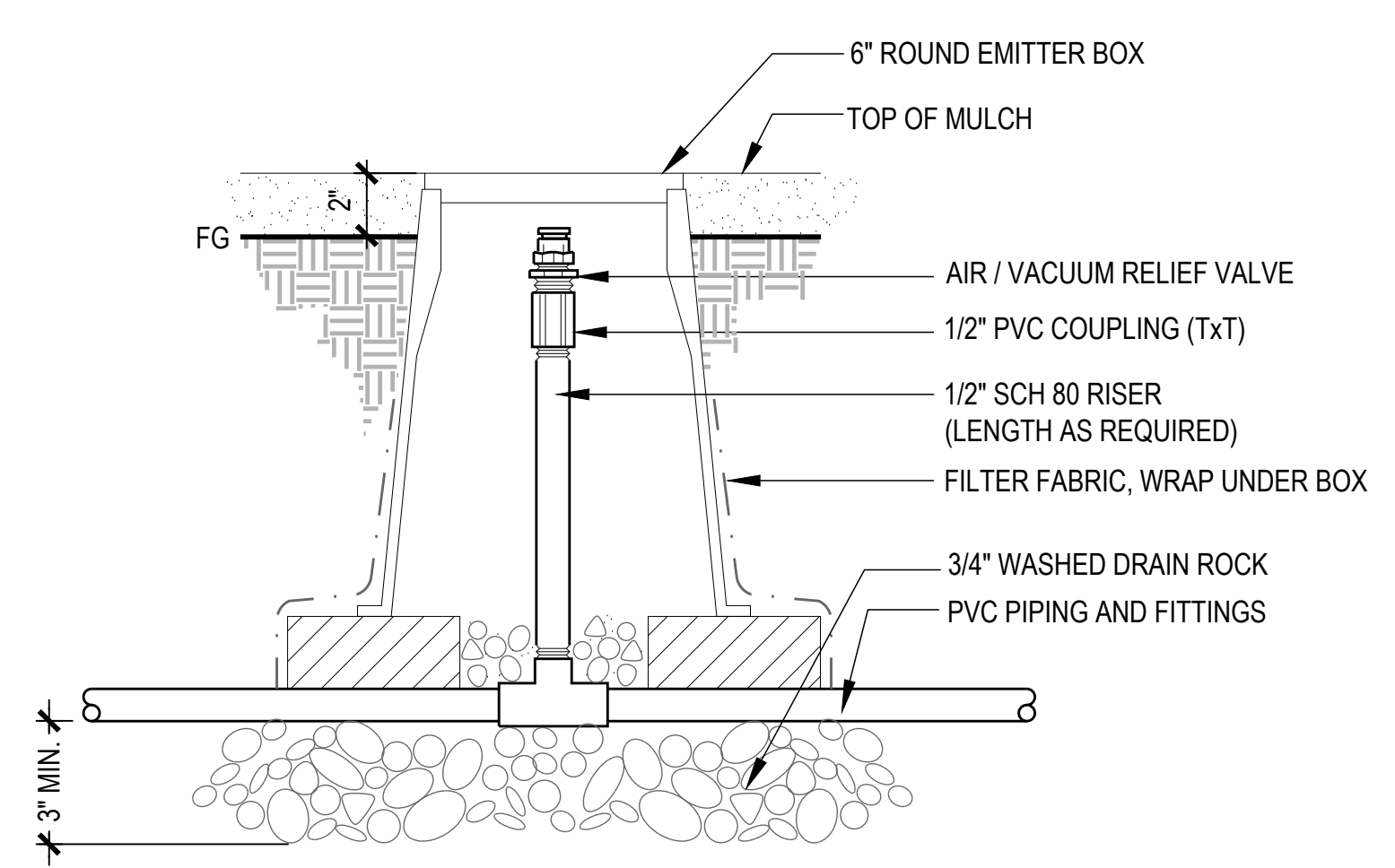

5 AIR RELIEF VALVE SCALE: NTS

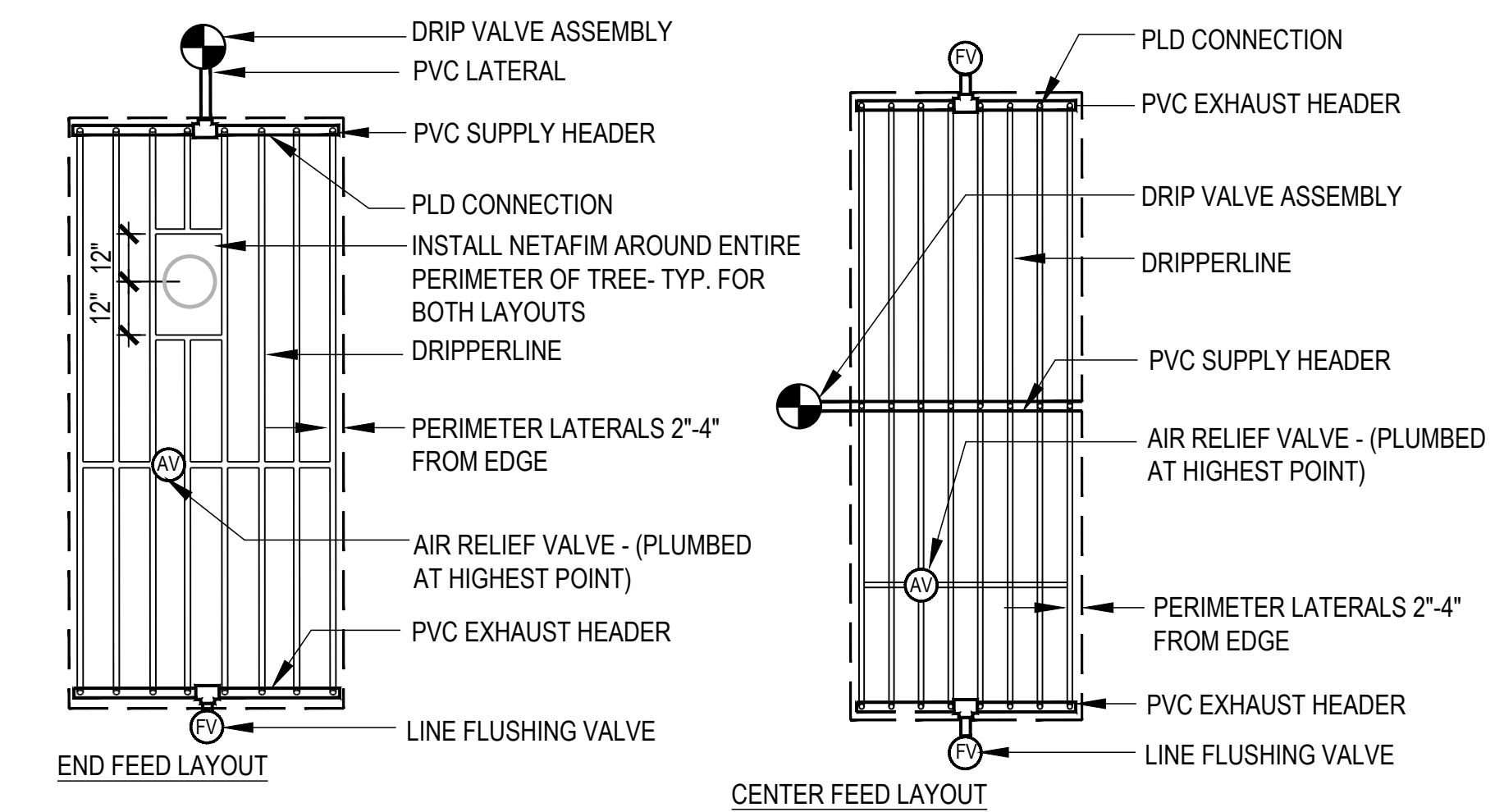

2 DRIPPERLINE TYPICAL LAYOUT SCALE: NTS

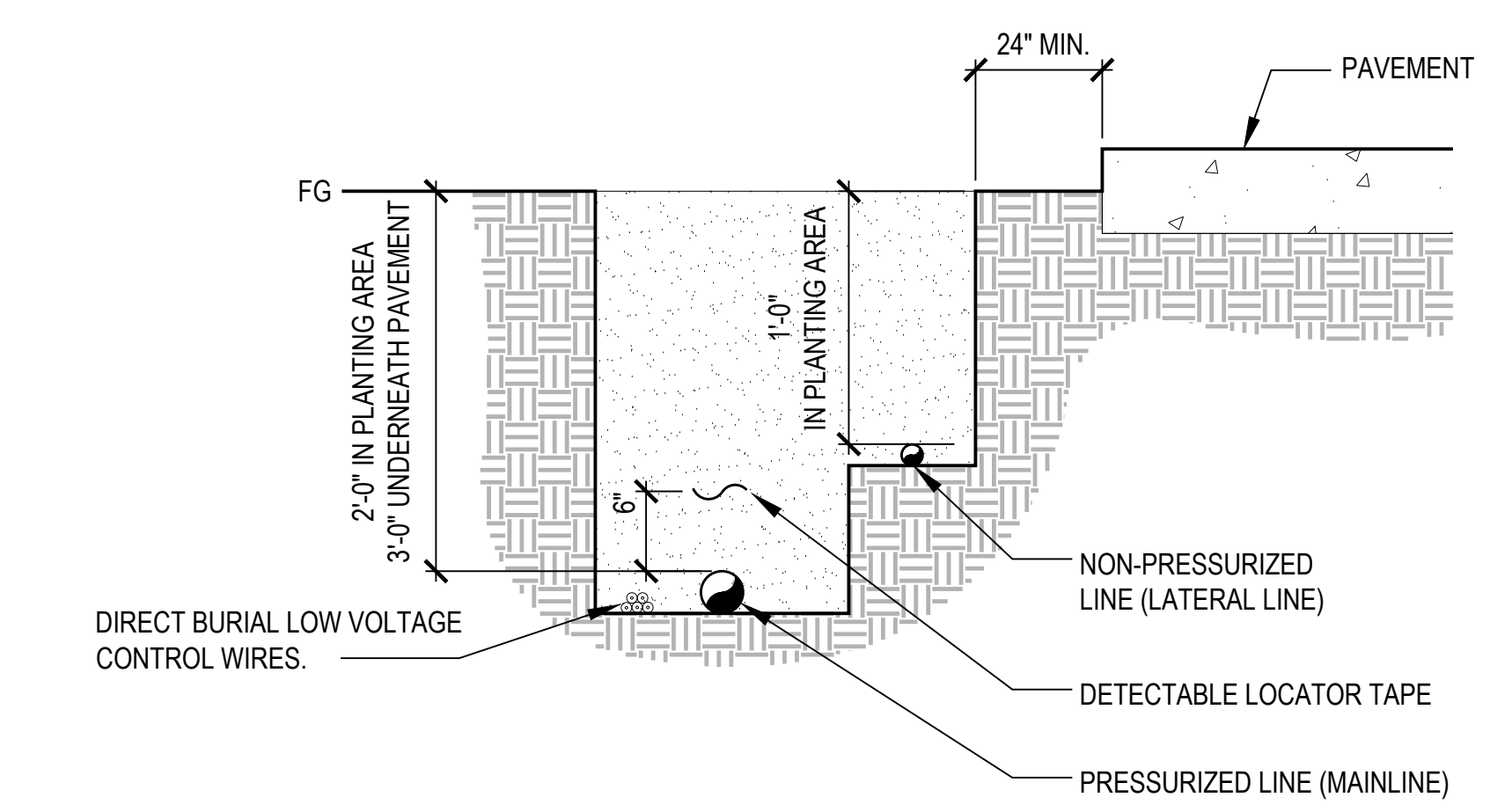

9 IRRIGATION TRENCHING SCALE: 1 1/2" = 1'-0"

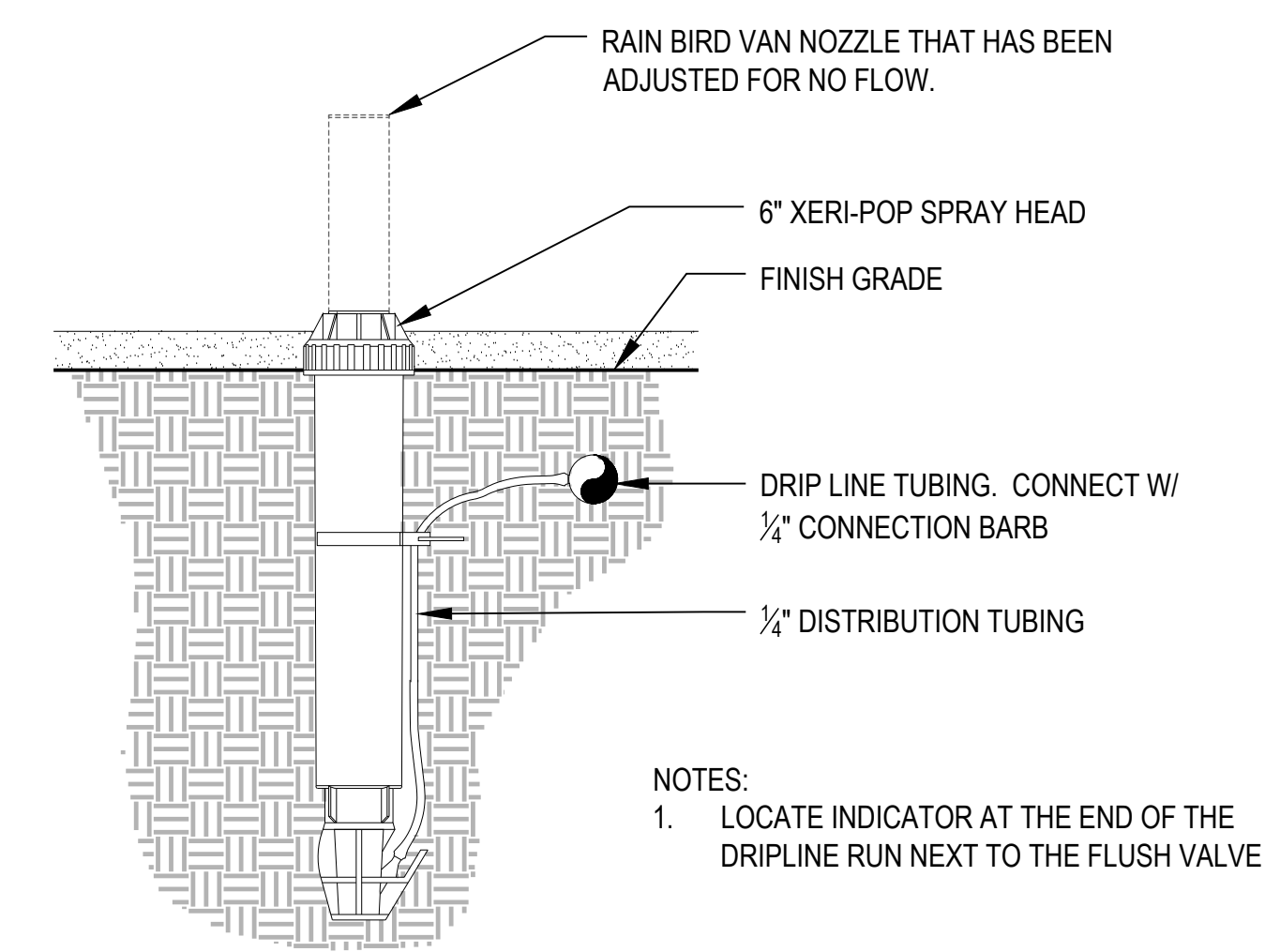

6 DRIP POP-UP INDICATOR SCALE: NTS

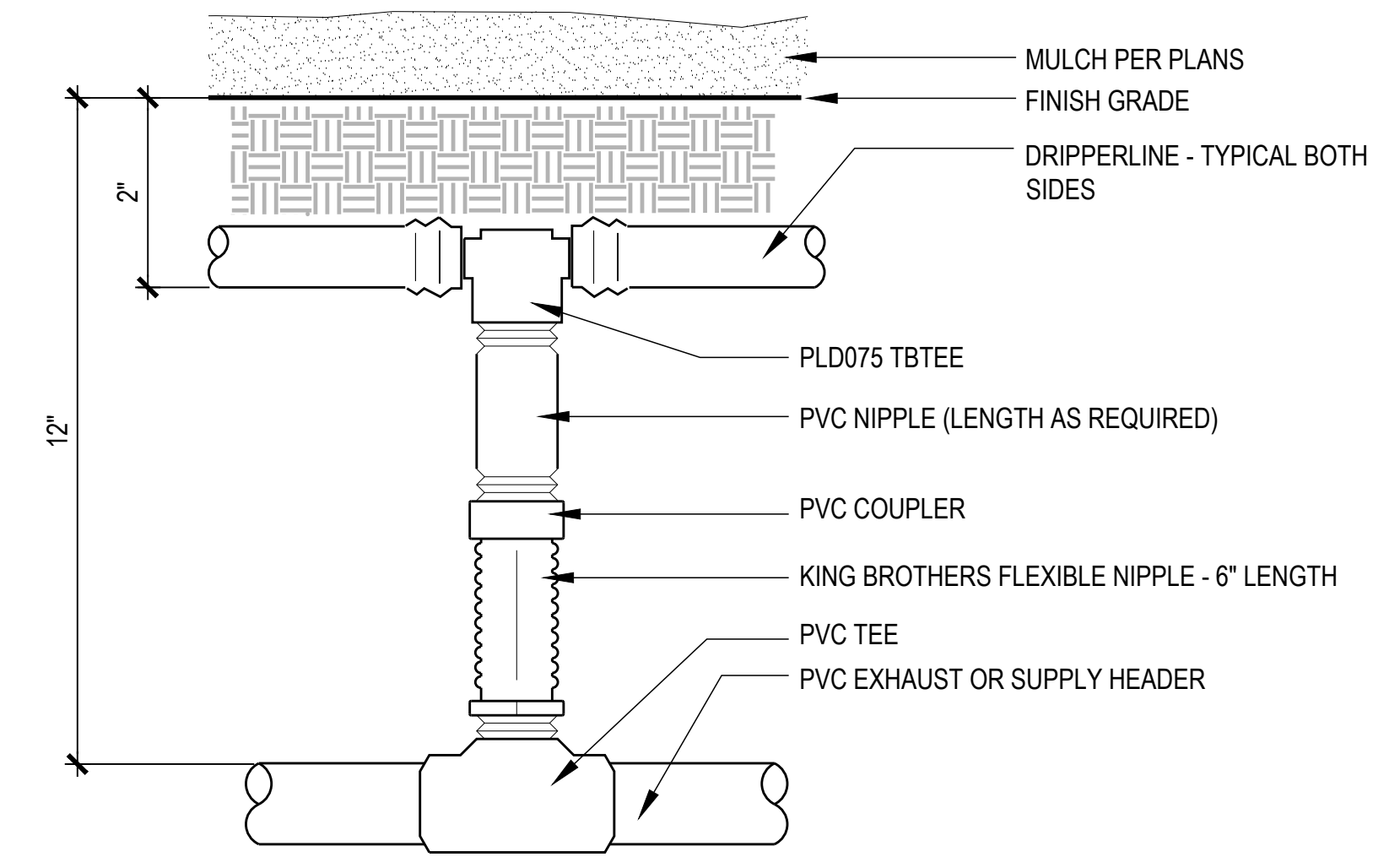

3 DRIPLINE INSTALLATION SCALE: NTS

project	La Pine Entry Monument Sign & Flag Poles La Pine, OR
date	2018.03.20
sla project number	1635
agency project number	
sheet description	IRRIGATION DETAILS
sheet number	LI 501
project phase	ISSUE FOR BID

SZABO

LANDSCAPE ARCHITECTURE

1000 NW WALL ST., STE 250 | BEND, OR 97703
541.382.2059 | WWW.SZABO-LA.COM

landscape architect's seal



consultant

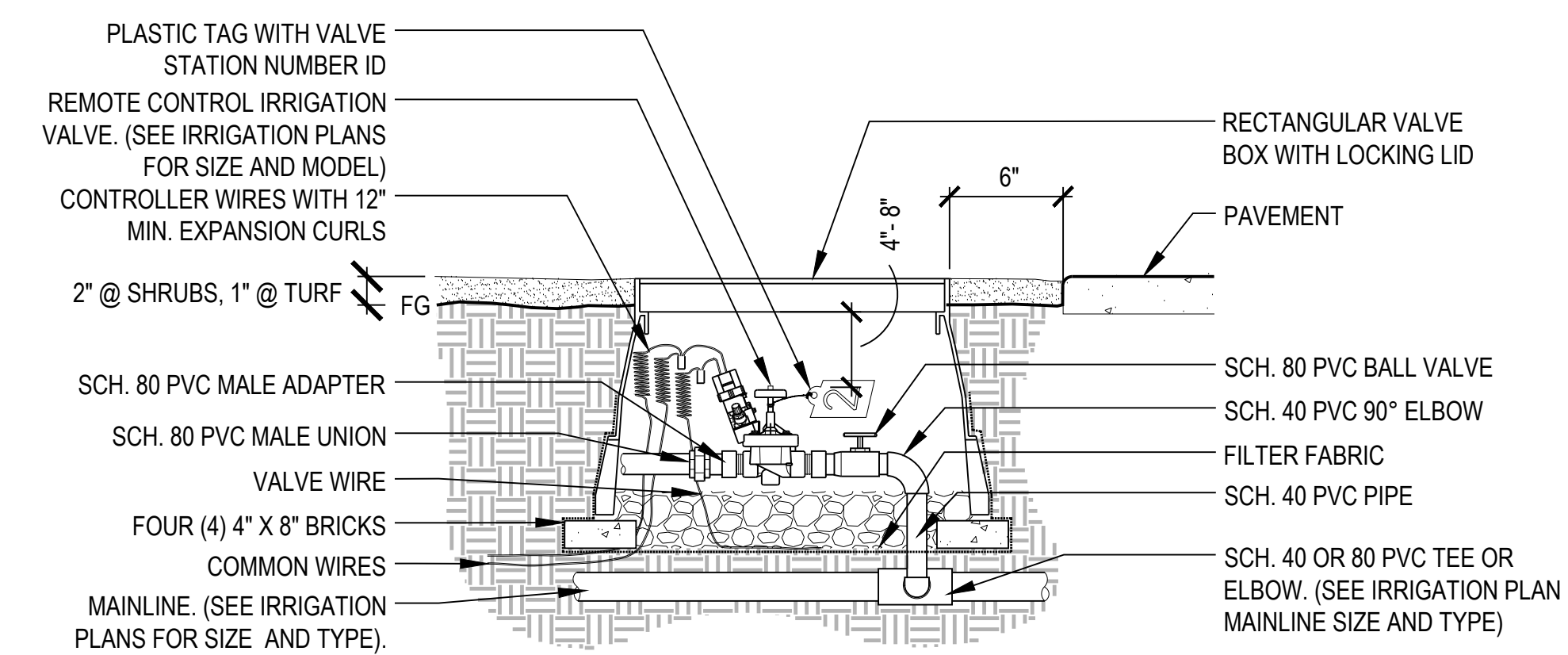

1 REMOTE CONTROL IRRIGATION VALVE SCALE: 1 1/2" = 1'-0"

revision schedule

no.	date	description
-----	------	-------------

project

**La Pine Entry Monument
Sign & Flag Poles**
La Pine, OR

date

2018.03.20

sla project number

1635

agency project number

sheet description

IRRIGATION DETAILS

sheet number

LI 502

project phase

ISSUE FOR BID

SZABO

LANDSCAPE ARCHITECTURE

1000 NW WALL ST., STE 250 | BEND, OR 97703
541.382.2059 | WWW.SZABO-LA.COM

landscape architect's seal



consultant

revision schedule

no.	date	description
-----	------	-------------

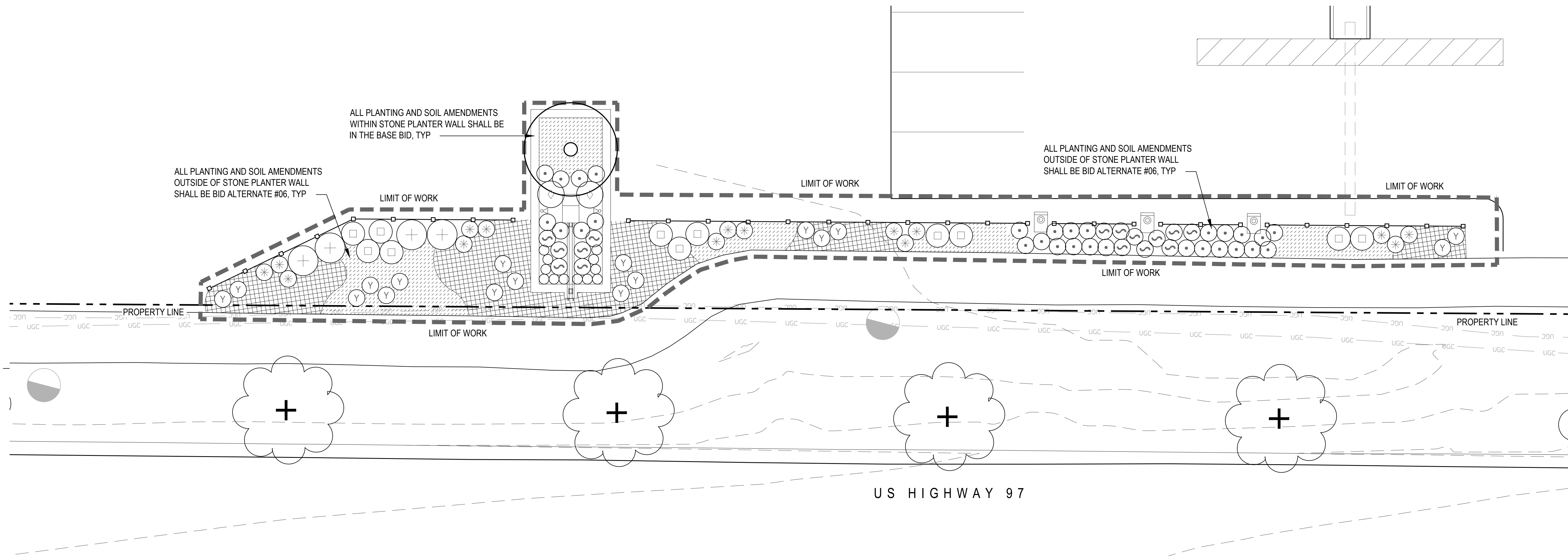

PLANTING NOTES

- CONTRACTOR SHALL OBTAIN A SOIL TEST ANALYSIS PER THE SPECIFICATION SECTION 32 91 13. SOIL TEST ANALYSIS RESULTS SHALL BE SUBMITTED TO THE LANDSCAPE ARCHITECT FOR REVIEW AND DETERMINATION OF FINAL SOIL AMENDMENTS. REFER TO SPECIFICATIONS FOR SOIL AMENDMENTS FOR BIDDING PURPOSES.
- REFER TO SPECIFICATIONS FOR SOIL PREPARATION AND PLANTING SUBMITTALS AND PROCEDURES.
- PLANTING SHALL OCCUR BETWEEN THE MONTHS OF APRIL AND OCTOBER. PLANTING DURING JULY AND AUGUST SHOULD BE AVOIDED IF POSSIBLE, AND WILL REQUIRE ADDITIONAL WARRANTY.
- ALL PLANTING AREAS SHALL RECEIVE A 2" THK TOP DRESSING OF DARK SHREDDED HEMLOCK BARK MULCH.

BID ALTERNATES

BID ALTERNATE WORK (THIS SHEET) INCLUDES THE FOLLOWING:

- PROVIDE AND INSTALL PLANTING, SOIL AMENDMENTS, MULCH, AND 90-DAY MAINTENANCE FOR AREA OUTSIDE OF STONE PLANTER WALL, BETWEEN SPLIT RAIL FENCE AND BACK OF EXISTING CONCRETE SIDEWALK.

PLANT MATERIAL LEGEND

TREES				
REFER TO DETAILS ON SHEET LP501 FOR TREE PLANTING AND STAKING.				
SYMBOL	SIZE	BOTANICAL NAME	COMMON NAME	REMARKS
+	-	EXISTING MAPLE TREE TO REMAIN		PROTECT-IN-PLACE
○	8'-10'	PINUS PONDEROSA	PONDEROSA PINE	-

SHRUBS & GRASSES				
REFER TO DETAILS ON SHEET LP501 FOR SHRUB PLANTING				
SYMBOL	SIZE	BOTANICAL NAME	COMMON NAME	REMARKS
⊙	1 GAL	ACHILLEA MILLEFOLIUM 'PAPRIKA'	PAPRIKA YARROW	
•	3 GAL	BOUTELOUA GRACILIS 'BLONDE AMBITION'	BLONDE AMBITION B. GRAMA GRASS	
*	3 GAL	CALAMAGROSTIS A. 'KARL FOERESTER'	FEATHER REED GRASS	
○	1 GAL	HEMEROCALIS 'HAPPY RETURNS'	HAPPY RETURNS DAYLILY	
⊙	1 GAL	NEPETA RACEMOSA 'WALKERS LOW'	WALKERS LOW CATMINT	
◇	5 GAL	CORNUS STOLONIFERA 'FARROW'	ARCTIC FIRE DOGWOOD	
+	5 GAL	PINUS MUGO 'PUMILIO'	PUMILIO MUGO PINE	
⊙	5 GAL	POTENTILLA FRUTICOSA 'PINK BEAUTY'	PINK BEAUTY POTENTILLA	

GROUND COVER				
REFER TO DETAILS ON SHEET LP501 FOR GROUND COVER PLANTING				
SYMBOL	DESCRIPTION		REMARKS	
▨	4" POTS	ARCTOSTAPHALUS UVA-URSI	KINNICKINICK	24" O.C.
▩	1 GAL	FESTUCA IDAHOENSIS	IDAHO FESCUE	12" O.C.

© SZABO Landscape Architecture. All rights reserved. Any use without permission is expressly prohibited. Plotted 3/29/2014 2:18 PM

project

La Pine Entry Monument
Sign & Flag Poles
La Pine, OR

date

2018.03.20

sla project number

1635

agency project number

sheet description

PLANTING PLAN

sheet number

LP101

project phase

ISSUE FOR BID

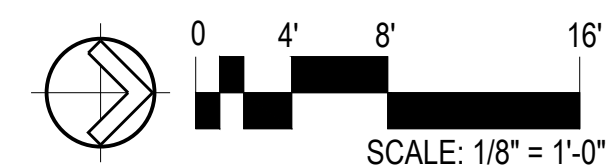

SZABO

LANDSCAPE ARCHITECTURE

1000 NW WALL ST., STE 250 | BEND, OR 97703
541.382.2059 | WWW.SZABO-LA.COM

landscape architect's seal

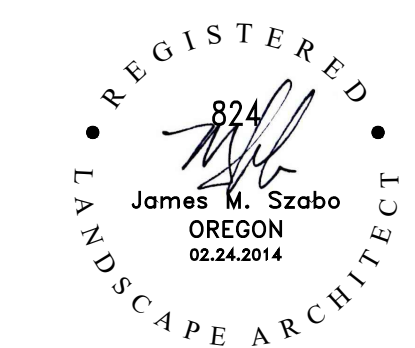

consultant

revision schedule

no.	date	description
-----	------	-------------

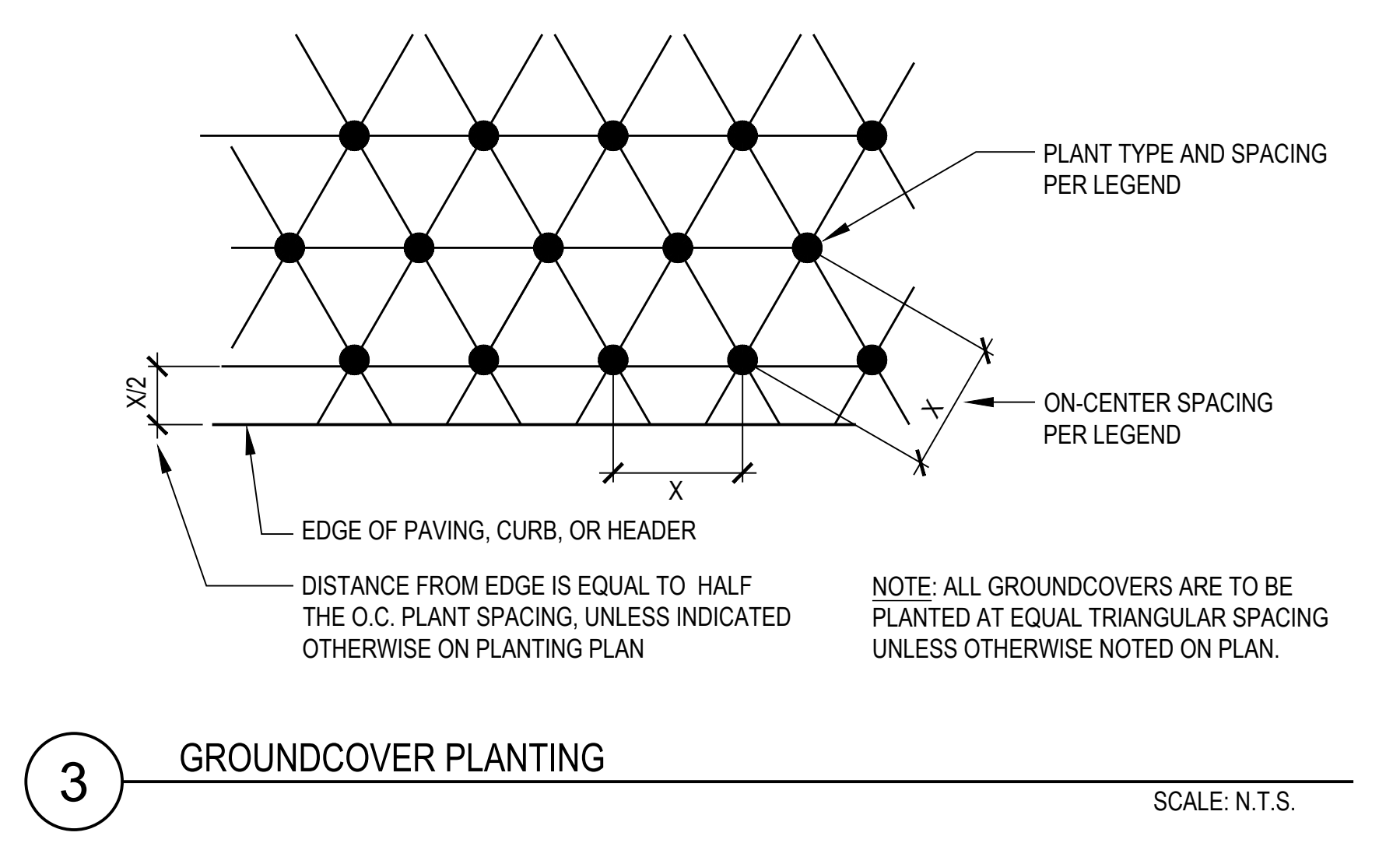
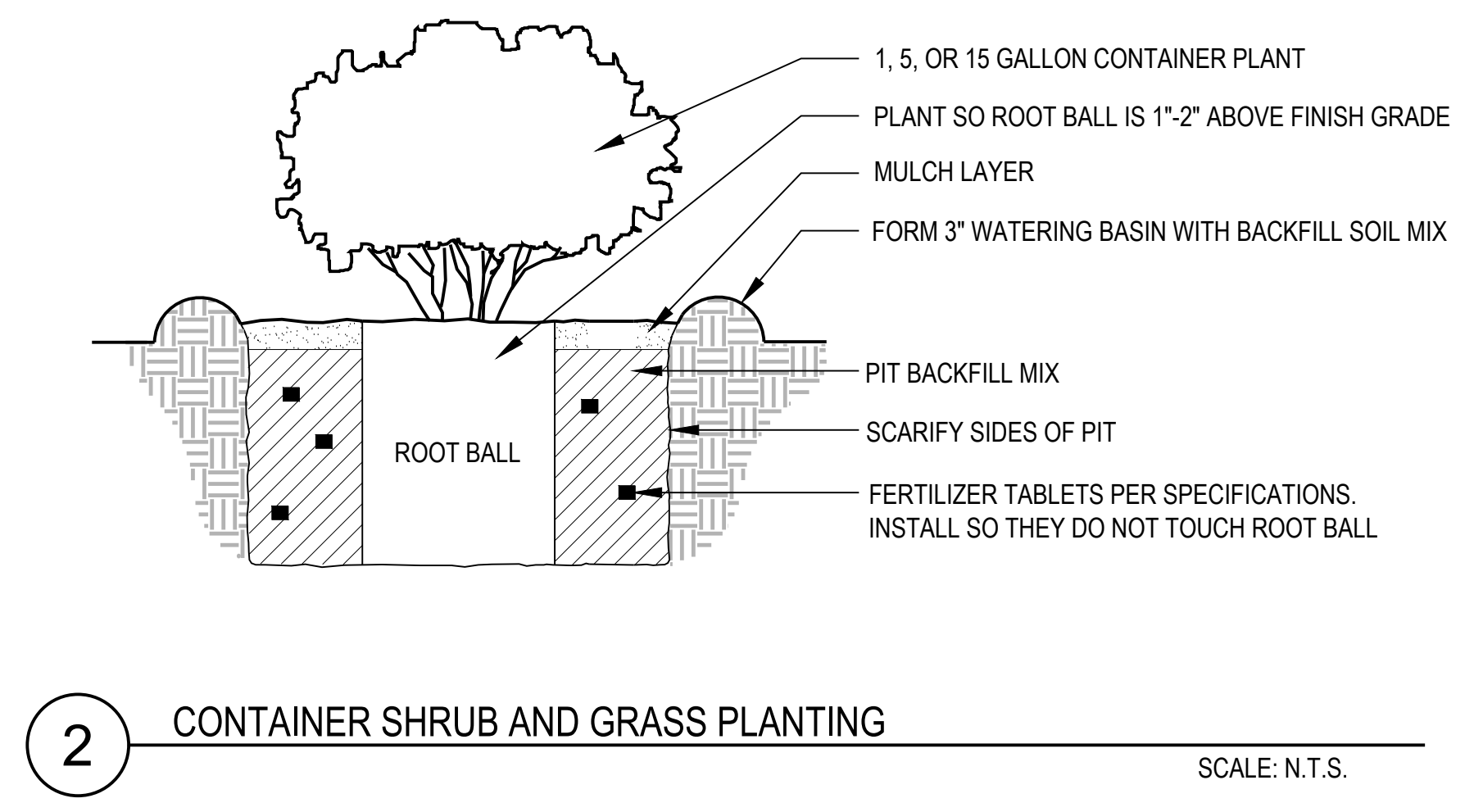
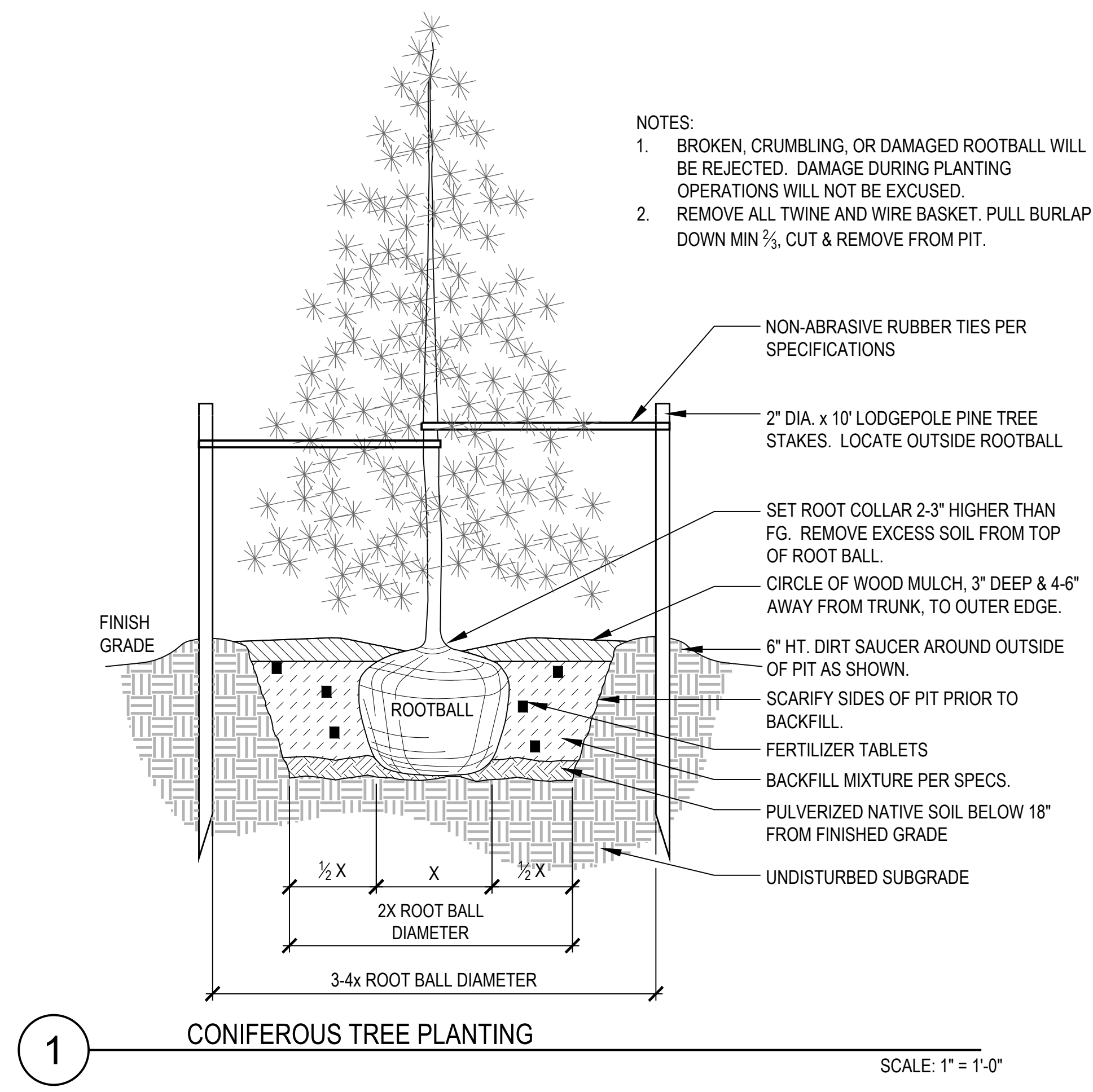

project	La Pine Entry Monument Sign & Flag Poles La Pine, OR
date	2018.03.20
sla project number	1635
agency project number	
sheet description	PLANTING DETAILS
sheet number	LP 501
project phase	ISSUE FOR BID